

T39S R8W

1049
501

OFFICE OF STATE ENGINEER
RECEIVED
NOV 2 1910

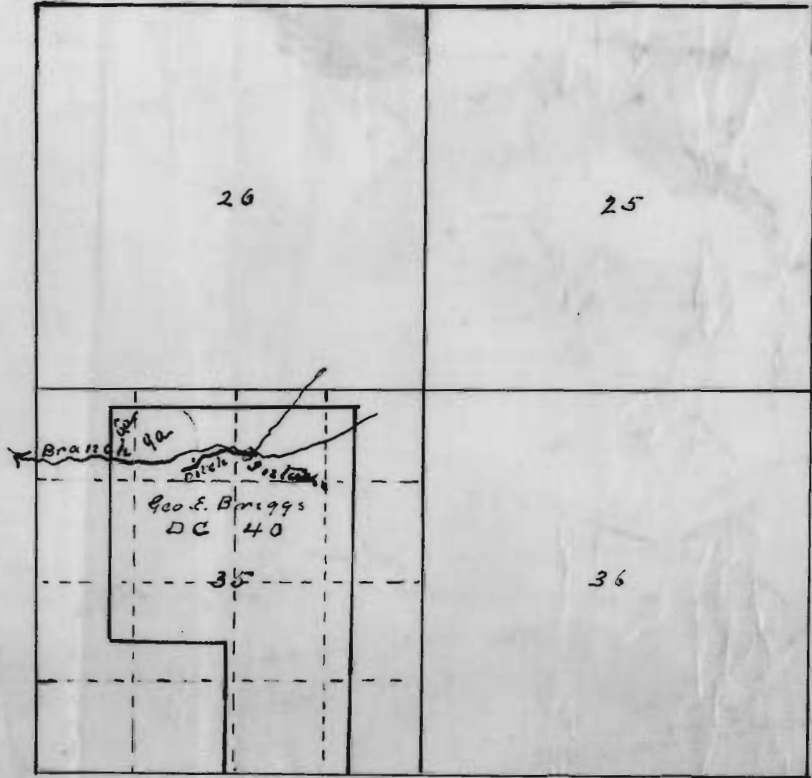

I C. J. Howard of Kerby Oregon do hereby certify that this map was made from notes taken during an actual survey made by me on the 23rd day of October 1910, and that it correctly represents the works described in the accompanying my application, together with the location of streams and other ditches in the immediate vicinity and has written thereon the area in each smallest subdivision which is proposed to irrigate

C. J. Howard
Surveyor

Application No. 1049
Permit No. 501