

Application No. 69153
 Permit No. 50110

T85 R25E or 1/400 E. W. 11.

RECEIVED

JUN 29 1987

WATER RESOURCES DEPT.
 SALEM, OREGON

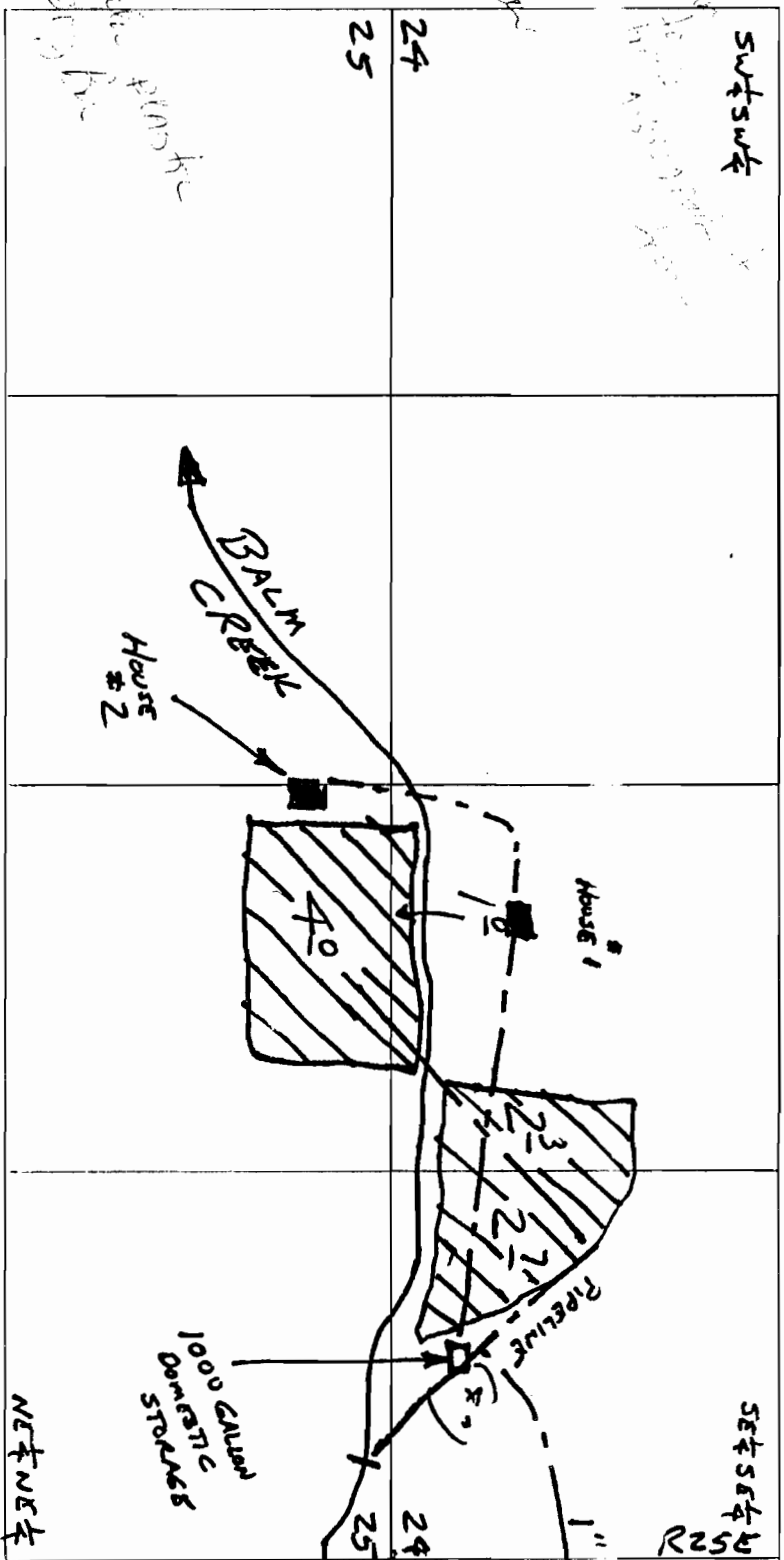

RECEIVED
 SEP 19 2002
 WATER RESOURCES DEPT.
 SALEM, OREGON

#1
 DIVERSION - 300' W. & 70' S. FROM
 SE CORNER OF SECTION 24
 #2 SPRING
 900' E & 700' N FROM SE
 CORNER OF SECTION 24

8" = 1 MILE

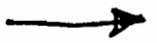

g. 1/400 E. W. 11.

g. 1/400 E. W. 11.
 g. 1/400 E. W. 11.
 g. 1/400 E. W. 11.

SE & SW 1/4
 R25N
 R26E
 SPRING