

— MAP —

Accompanying the application of George A. Giran of Medford, Jackson Co., Oregon, for permit to the water of Rogue River, Jackson Co., Oregon, through the Nichols' Ditch, for the purpose of irrigation.

— April 1921 —

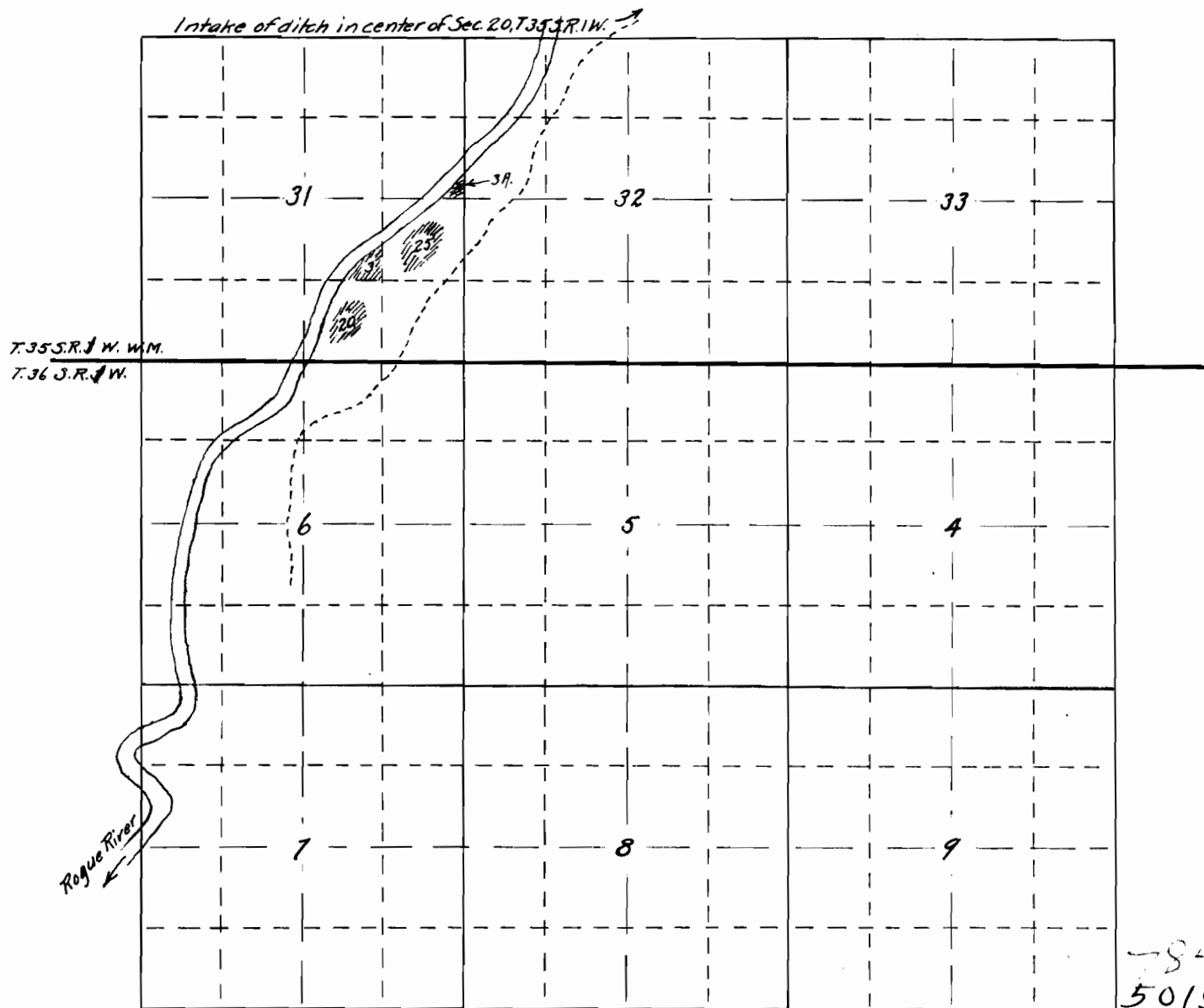

Map made from plat of George A. Giran Lands furnished by him, the same showing the lands to be irrigated, together with streams and ditches in the immediate vicinity, compiled by

— Fred N. Cummings —