

# T.5S.&6S., R.4W., W.M.

Pump located 550'S & 1200'W from center of Section 33.

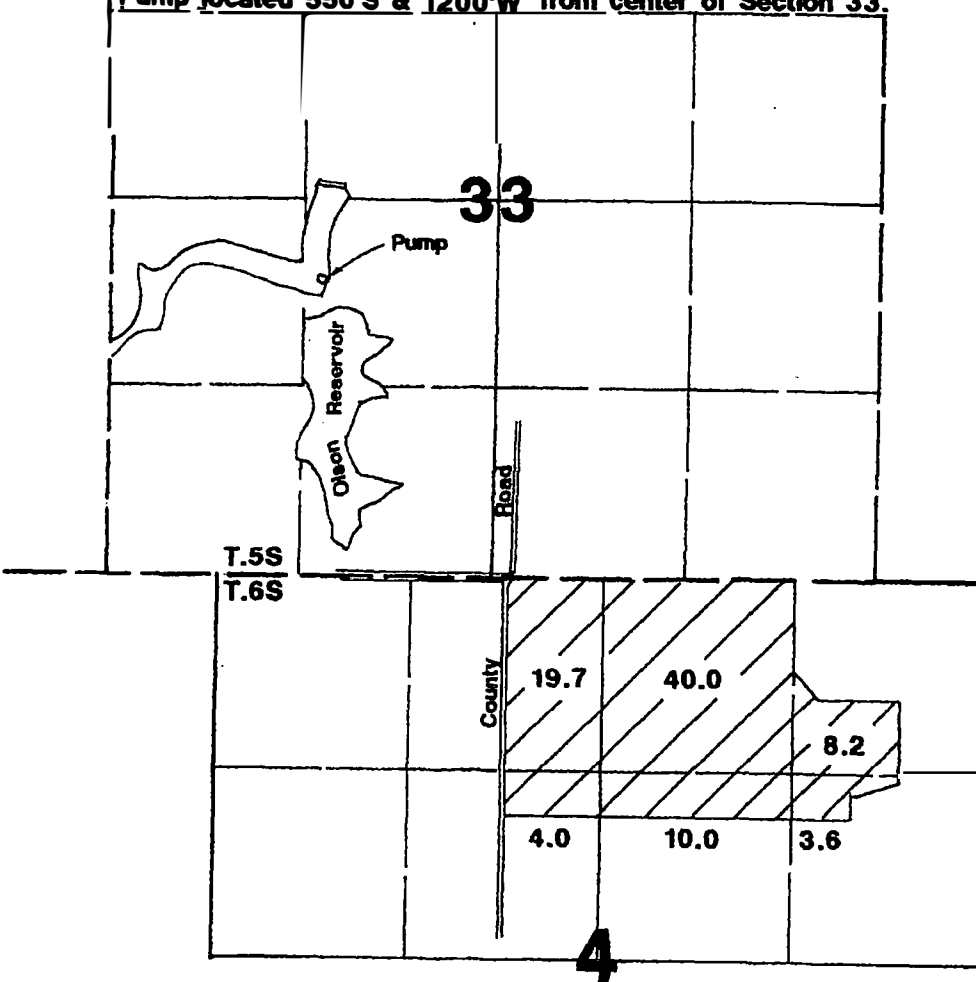

1" = 1320'

Area Irrigated

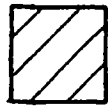

## RECEIVED

NOV 01 2016

WATER RESOURCES DEPT  
SALEM, OREGON

## Final Proof Survey

Application #: 69657      Permit #: 50668

In Name Of

# Aner Patty

Surveyed by J Grimm on August 24, 1993

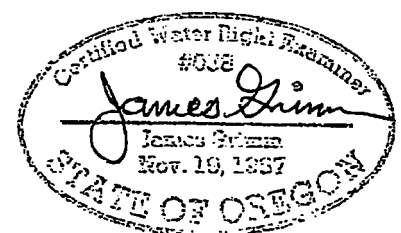

THIS MAP WAS PREPARED FOR THE PURPOSE OF IDENTIFYING THE LOCATION OF A WATER RIGHT ONLY AND IS NOT INTENDED TO PROVIDE LEGAL DIMENSIONS OR LOCATION OF PROPERTY OWNERSHIP LINES.

4-75

# T.5S.&6S., R.4W., W.M.

Pump located 550'S & 1200'W from center of Section 33.

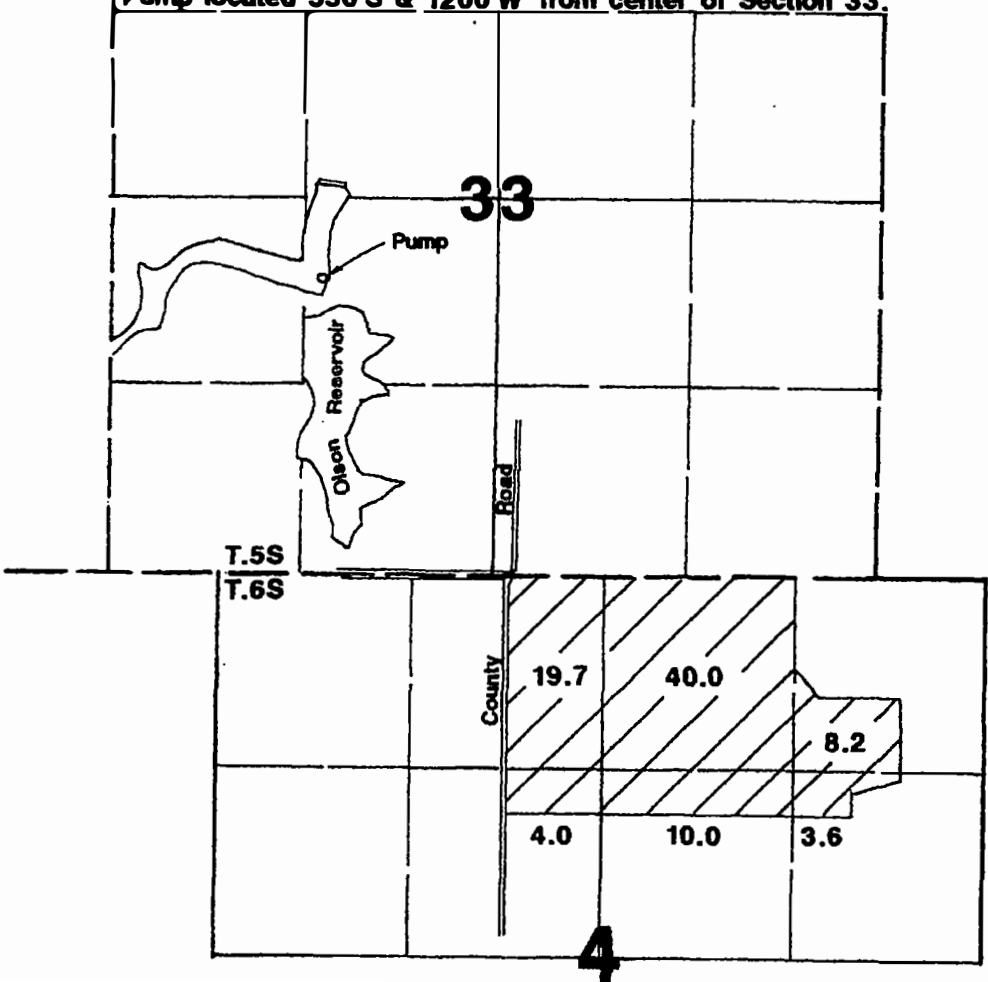

1" = 1320'

Area Irrigated

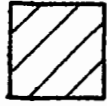

## RECEIVED

NOV 01 2016

WATER RESOURCES DEPT  
SALEM, OREGON

## Final Proof Survey

Application #: 69657      Permit #: 50668

In Name Of

# Aner Patty

Surveyed by J Grimm on August 24, 1993

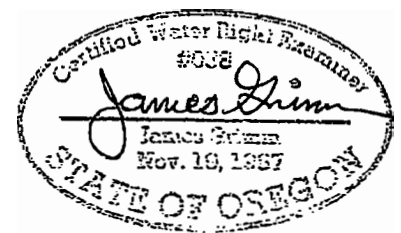

THIS MAP WAS PREPARED FOR THE PURPOSE OF IDENTIFYING THE LOCATION OF A WATER RIGHT ONLY AND IS NOT INTENDED TO PROVIDE LEGAL DIMENSIONS OR LOCATION OF PROPERTY OWNERSHIP LINES.