

T. 29, S., R. 14 W., W.M.

7 8

N 18 17

IR.

N 1

4



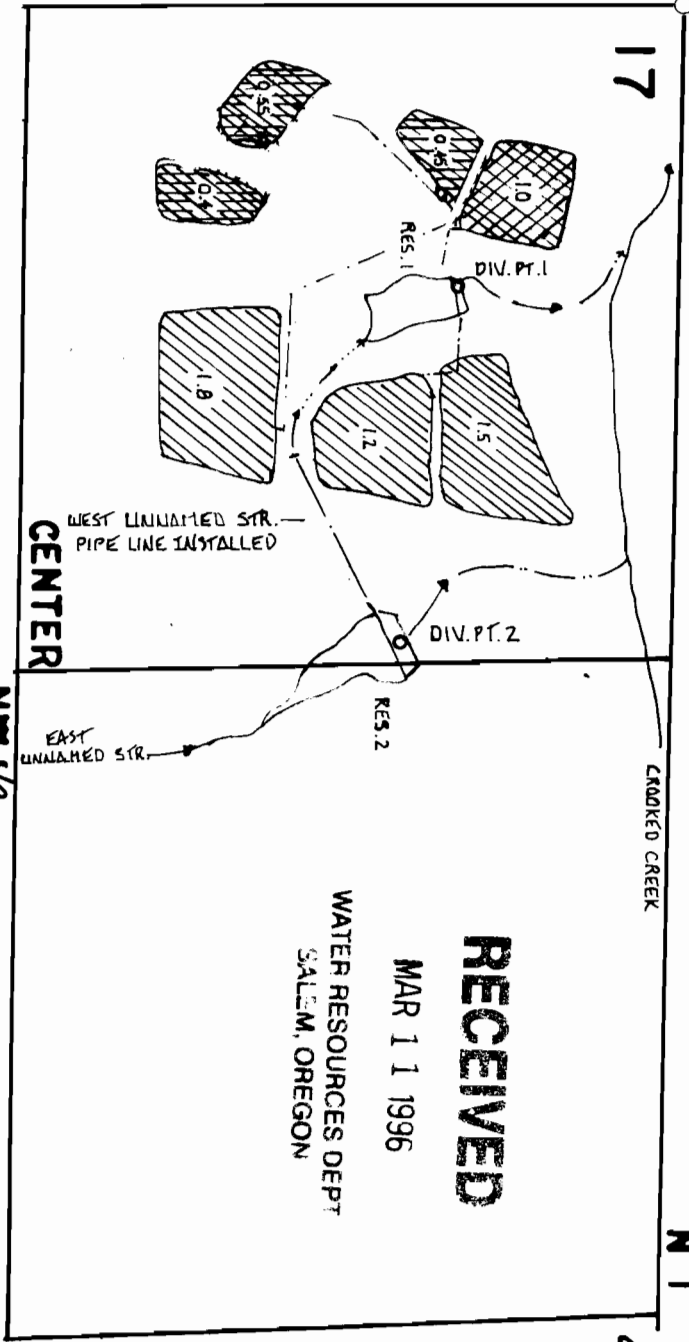

1" = 400'



LEGEND

 New place of use per Transfer No. T-6079

 Continued place of use cert. No. 31372

 Place of use per permit No. 50716

NOTE: ALL BOGS, RESEVOIRS AND DIVERSION POINTS ARE BUILT

FINAL PROOF SURVEY UNDER

Div. Pt. Res. 1 S. 430 & E. 600-NW cor S. 17 Div. Pt. Res. 2 S. 550 & E. 1285-Nw cor. S. 17

Application Number R-69546 & 69547

Permit Number R-11150 & 50716

Transfer Number T-6079

ROBERT L. & HELEN M. ATEN

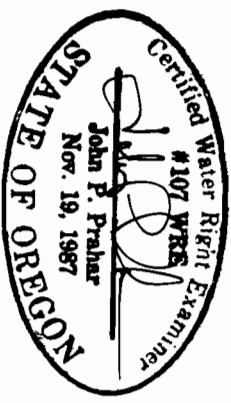

This map is for the purpose of identifying the location of the water right only and is not intended to provide legal dimensions or location of property ownership lines.