

# SECTION 32, T.3S, R.1E, W. M.

COPY

DEC - 6 1993

WATER RESOURCES DEPT.  
SALEM, OREGON



SCALE - 1" = 400'

SECTION 31  
SECTION 32

**MUECKE ROAD**

3,240'

WEST 1/4  
CORNER

APPLICATION FOR TRANSFER OF WATER RIGHT  
PERMIT NO. S-50733, CERTIFICATE NO. 66176

FROM  AREA OF PERMIT NO. 50733. TO BE TRANSFERRED.

TO  PROPOSED NEW AREA.

Page 4

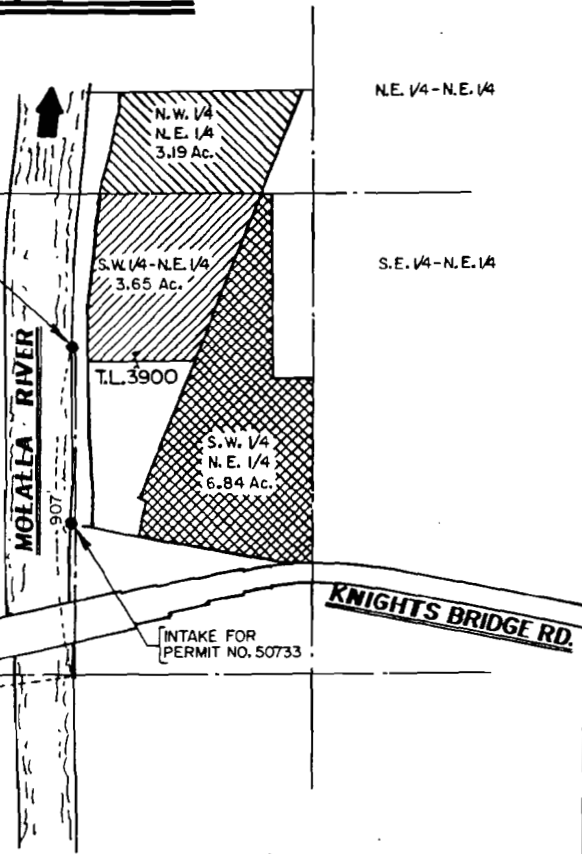



**ZAROSINSKI - TATONE  
ENGINEERS, INC.**

3737 S. E. 8TH AVENUE, PORTLAND, OREGON 97202

PHONE: (503) 235-8795