

50749

RECEIVED

JUN 9 - 1987

WATER RESOURCES DEPT.
SALEM, OREGON

RECEIVED

SEP 11 1987

WATER RESOURCES DEPT.
SALEM, OREGON

TOWNSHIP 30 S, RANGE 32 E, W.M.

34
SE 1/4 SE 1/4

Krumbo ch

North

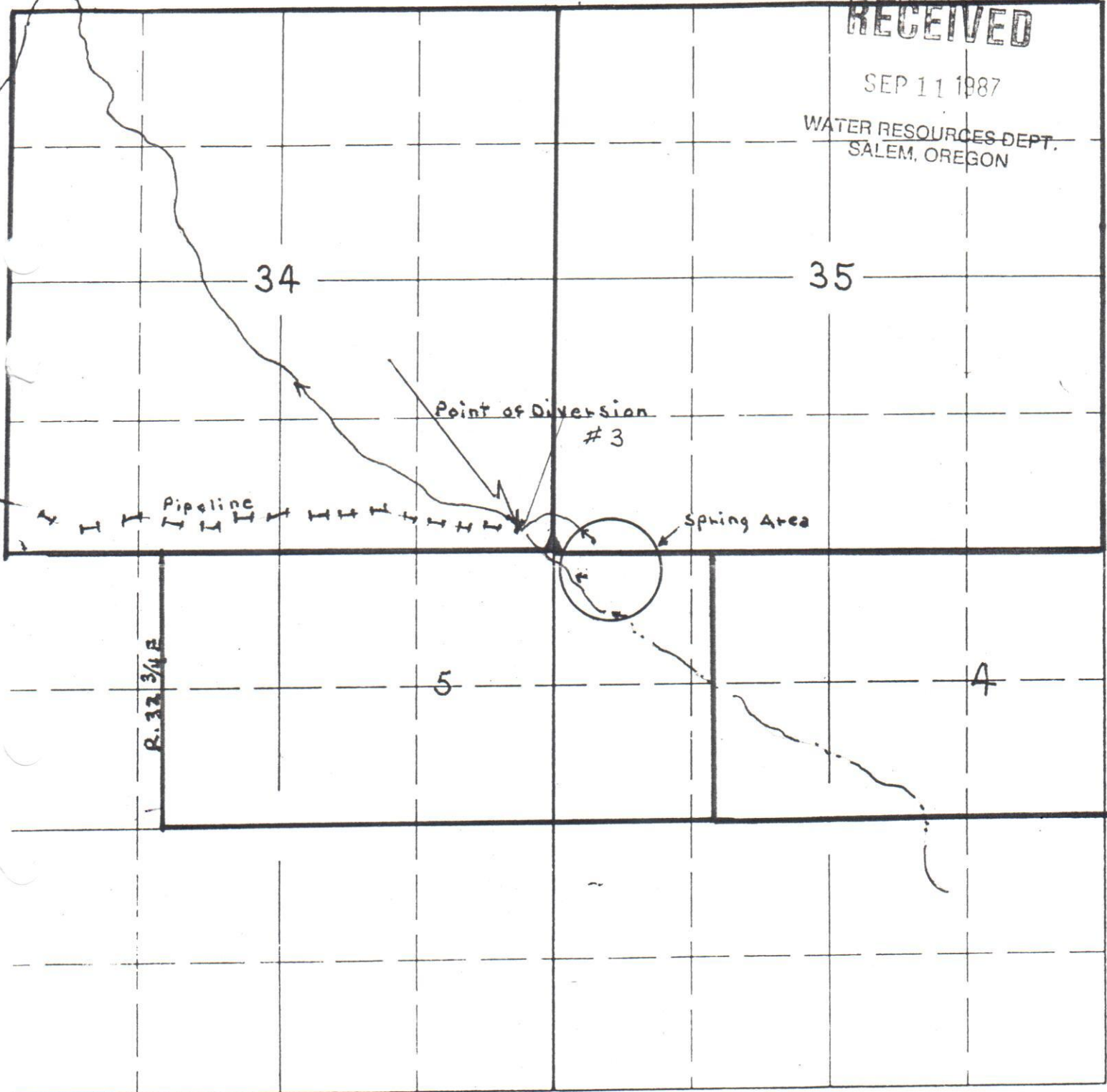

East

South

From USGS Quad
Krumbo Springs
Krumbo Ridge
Scale 7.5 minute
2.65 inches = 1 mile

LOCATION: 200 ft N and 300 ft W of the
SE corner of Sec. 34, T. 30 S.,
R. 32 E., W.M.

APPLICATION No. 69063
PERMIT No. 50749

SECTION

5

Lots #

2, 5, 7

Harney County

TOWNSHIP

31S

RANGE

32 3/4 E

W.M.

North

50749
RECEIVED

JUN 9 - 1987

WATER RESOURCES DEPT.
SALEM, OREGON

RECEIVED

SEP 1 1987

WATER RESOURCES DEPT.
SALEM, OREGON

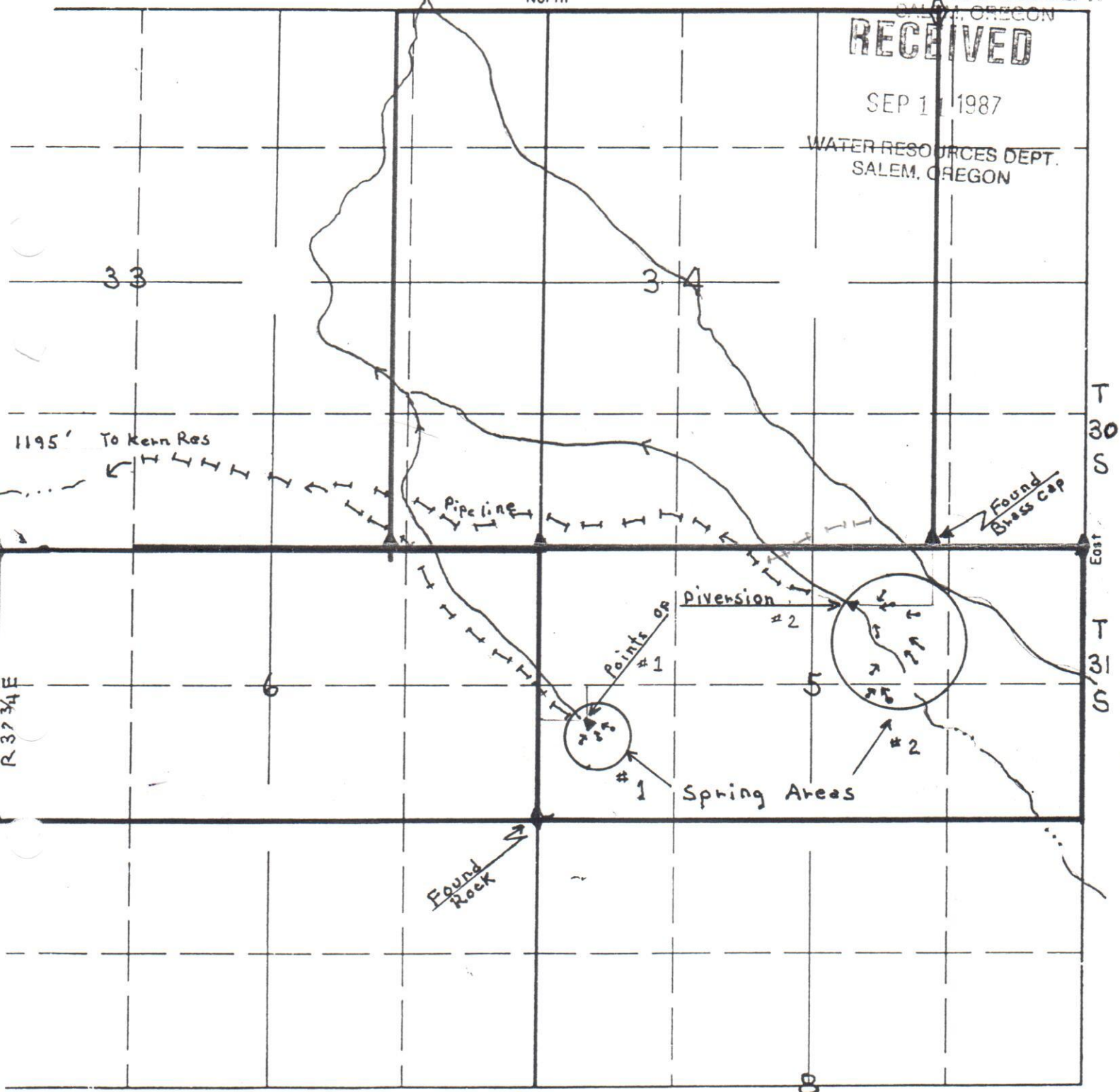

From USGS Quad
Krumbo Spn - Krumbo Ridge
Scale 7:5 minute
2.65 inches = 1 mile

LOCATION: Points of Diversion
1 996' N and 598' E from the
SW Cor. of Sec. 5, T. 31 S., R. 32 3/4 E
(1195)
2 540' S and 1195' W from the SE
Cor of Sec. 34, T. 30 S., R. 32 E.

APPLICATION NO.

69063

PERMIT NO.

50749