

# 50759

# T. 37., R. 5 W., W.M. SECTION 20 NW 1/4, NW 1/4

### DIVERSION POINTS:

APPLEGATE LAKE RESERVOIR LOCATED IN  
S 1/2, SE 1/4, SEC. 25, T 40 S, R 4 W, W.M.

### ALTERNATE DIVERSION POINTS FOR MURPHY ELECTRIC DITCH

SE 1/4, NW 1/4, SEC. 21, T 37 S, R 5 W, W.M.  
1550' SOUTH & 2200' EAST FROM NW COR.,  
SEC. 21 ( JOSEPHINE COUNTY ).

SW 1/4, SW 1/4, SEC. 6, T 38 S, R 4 W, W.M.  
950' NORTH & 200' EAST FROM SW COR.,  
SEC. 6 ( JACKSON COUNTY ).

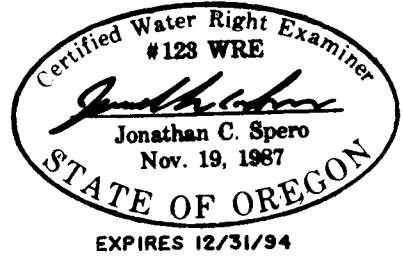

THIS MAP IS FOR THE PURPOSE OF  
IDENTIFYING THE LOCATION OF THE  
WATER RIGHT ONLY AND IS NOT IN-  
TENDED TO PROVIDE LEGAL DIMEN-  
SIONS OR LOCATIONS OF PROPERTY  
OWNERSHIP LINES.

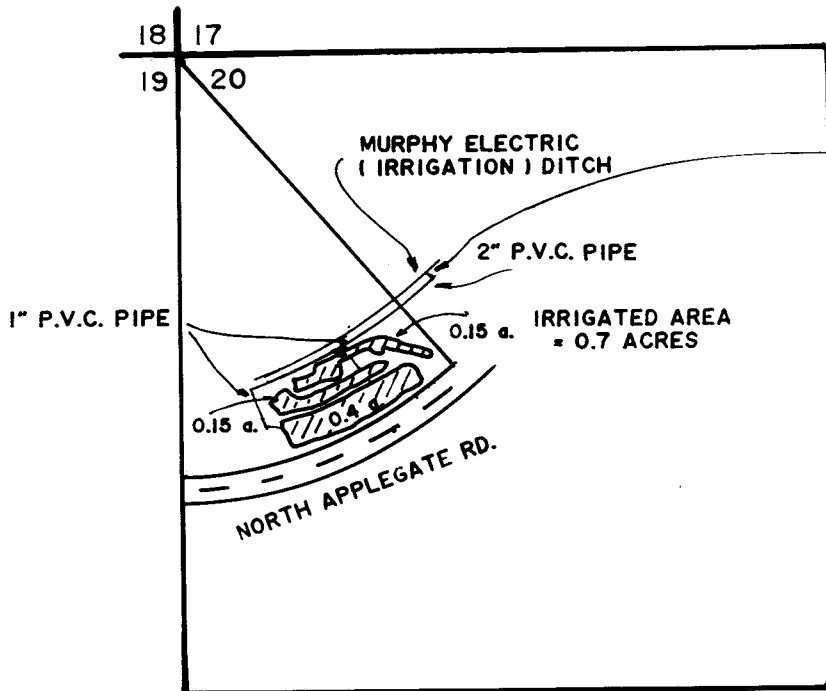

DIVERSION FROM  
MURPHY ELECTRIC  
DITCH IS LOCATED  
450' SOUTH & 500'  
EAST FROM NW  
COR SEC. 20



SCALE: 1" = 400'

## FINAL PROOF SURVEY UNDER

APPLICATION NO. 69764 PERMIT NO. 50759  
IN NAME OF

**ROBERT ZIMMERMAN**

SURVEYED JANUARY 14, 1993 BY Jonathan C. Spero