

— MAP —

Accompanying application of W^m HEAD of Applegate
Jackson County, Oregon. for permit to the waters of
Applegate River tributary to Rogue River. Jackson
County Oregon.

October 1919.

Tp 38 S. R. 4 W. W. M.

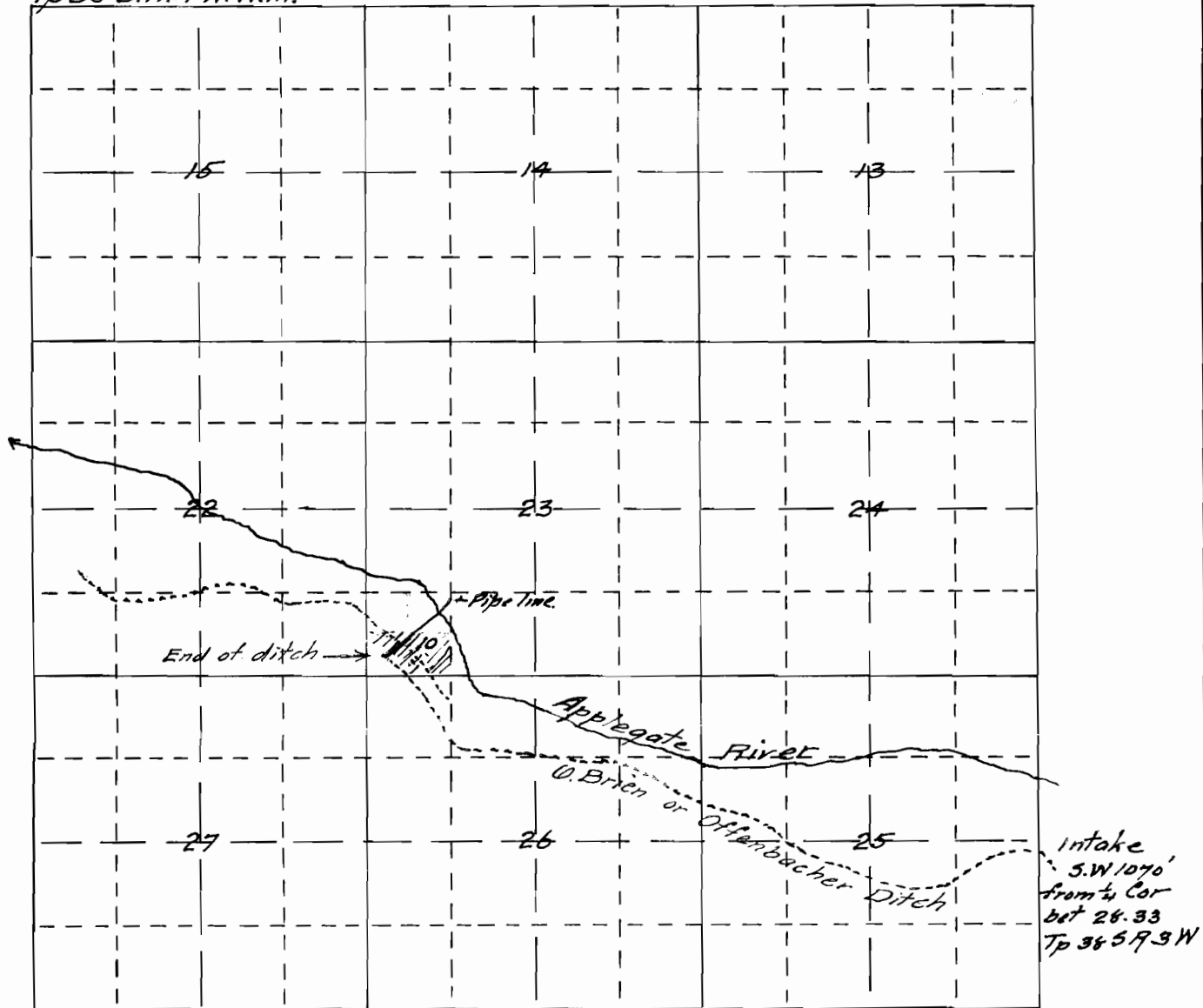

Plat made from plat furnished by Mr Head correctly
showing lands to be irrigated together with streams
and ditches in immediate vicinity. compiled by.

Fred. N. Cummings. C. E.

7917
5086