

T.31 S. R.4 W.

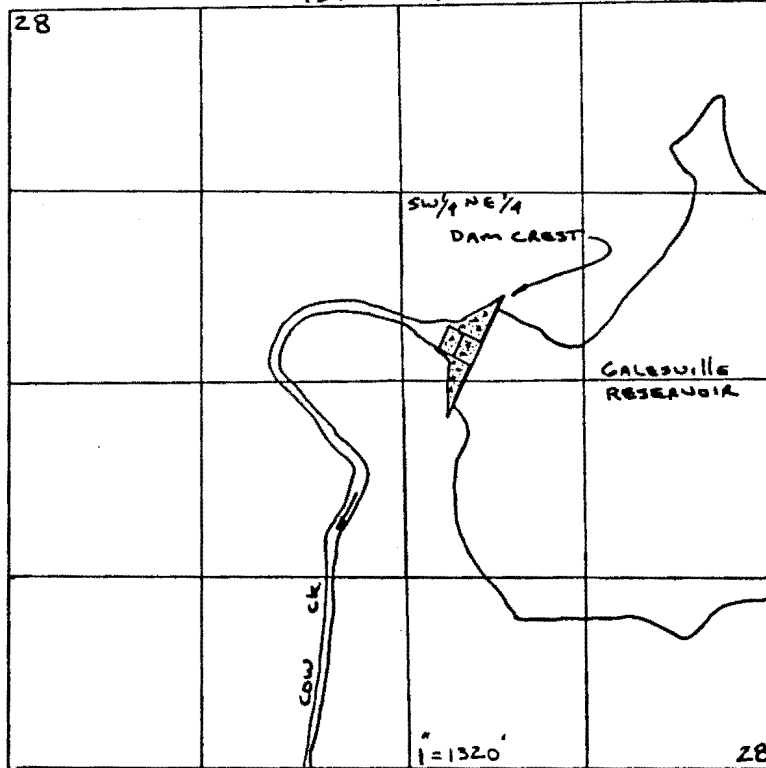

**RECEIVED**  
 JUN 29 1987  
 WATER RESOURCES DEPT.  
 SALEM, OREGON

DAM (POD) = 2920' N. ; 2060' W. FROM SE COR. S. 28

**Application No. 69164**  
**Permit No. 50867**

T.30 S. R.6 W.

T.30 S. R.5 W.

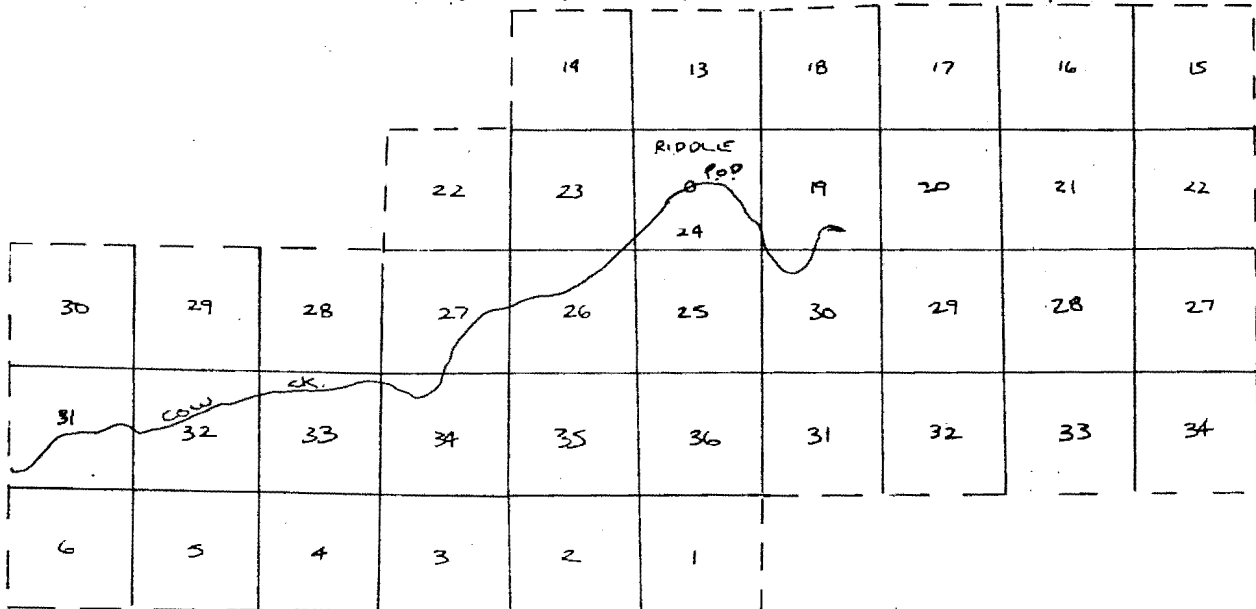

--- = DISTRICT BOUNDARY  
 POD = 2140' S. & 2240' E. FROM NW. COR. S. 24  
 FOR GREATER DETAIL SEE P# 35103 & ACCOMP. MAP.

167