

RECEIVED

NOV 30 1989

WATER RESOURCES DEPT
SALEM, OREGON

APPLICATION MAP

IN THE NAME OF JAMES W. DASKALOS
SECTIONS 22 AND 23, T26S, R6W, W.M.

Application No. 70134
Permit No. 50954

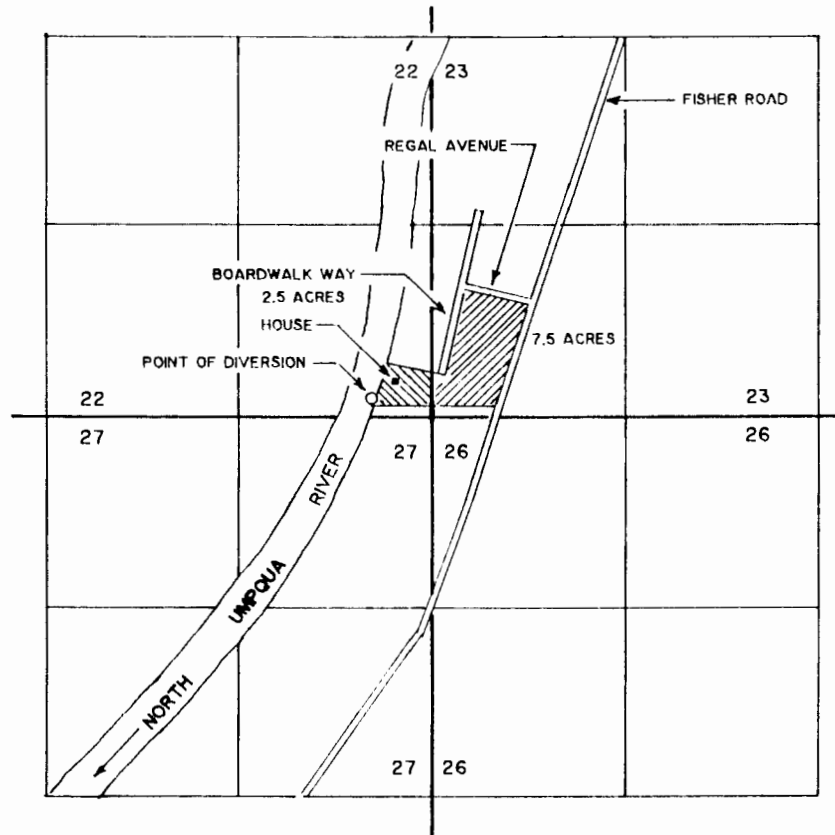
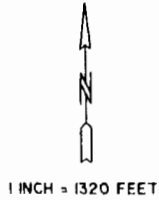

THE POINT OF DIVERSION IS TO BE LOCATED 110 FEET NORTH AND 420 FEET WEST FROM THE SOUTHEAST CORNER OF SECTION 22, BEING WITHIN THE SE 1/4 OF THE SE 1/4 OF SECTION 22, TOWNSHIP 26 SOUTH, RANGE 6 WEST, W.M.

THE PURPOSE OF THIS MAP IS TO IDENTIFY THE LOCATION OF THE WATER RIGHT. IT IS NOT INTENDED TO PROVIDE INFORMATION RELATIVE TO THE LOCATION OF PROPERTY OWNERSHIP BOUNDARY LINES.

