

RECEIVED

Application No. R-69553 & 69266

FEB 29 1988

Permit No. R11219

50902

WATER RESOURCES DEPT.  
SALEM, OREGON

T.6N. R.35E.W.M.

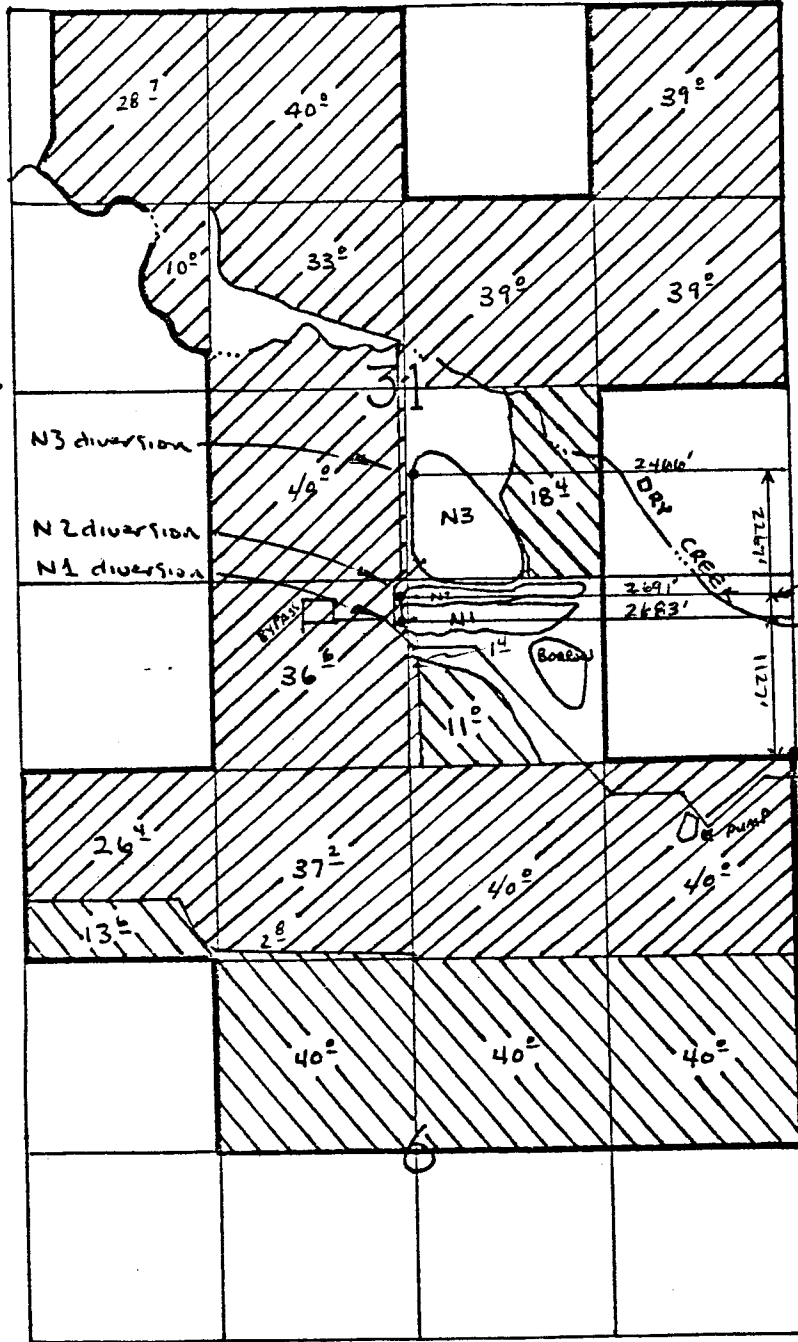

1284'  
SE. corner of  
Section 31  
OUT FALL FROM  
SEWER TREATMENT PLANT

T.5N. R.35 E.W.M.

RECEIVED

FEB 1 1988

WATER RESOURCES DEPT.  
SALEM, OREGON



Supplemental

450.3



Primary

165.8