

NEKOMA

Map to accompany application for permit to appropriate the waters of an unnamed creek in the SE ¼ of Section 34-T17S-R9W by the Southern Pacific Company

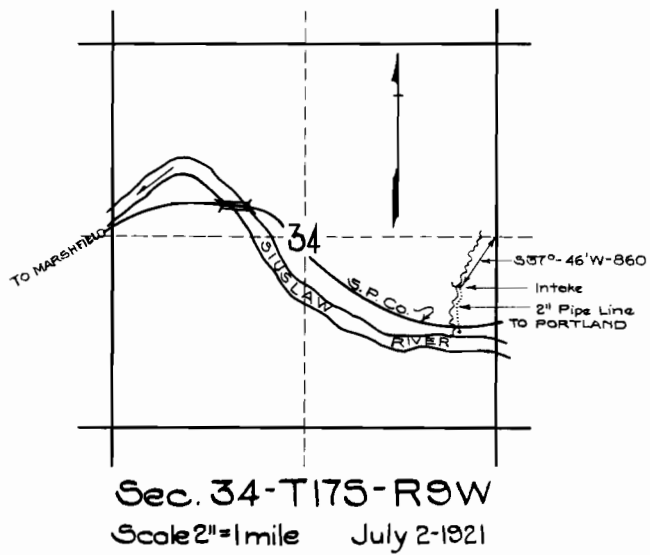

OFFICE OF STATE ENGINEER
RECEIVED
JUL 14 1921
SALEM - OREGON

Approved
5141

SURVEYOR'S CERTIFICATE

I, E.E. Mayo, of Portland, Oregon, do hereby certify that this map was made from notes taken during an actual survey made under my immediate supervision on June 8, 1921 and that it correctly represents the work described in the accompanying application together with the location of streams and ditches in the immediate vicinity.

E. Mayo
SURVEYOR
Registered Professional Engineer
State of Oregon
No 432
Nov. 8, 1919.