

Application No. 71579  
Permit No. 51470

T. 6 S. R. 4 W. W.M.

POLK COUNTY

PT. DIV. 305'N & 2700'W  
OF SE CORNER SEC 7, T6S  
R4W WM

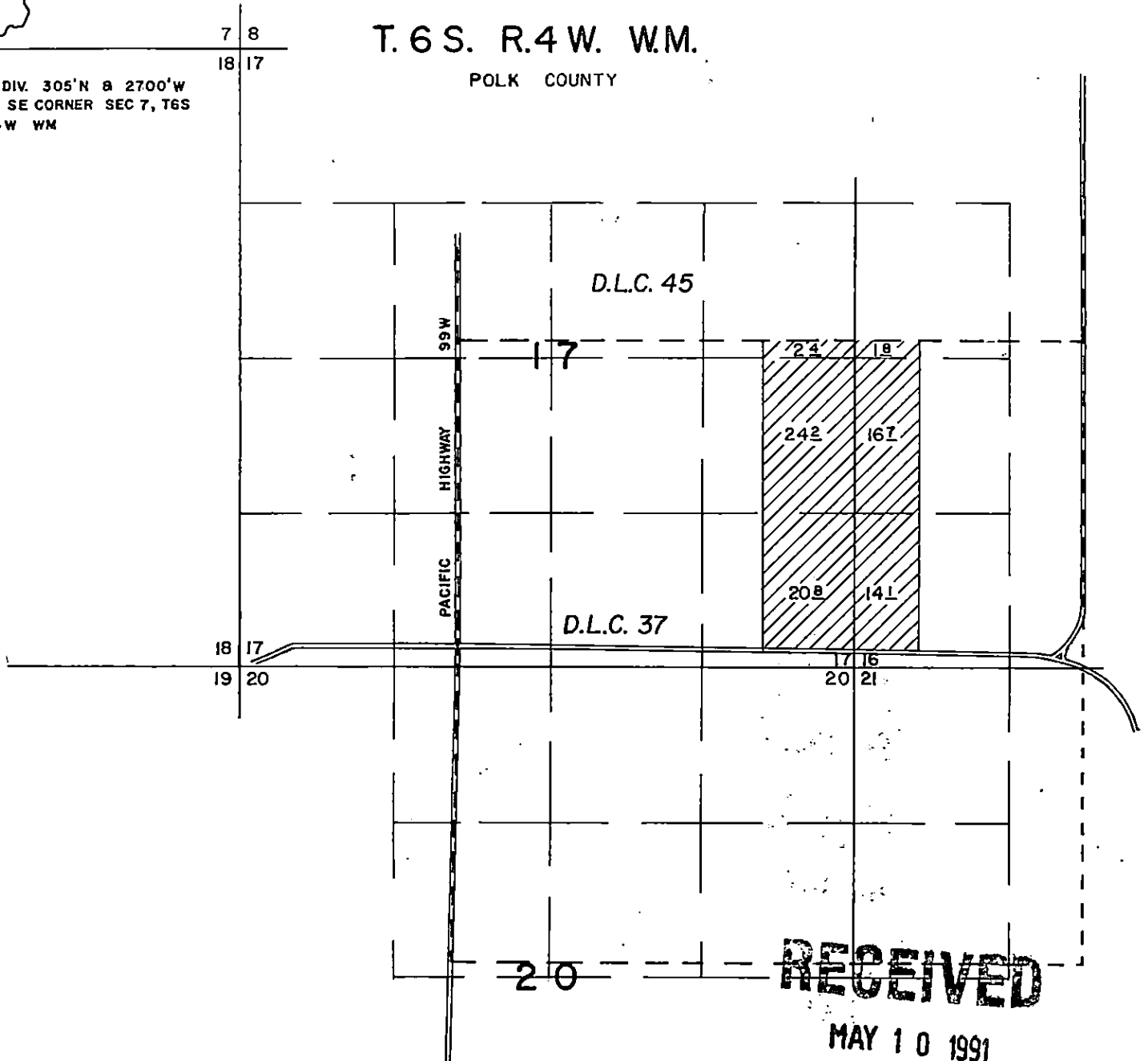

RECEIVED

MAY 10 1991

WATER RESOURCES DEPT  
SALEM, OREGON

R - 54226  
63809  
R - 67984  
67985

R - 6487  
46958  
R - 10482  
49361

Application No 71579 Permit No 51470

MARVIN DE RAEVE

MAY 6, 1991  
SCALE 1" = 1320'

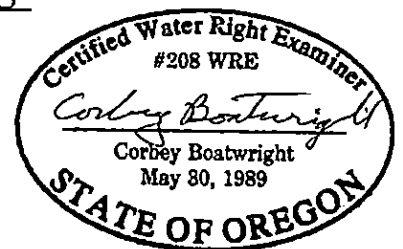

APPLICATION TO APPROPRIATE SURFACE WATER