

MAP

Accompanying application of Mrs. M. E. MIDDLEBUSH,
of Trail, Jackson County, Oregon. for permit to the waters
of Trail Creek tributary to Rogue River, Jackson Co.
Oregon, for the purpose of irrigation.

July 1921.

Tp 34, S. R. 1 W. W. M.

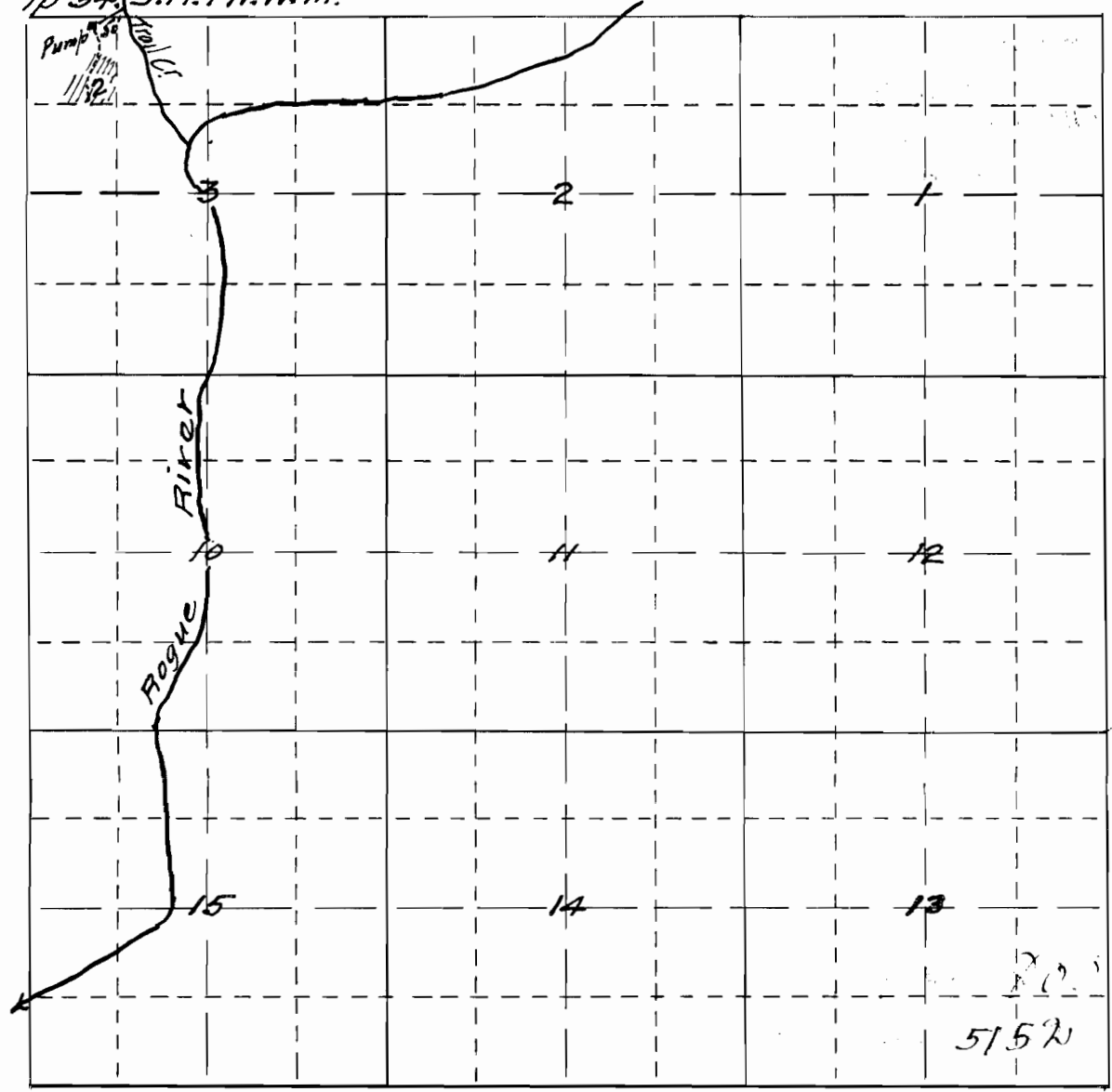

Map made from examination of the ground & notes
in the field by myself. the same correctly showing
the lands to be irrigated, streams and ditches in
the immediate vicinity.

Fred. N. Cummings. C. E.