

AMENDED MAP

No. 72453

No. 51546 51559 RECEIVED

PERMIT 51546 WITHDRAWN BY SPECIAL ORDER UO48, Pg 238
SUPPLEMENTAL WATER APPLICATION DRAWING JUL 29 1992 334

WATER RESOURCES DEPT.
SALEM, OREGON

A DRAWING PREPARED FOR SUBMITTAL WITH AN APPLICATION BY ~~DAVID STEVENS~~ AND
ALBERT GRESHAM FOR A PERMIT TO USE WATER FROM SPRING #2 IN THE NW 1/4
OF THE SE 1/4 OF SECTION 3, T4P4S, R8W, W.M., TILLAMOOK COUNTY, OREGON. SPRING #2
IS N. 79°38'E, 363 FEET FROM THE CS 1/6 CORNER OF SAID SECTION 3.

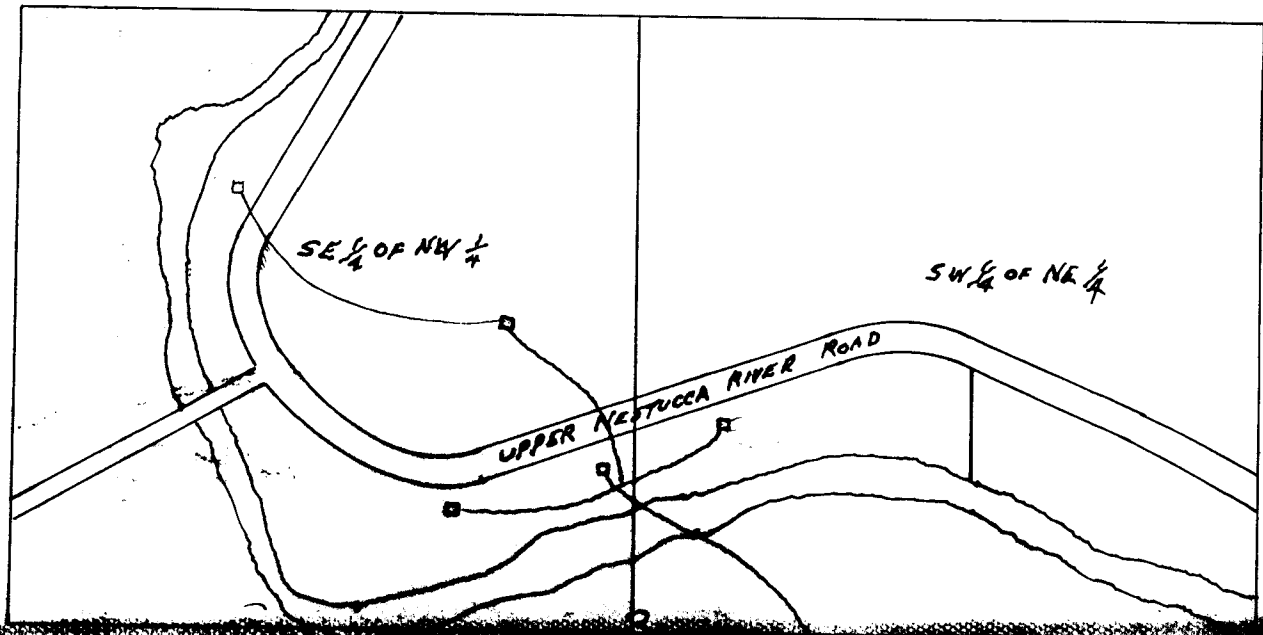
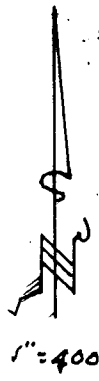

NOTES:

1. SPRING #2 HAS ABOUT 5 TIMES THE FLOW OF SPRING #1. SPRING #2 IS PRESENTLY NOT CONNECTED TO THE 1000 GALLON STORAGE RESERVOIR ALTHOUGH P.E. PIPE RUNS FROM SPRING #2 TO THE RESERVOIR.
2. THERE IS SUFFICIENT FLOW TO SERVE ALL DOMESTIC USES.



F3 ALUM
3" CAP
MKD.
CS 1/6
SEC. 3
T4S, R8W

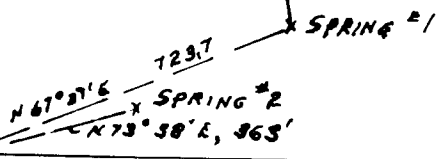

L.E. FULTZ
12 JUL 1992