

RECEIVED

FEB - 4 1994

WATER RESOURCES DEPT.
SALEM, OREGON

APPLICATION MAP IN THE NAME OF JOYCE FRIEDRICHSEN

T.26S., R.4W., W.M.

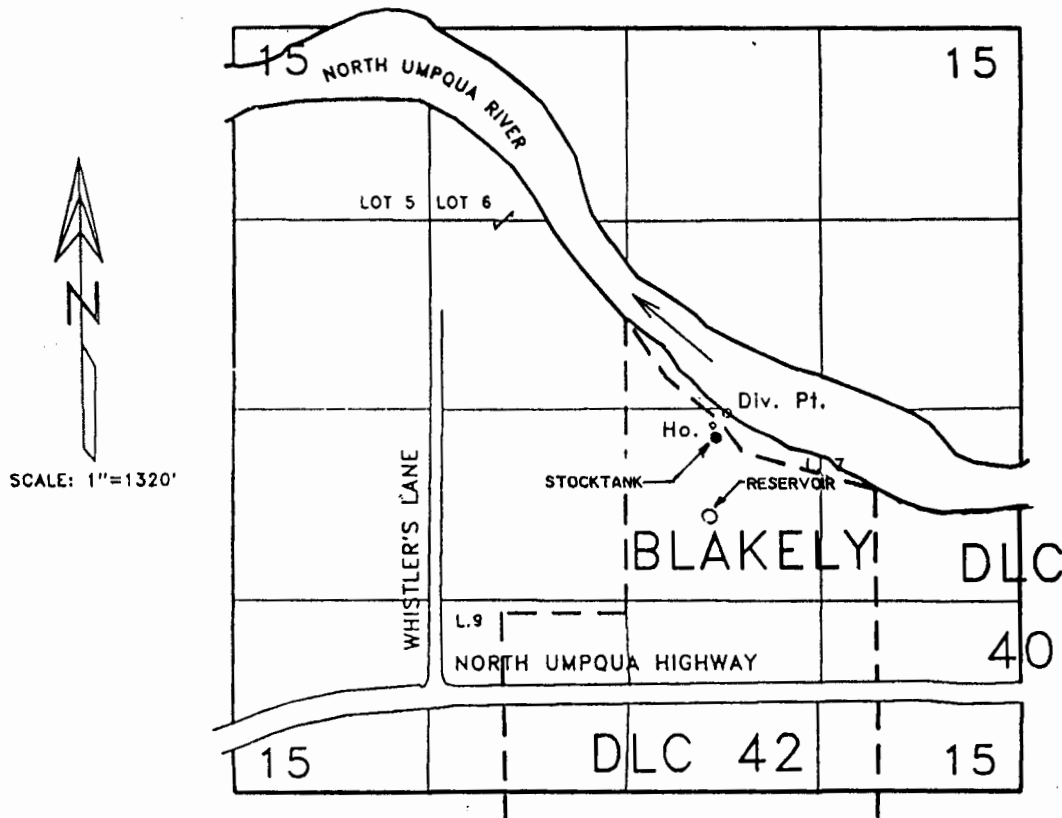

Div. Pt. is located 2600' N. & 1900' W. from SE corner of Section 15.

THE PURPOSE OF THIS MAP IS TO IDENTIFY
THE LOCATION OF THE WATER RIGHT. IT IS
NOT INTENDED TO PROVIDE INFORMATION
RELATIVE TO THE LOCATION OF PROPERTY
OWNERSHIP BOUNDARY LINES.

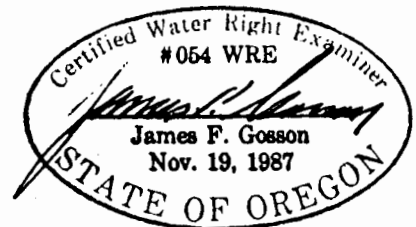

Application No. 72116
Permit No. 51656

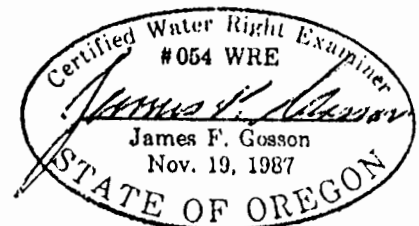

TL#400