

Application No K-72995 CWRE MAP

Permit No.

T.4S. R.4E5W.W.M.

RECEIVED

RECEIVED

FEB - 7 1996

DEC 21 1990

WATER RESOURCES DEPT SALEM, OREGON

WATER RESOURCES DEPT SALEM, OREGON

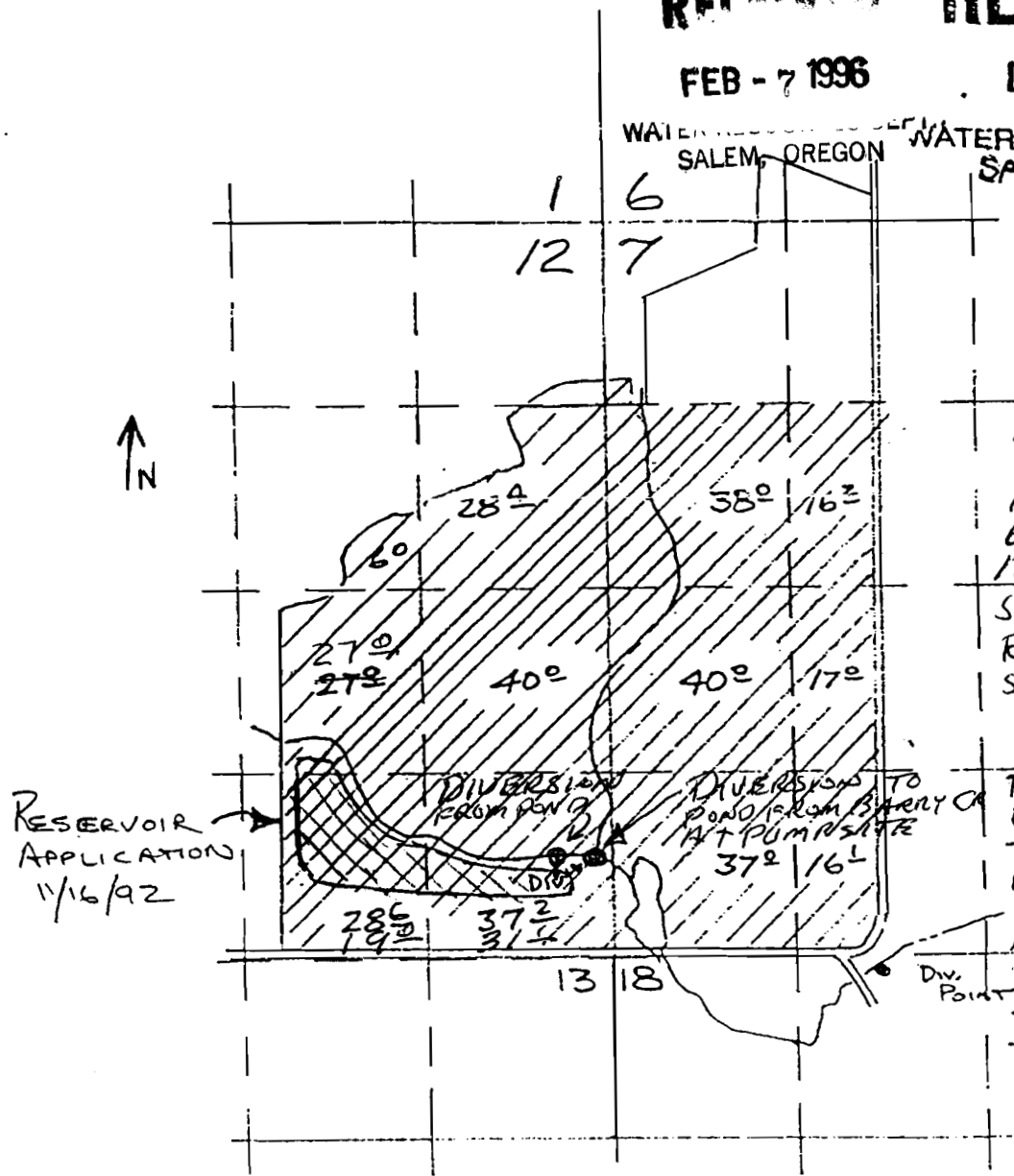

POINT OF DIVERSION
FROM BARRY CREEK AT
660 ft NORTH &
130 ft WEST OF THE
SE COR SECTION 13, T4 S,
R5W W.M., IN SE 1/4
SE 1/4 SEC 13 T4S R5W W.M.

Point of Diversion from
Pond to pump site is
730 ft North & 770 ft
west of the SE COR
SEC 13, T4S, R5W W.M.
IN SE 1/4 SE 1/4 SEC 13,
T4S R5W W.M.

SUPPLEMENTAL
TO # 22184

CERT # 22184

Revisions provided by
Leonard *[Signature]* PE#5174

APPLICATION MAP 2/5/96

APPLICATION 71064

FRANK SETNIKER

DEC 18 1990 Nov 16 92 JG

SCALE: 1 IN: 1320 FT

NOTE: MAP IS FOR
PURPOSE OF IDENT-
IFYING LOCATION OF
WATER RIGHT AND HAS
NO INTENT TO DIMEN-
SION OR LOCATE PROPERTY
OWNERSHIP LINES.

