

Application No. 72915
Permit No. 51915

APPLICATION MAP
IN THE NAME OF
LOYD I. or DELORES J. SMITH

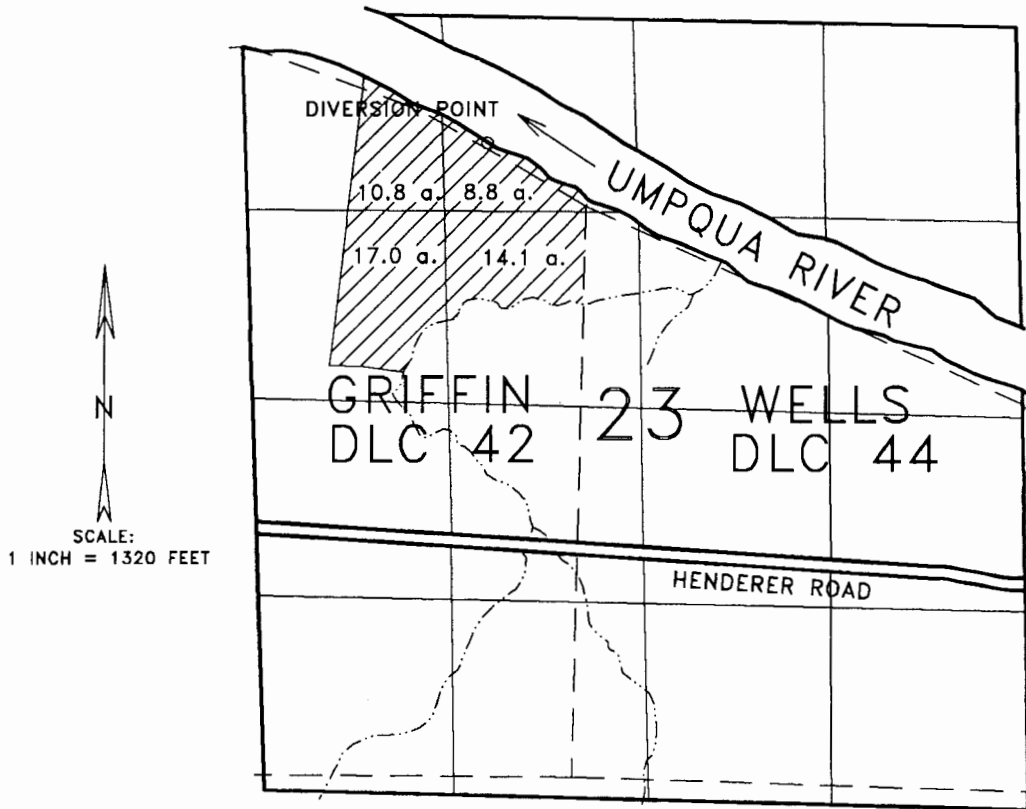

TOWNSHIP 22 SOUTH, RANGE 8 WEST, W.M.



THE DIVERSION POINT IS LOCATED 4440 FEET NORTH AND 1525 FEET EAST FROM THE SOUTHWEST CORNER OF SECTION 23.

THE PURPOSE OF THIS MAP IS TO IDENTIFY THE LOCATION OF THE WATER RIGHT. IT IS NOT INTENDED TO PROVIDE INFORMATION RELATIVE TO THE LOCATION OF PROPERTY OWNERSHIP BOUNDARY LINES.

