

T.4S., R.1W. & 2W., W.M.

AMENDED

RECEIVED

OCT 07 1993 1320'

WATER RESOURCES DEPT
SALEM, OREGON

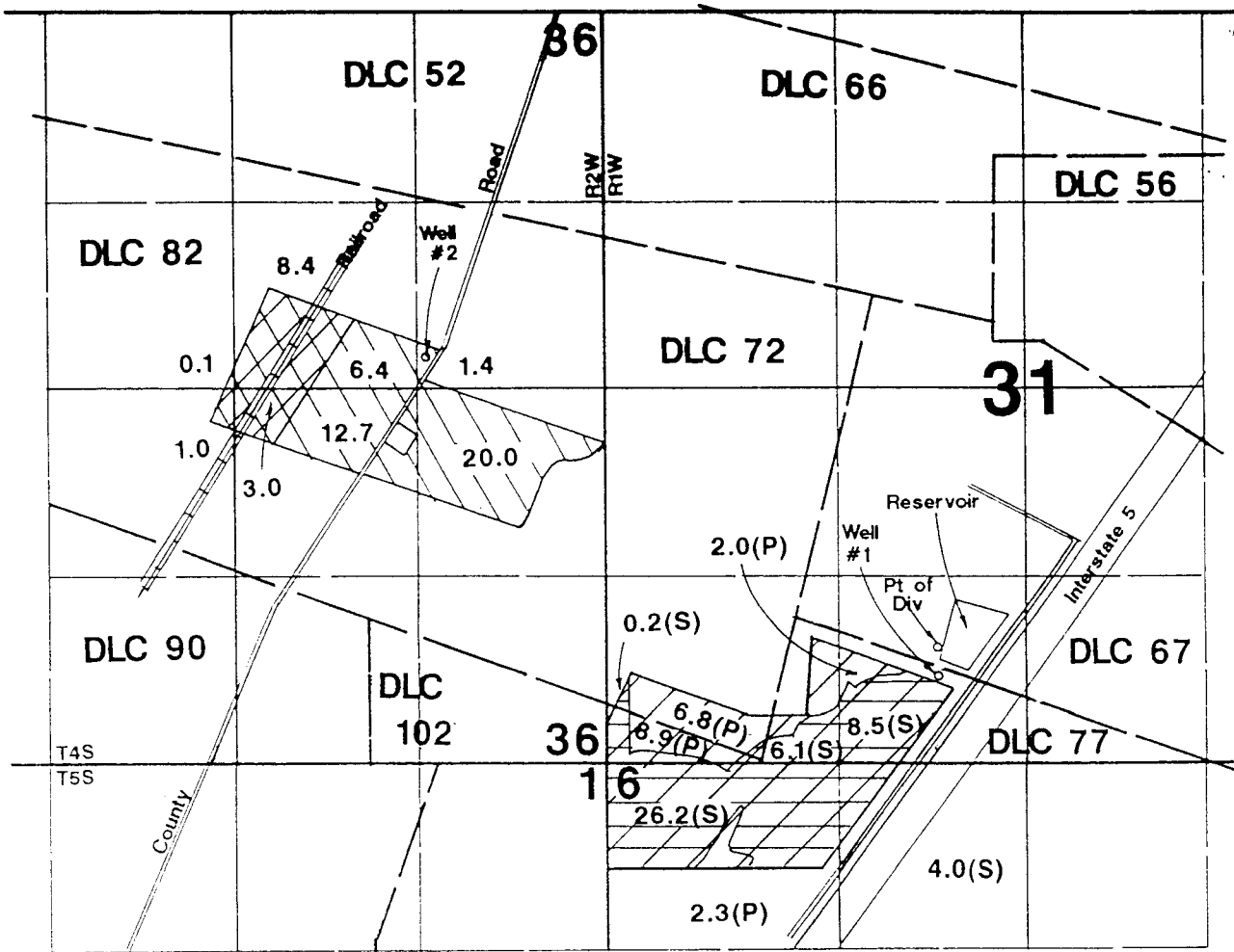

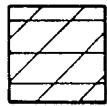
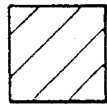
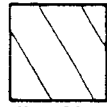
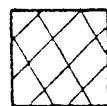
-  Well #1-Supplemental
-  Well #2-Primary
-  Well #2-Nursery Operations
-  Well #2-Irrigation

Pt of Div located 820'N & 2350'E from SW corner Section 31.
Well #1 located 620'N & 2350'E from SW corner Section 31.
Well #2 located 230'N & 1280'W from W 1/4 corner Section 31.

Application Map

Marion County Solid Waste

Application #: G-13166

Permit # 51922

R-72924

72925 ✓

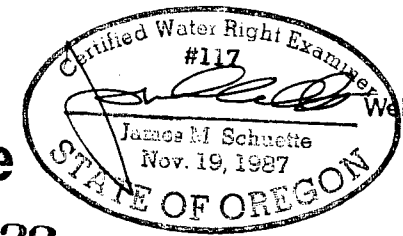

THIS MAP WAS PREPARED FOR THE PURPOSE OF IDENTIFYING THE LOCATION OF A WATER RIGHT ONLY AND IS NOT INTENDED TO PROVIDE LEGAL DIMENSIONS OR LOCATION OF PROPERTY OWNERSHIP LINES.