

RECEIVED

MAY 10 1995

WATER RESOURCES DIVISION
SALEM, OREGON

WATER RIGHT APPLICATION MAP FOR LAKESIDE INDUSTRIES

IN THE N.E. ONE-QUARTER OF SECTION 19, T.1 N., R. 1 E., W.M.
MULTNOMAH COUNTY, OREGON
MAY, 1995



SCALE: 1" = 400'

18 17
19 20

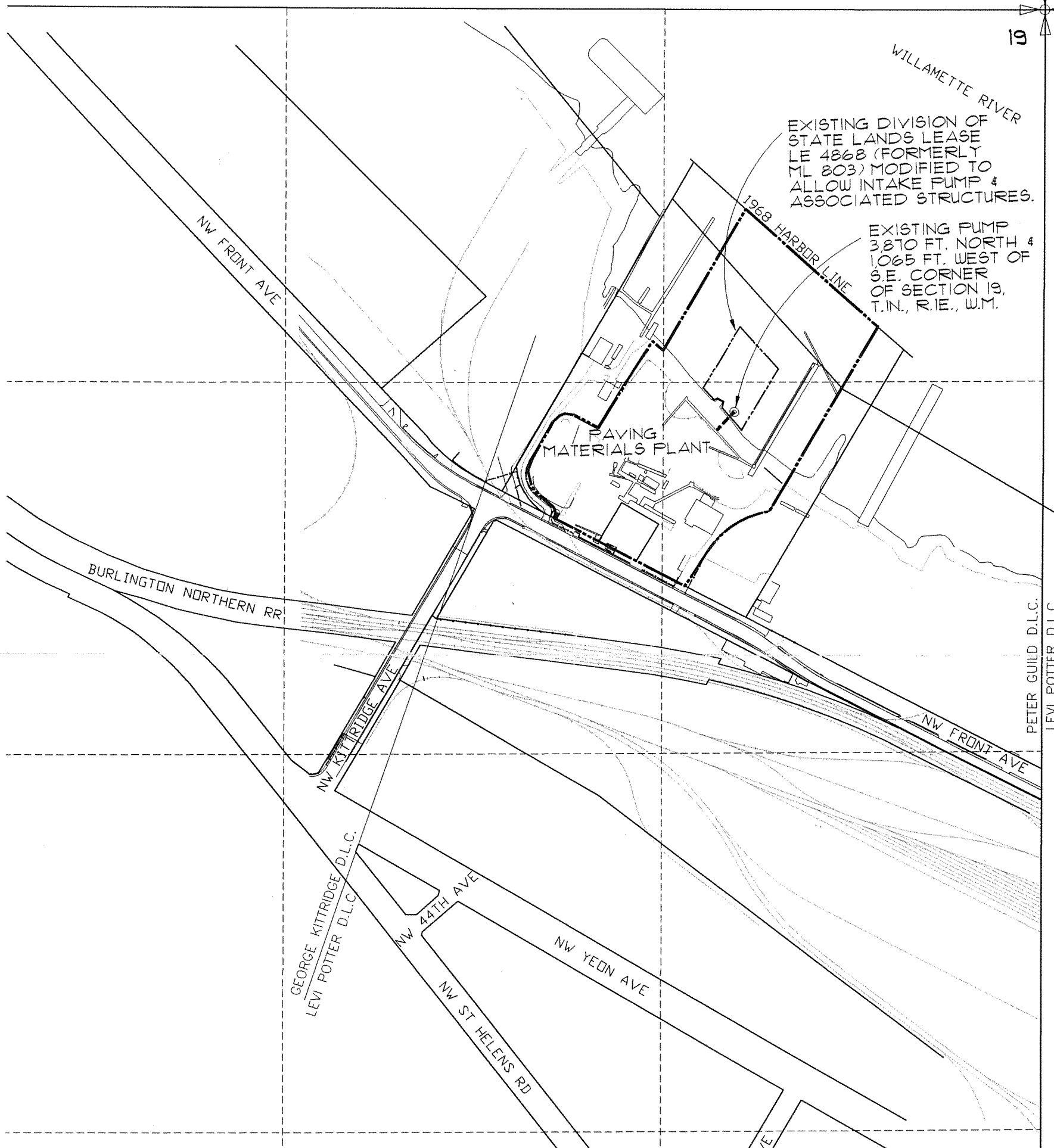

EXISTING DIVISION OF STATE LANDS LEASE LE 4868 (FORMERLY ML 803) MODIFIED TO ALLOW INTAKE PUMP & ASSOCIATED STRUCTURES.

EXISTING PUMP 3,870 FT. NORTH & 1,065 FT. WEST OF S.E. CORNER OF SECTION 19, T.1 N., R.1 E., W.M.

PAVING MATERIALS PLANT

PETER GUILD D.L.C.
LEVI POTTER D.L.C.

GEORGE KITTRIDGE D.L.C.
LEVI POTTER D.L.C.

LEGEND

- EXISTING 2" MAINLINE
- PROPERTY LINE
- SECTIONAL SUBDIVISION LINE

NOTE
THIS MAP IS TO IDENTIFY A PROPOSED WATER RIGHT LOCATION. IT IS NOT TO BE USED TO LOCATE PROPERTY BOUNDARIES.

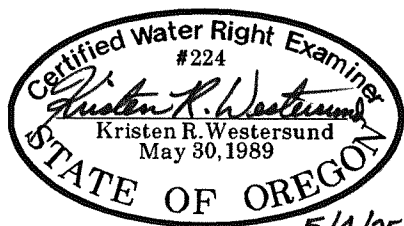

5/4/95

RENEWAL DATE:
JUNE 30, 1996



DAVID EVANS AND ASSOCIATES, INC.
2828 S.W. CORBETT AVENUE
PORTLAND, OREGON 97201
(503) 223-6663

19 20
30 29

Application No. 80 300
Permit No. 51985