

WATER RESOURCES DEP  
SALEM, OREGON

THIS MAP WAS PREPARED FOR THE  
PURPOSE OF IDENTIFYING THE LOCA-  
TION OF A WATER RIGHT ONLY AND IS  
NOT INTENDED TO PROVIDE LEGAL  
DIMENSIONS OR LOCATION OF PROPER-  
TY OWNERSHIP LINES.



1" = 400'

CASCADE HWY. NE

1/4 COR

CTR SEC

STATE ST.

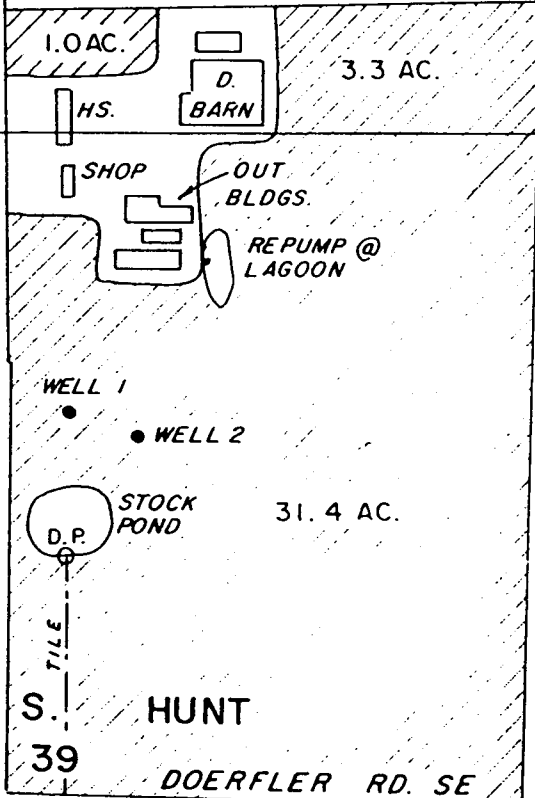

JOHN  
DLC

RE-ENT COR  
J.S. HUNT  
DLC 39

S. CENTRE  
DLC 41

WATER RIGHT MAP FOR  
MONTE J. CARPENTER  
CARPENTER'S DAIRY

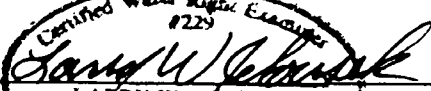
BY:   
LARRY W. LEBOUSEK  
Dec. 17, 1989  
STATE OF OREGON

33 34  
4 3

1/4 COR

D.P. LOC. 520' N. & 130' E. FROM RE-ENT COR, J.S. HUNT DLC 39  
WELL NO. 1 LOC. 820' N. & 120' E. FROM RE-ENT COR, J.S. HUNT DLC 39  
WELL NO. 2 LOC. 760' N. & 260' E. FROM RE-ENT COR, J.S. HUNT DLC 39