

T 9 S, R 6 W, W.M.

POLK COUNTY, OREGON

RECEIVED

JUN 21 1994

PL 1000-101

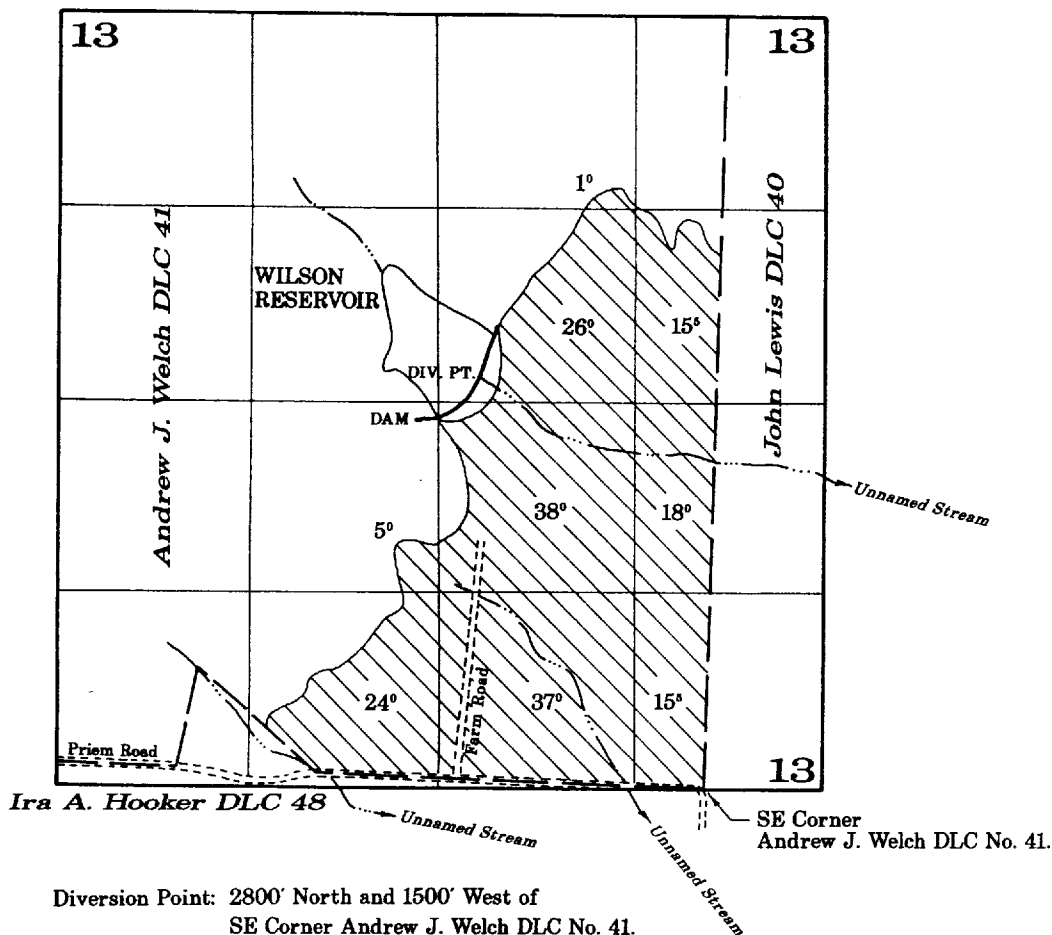

Diversion Point: 2800' North and 1500' West of
SE Corner Andrew J. Welch DLC No. 41.

APPLICATION TO APPROPRIATE SURFACE WATER

Application 74220
R 73432
S 73433

Permit 52023

PETER DINSDALE

March 9, 1994

Scale: 1" = 1320'

NOTE: This map is for the purpose of identifying the location of water rights and has no intent to dimension or locate property ownership lines.

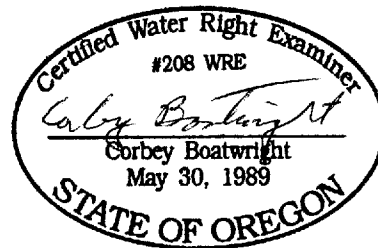

T.9S. R.6W. W.M.

POLK COUNTY

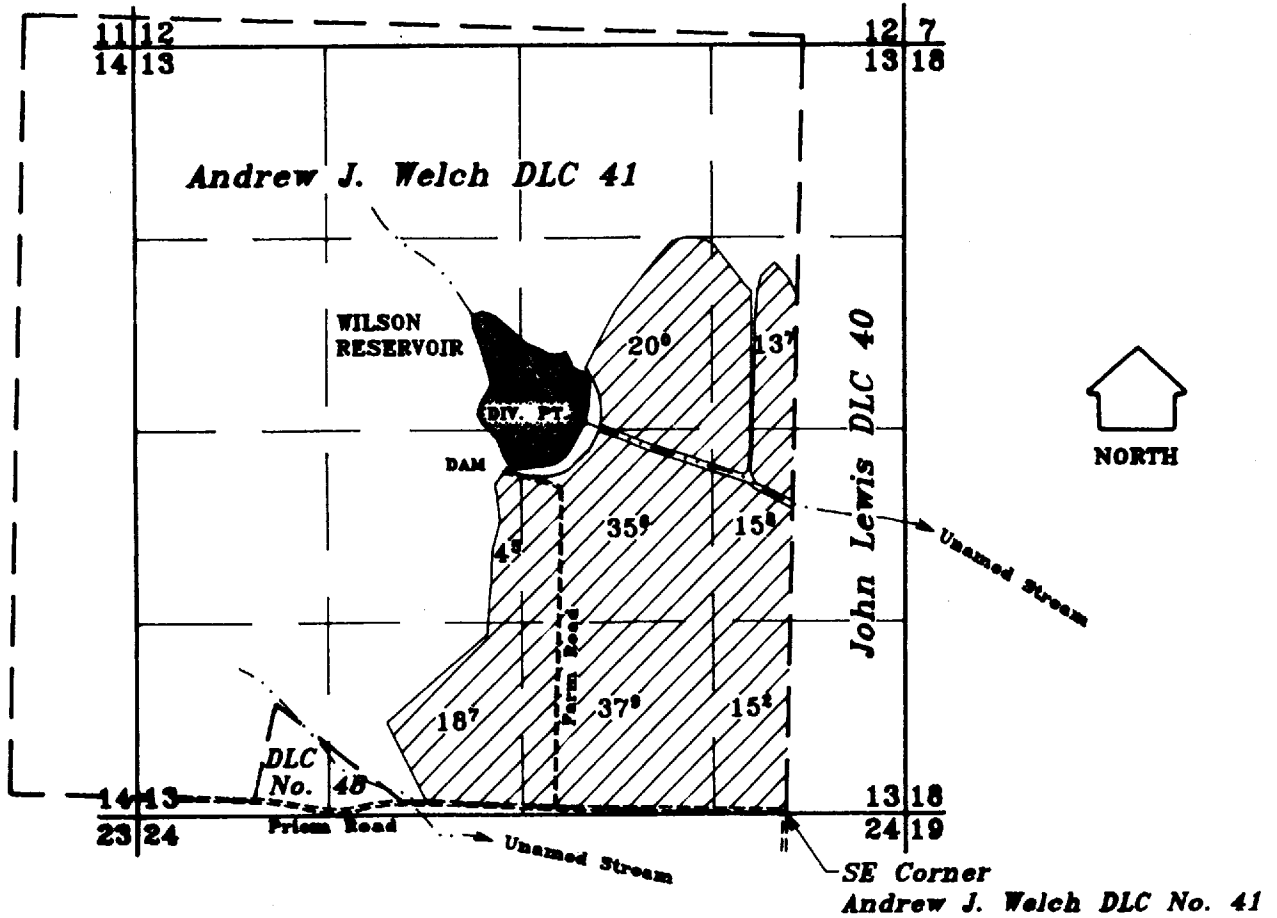

Diversion Point: 2696' North and 1388' West of
SE Corner Andrew J. Welch DLC No. 41.

R-73432	R-11493
S-73433	S-51528
R-74221	R-11702
Application No. <u>S-74220</u>	Permit No. <u>S-52023</u>

FINAL PROOF SURVEY

IN NAME OF

Peter Dinsdale

SEPTEMBER 24, 1998

SCALE 1" = 1320'

RECEIVED

OCT 02 1998

WATER RESOURCES DEPT.
SALEM OREGON

NOTE: This map is for the purpose of identifying the location of water rights and has not intent to dimension or locate property ownership lines.

