

FINAL PROOF MAP

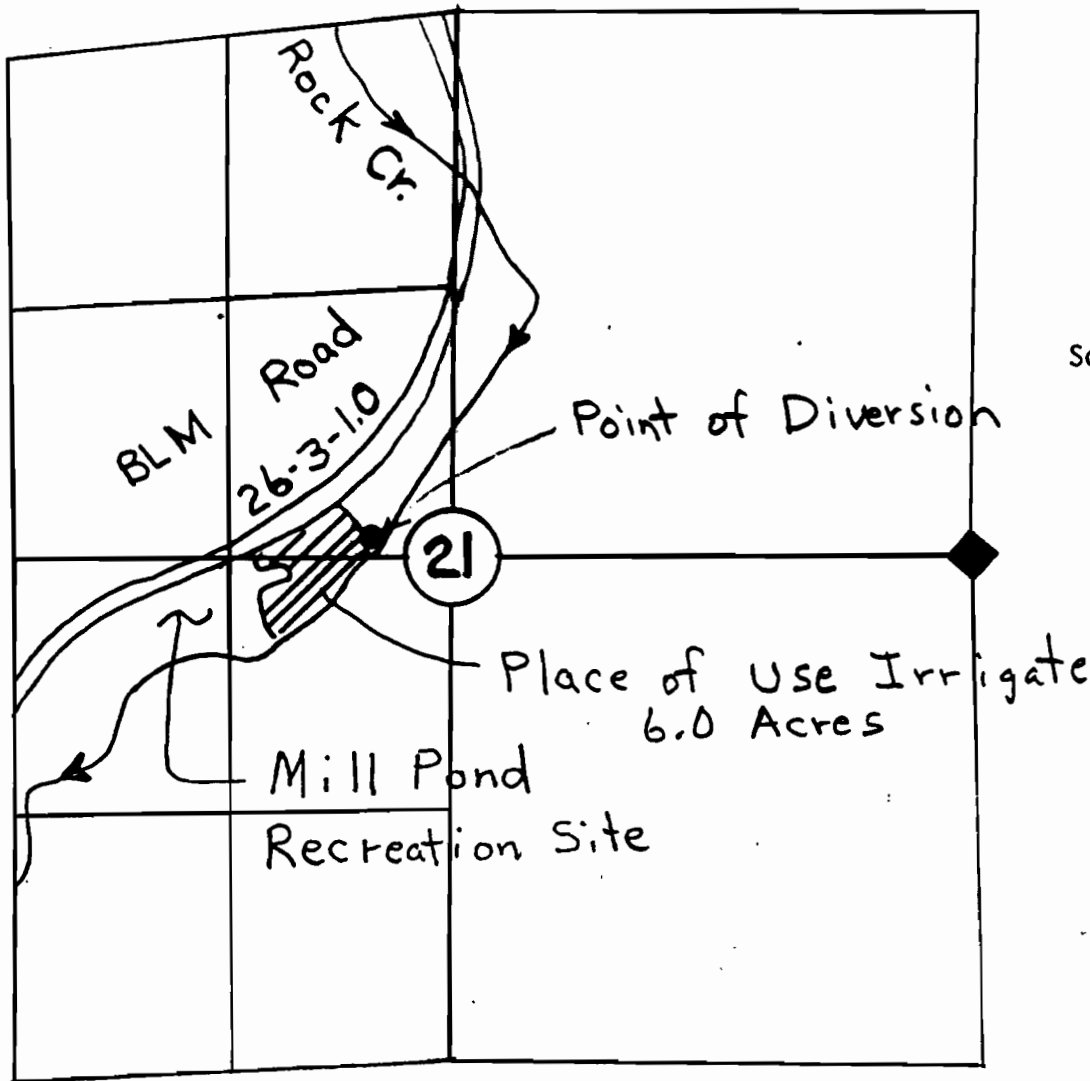

MILL POND RECREATION SITE
T25S R2W Sec 21
SE $\frac{1}{4}$, NW $\frac{1}{4}$ NE $\frac{1}{4}$, SW $\frac{1}{4}$

The point of diversion is located 100 ft North and 3050 ft West from the East Quarter Corner of Section 21.

Coordinate Ties are based on aerial photo 8-43A-35-89.

The map is shown for the purpose of water application and not property boundary.

Application No. 71055
Permit No

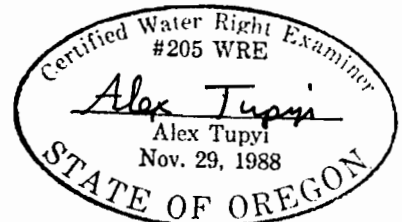

3-08-90