

RECEIVED

APPLICATION MAP

FEB 24 1994

IN THE NAME OF JANE NEIDEIGH

WATER RESOURCES DEPT.
SALEM, OREGON

SECTION 13, TOWNSHIP 22 SOUTH, RANGE 10 WEST, W.M.



1 INCH = 1320 FEET

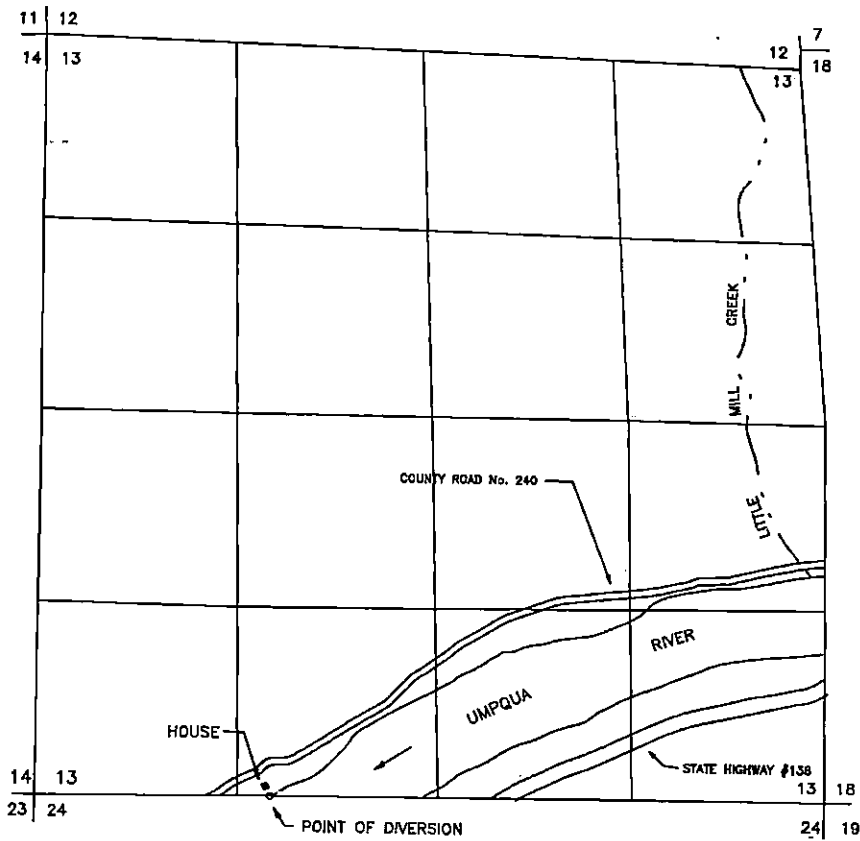

permit 52250

THE POINT OF DIVERSION IS TO BE LOCATED 10 FEET NORTH AND 1630 FEET EAST OF THE SOUTHWEST CORNER OF SECTION 13, BEING WITHIN THE SE 1/4 OF THE SW 1/4 OF SECTION 13, TOWNSHIP 22 SOUTH, RANGE 10 WEST, W.M., DOUGLAS COUNTY.

THE PURPOSE OF THIS MAP IS TO IDENTIFY THE LOCATION OF THE WATER RIGHT. IT IS NOT INTENDED TO PROVIDE INFORMATION RELATIVE TO THE LOCATION OF PROPERTY OWNERSHIP BOUNDARY LINES.

