

SUPERCEDED ING RECEIVED

APR 26 1996 *VL*

WATER RESOURCES DEPT.
SALEM, OREGON

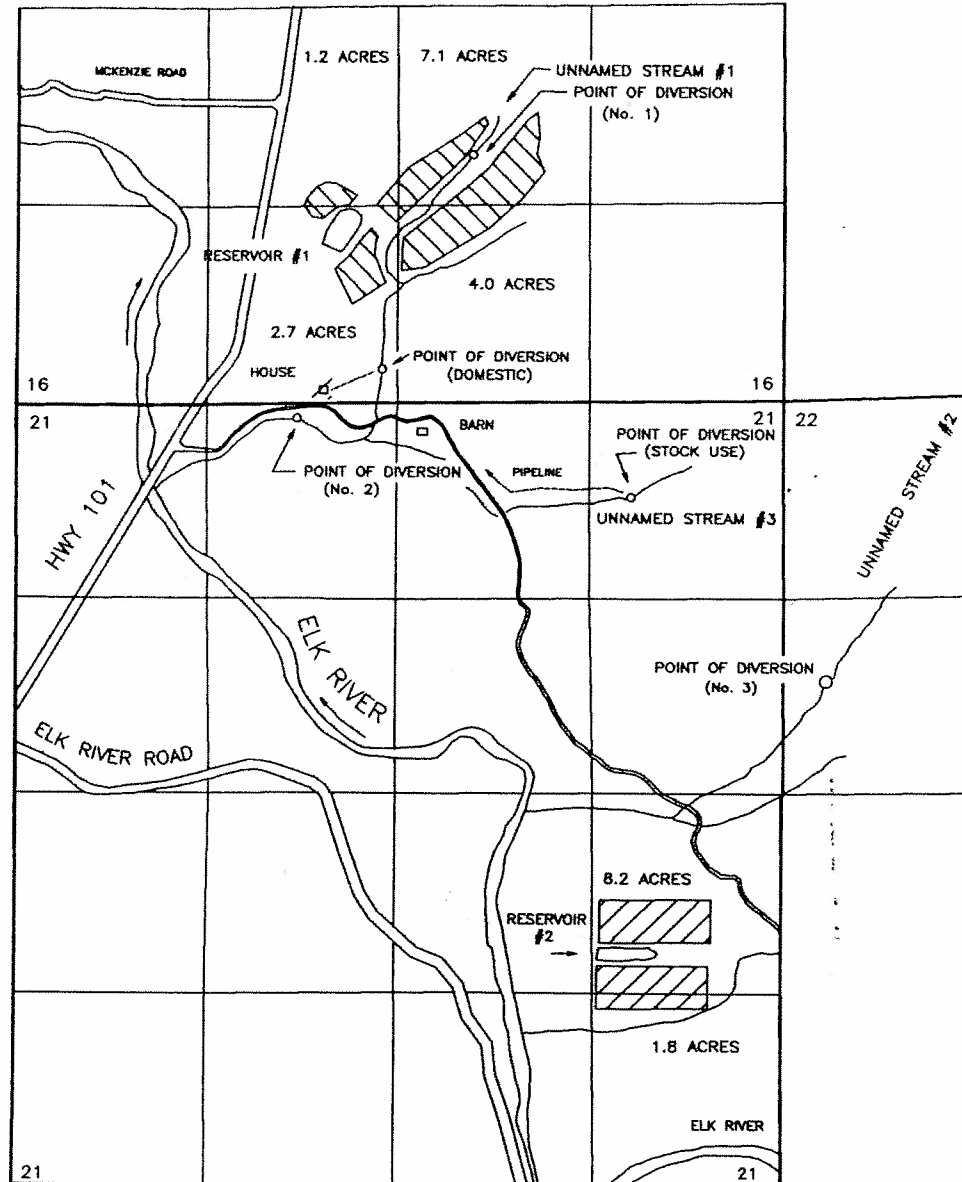

Diversion	North/South	East/West	Sec.	¼ ¼ Sec.
Reservoir No. 1	1040 North	3095 West	16	SE¼ SW¼
Reservoir No. 2	3820 South	1230 West	21	NE¼ SE¼
P.O.D. No. 1	1670 North	2090 West	16	NW¼ SE¼
P.O.D. No. 2	110 South	3310 West	21	NE¼ NW¼
P.O.D. No. 3	1930 South	310 East	22	SW¼ NW¼
Domestic P.O.D.	220 North	2750 West	16	SE¼ SW¼
Stock P.O.D.	650 South	1040 West	21	NE¼ NE¼

ALL FROM THE NORTHEAST CORNER OF SECTION 21, TOWNSHIP 32 SOUTH, RANGE 15 WEST, W.M., WITHIN CURRY COUNTY.

Permit # 52289

WATER RESOURCES DEPT.
SALEM, OREGON

MAY - 9 1996

RECEIVED

*72911
72912*