

WALLOWA LAKE

Application No. 69066
Permit No.

RECEIVED

FEB 03 2003

WATER RESOURCES DEPT.
SALEM, OREGON

STATE PARK

AREA SERVED BY
CHIEF JOSEPH RESORT WATER DISTRICT

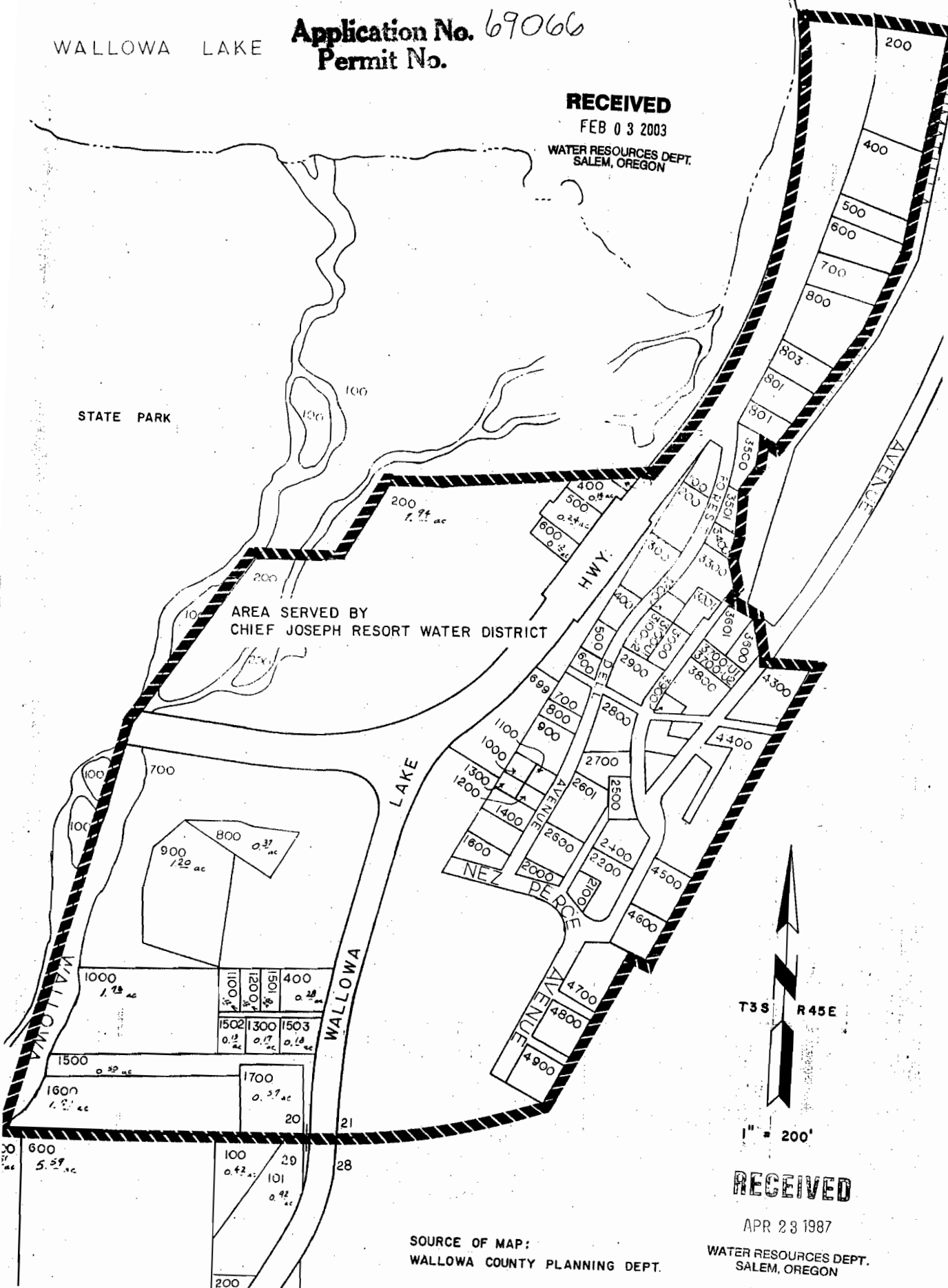

T3S R45E

1" = 200'

RECEIVED

APR 23 1987

WATER RESOURCES DEPT.
SALEM, OREGON

SOURCE OF MAP:
WALLOWA COUNTY PLANNING DEPT.