

RECEIVED

MAR 21 1988

WATER RESOURCES DEPT.
SALEM, OREGON

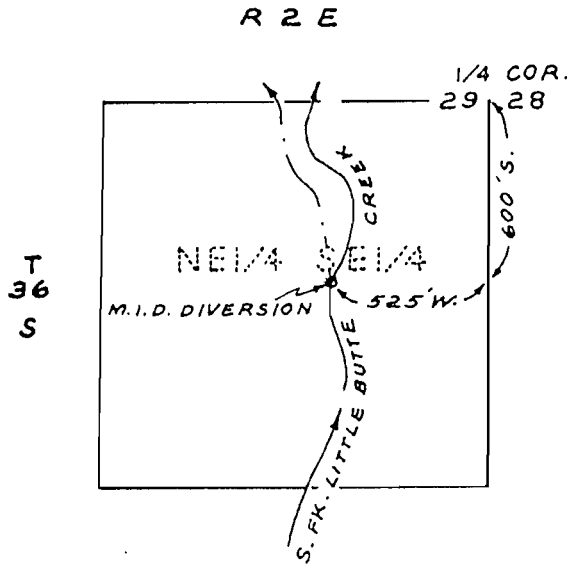

SCALE 8" = 1 MILE

APPLICATION MAP FOR
CRATER LAKE ORCHARDS

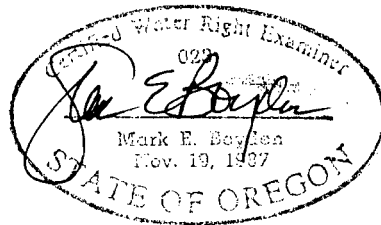

3/18/88.

Application No. 69559 & R-69595
Permit No.

T. 37 S. R. 1 W., W.M.
 APPLICATION MAP FOR:
 CRATER LAKE ORCHARD

RECEIVED

MAR 21 1988

WATER RESOURCES DEPT.
 SALEM, OREGON

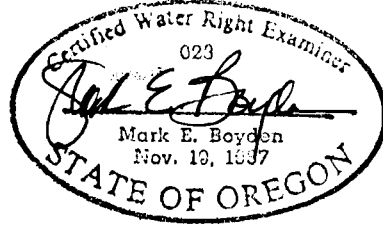

3/18/88.

CTR. 1/4 COR.
 SEC. 8

8

S 1/4 SEC. COR.
 SECS 8 & 9

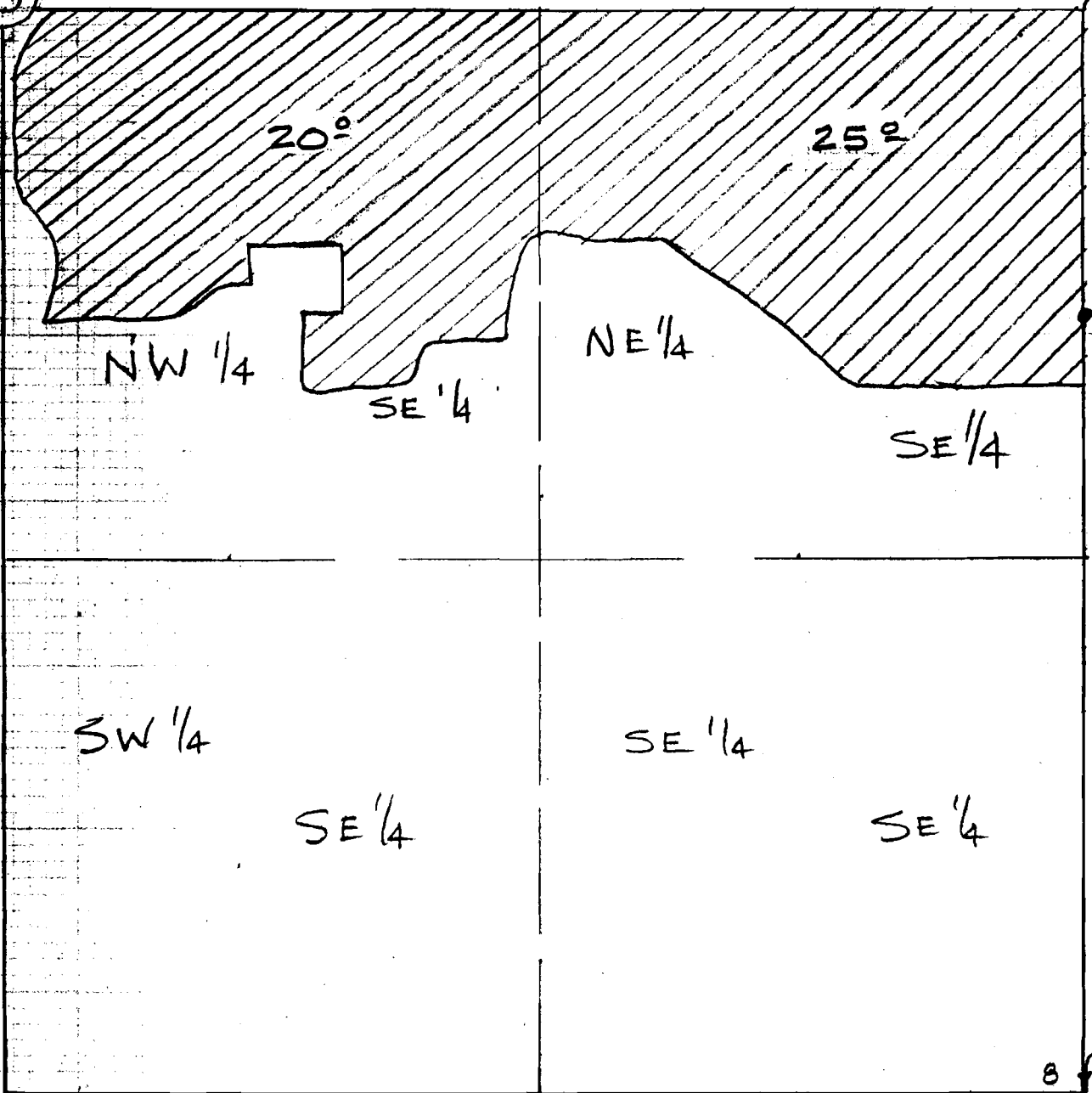

M.I.D.
 FT. OF
 DELIVERY

SCALE:
 1" = 400'

1/4 SEC. COR.
 SECS 8 & 17

S SEC. COR.
 8 1/2
 17 1/6

APPROVED _____
 Application No. 69559 & R-69595
 Permit No.

APR 15 1988

WATER RESOURCES DEPT.
SALEM, OREGON

T. 37S., R. 1W., W.M.

TAX LOT No 37 1W 8-2700

JACKSON COUNTY, OREGON

Application No. R-69595 & 69559
Permit No. 52414

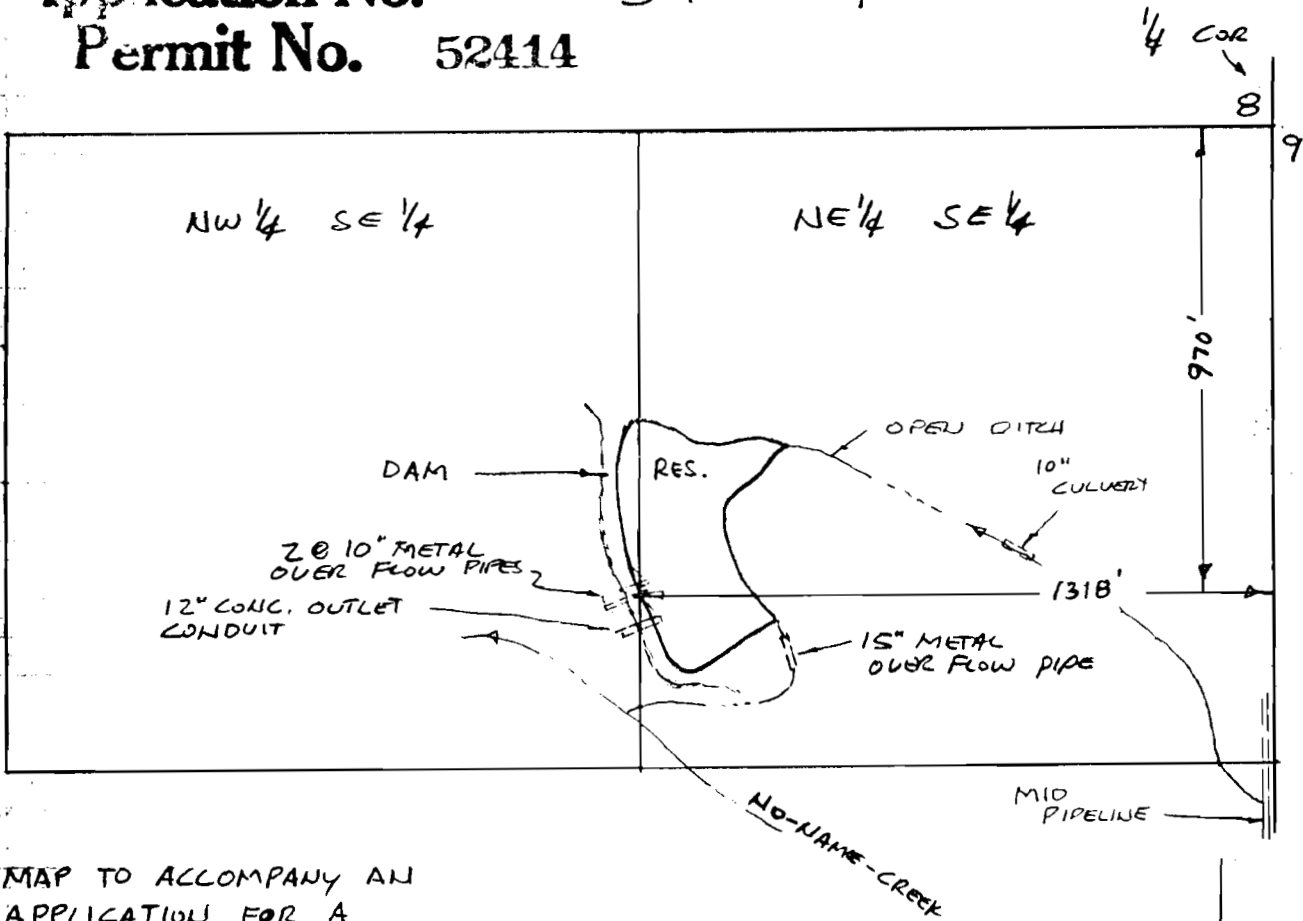

MAP TO ACCOMPANY AN
APPLICATION FOR A
RESERVOIR PERMIT
FOR: CRATER LAKE ORCHARDS
P.O. BOX 129
MEDFORD, OR 97501

PREPARED BY:
GARY D. KAISER
BOYDEN SURVEYORS
108 MISTLETOE ST.
MEDFORD, OR 97501

NOTE: MAP PREPARED FOR
WATER RIGHT PURPOSES
ONLY, NOT FOR PROPERTY
BOUNDARY LOCATIONS

APRIL 13, 1988

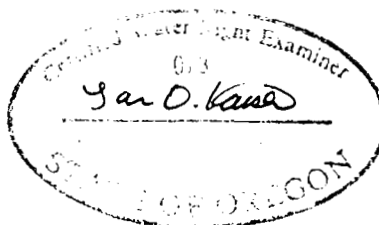

SCALE: 1" = 400'