

MAP

Accompanying application of CALVIN LANE DUSENBERRY
of Gold Hill, Oregon for permit to appropriate the Flood
and Surplus waters of Sardine Creek tributary to Roque
River, Jackson County, Oregon.

August 1917.

Medford, Oregon.

T36. S. R. 3. W. W. M.

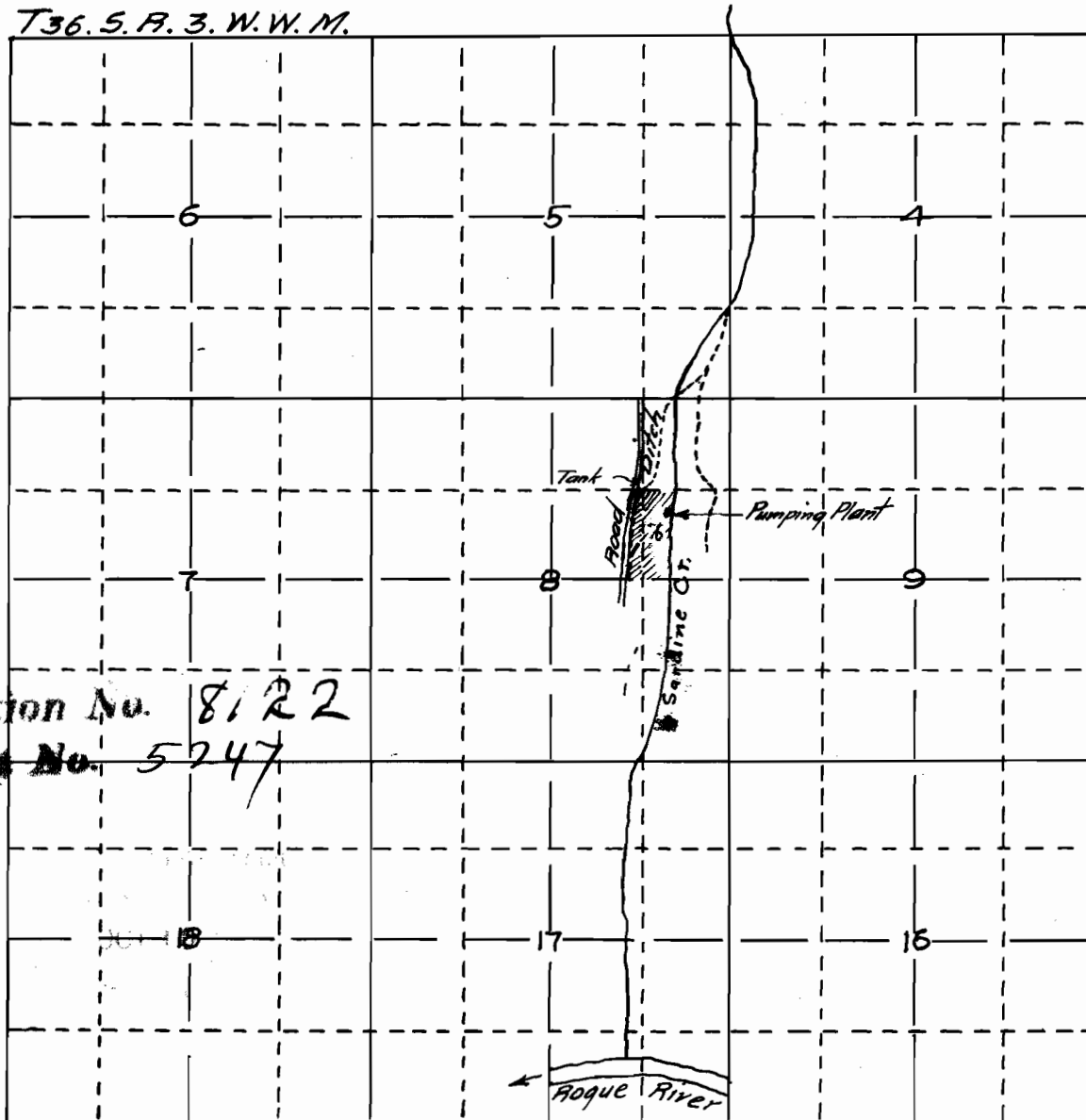

Application No. 8122
Permit No. 5247

5790
3561

Map made from notes of an examination in the field
by me August 1917 correctly showing lands to be
irrigated and streams and ditches in the immediate
vicinity

Fred. N. Cummings, C.E.