

T. 34 S., R. 1 W., W. M.  
 JACKSON COUNTY, OREGON

RECEIVED

APR - 7 1995

WATER RESOURCES DEPT.  
 SALEM, OREGON

Permit # 52488

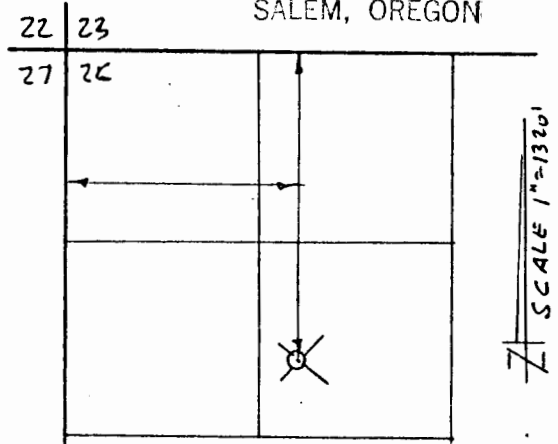
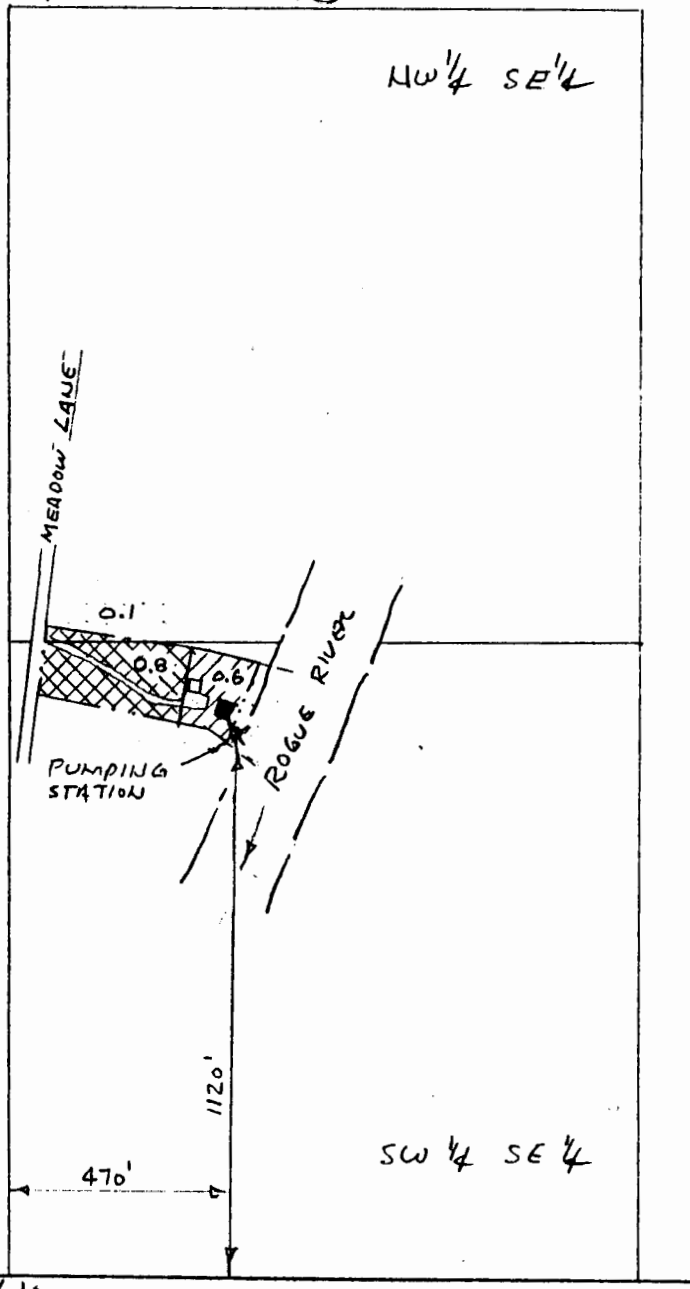

POINT OF DIVERSION  
 LOST CREEK RESERVOIR  
 T. 33 S., R. 1 E., W. M.

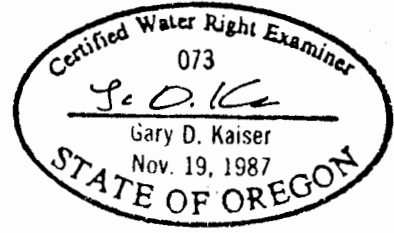

SCALE: 1" = 400'

- AREA REQUESTING WATER FROM LOST CREEK RES.
- AREA CURRENTLY BEING IRRIGATED BY PERMIT No. 18860, CERT. No. 20272

MAP PREPARED TO ACCOMPANY AN APPLICATION TO APPROPRIATE SURFACE WATER (WATER FROM LOST CREEK RESERVOIR CONST. UNDER PERMIT No. R-8142)

PREPARED BY:  
 GARY D. KAISER  
 KAISER SURVEYING  
 19440 Hwy. 62  
 EAGLE POINT, OR 97524

FOR: MICHAEL T. MALEPSY AND BONNIE L. MALEPSY  
 36 MEADOW LAKE  
 SHADY COVE, OR 97539

NOTE: MAP PREPARED FOR WATER RIGHT PURPOSES ONLY, NOT FOR PROPERTY BOUNDARY LOCATIONS

DATE: July 31, 1992  
 REVISED 4-3-95 GDK