

* DESIGNATES PRESENT WATER SERVICE IN SIXTEENTH SECTION OR AS PROJECTED WITHIN DLC

MAP PREPARED BY:
WILLIAM J. RUPPERT, CWRE 115
P.O. BOX 1564
MYRTLE CREEK, OR 97457



Application No. 73812
Permit No. 52517

MAP TO ACCOMPANY APPLICATION
TO APPROPRIATE SURFACE WATER
PLACE OF USE IN SECTIONS 15, 21,
22, 27 AND 28, T29S, R5W, WM
for
City of Myrtle Creek

WATER MAINS FROM CITY RECORDS

FILE WR2SPR93

CITY of MYRTLE CREEK
WATER MAINS &
PRESENT SERVICE LIMITS

DB: WJR 12/93 STEVEN M. JOHNSON PUBLIC WORKS DIR. SHEET 2 of 2

SHEET 2 of 2

Application No. 73812
 Permit No. 52517

T29S, R5W, WM

MAP TO ACCOMPANY
 APPLICATION TO
 APPROPRIATE
 SURFACE WATER

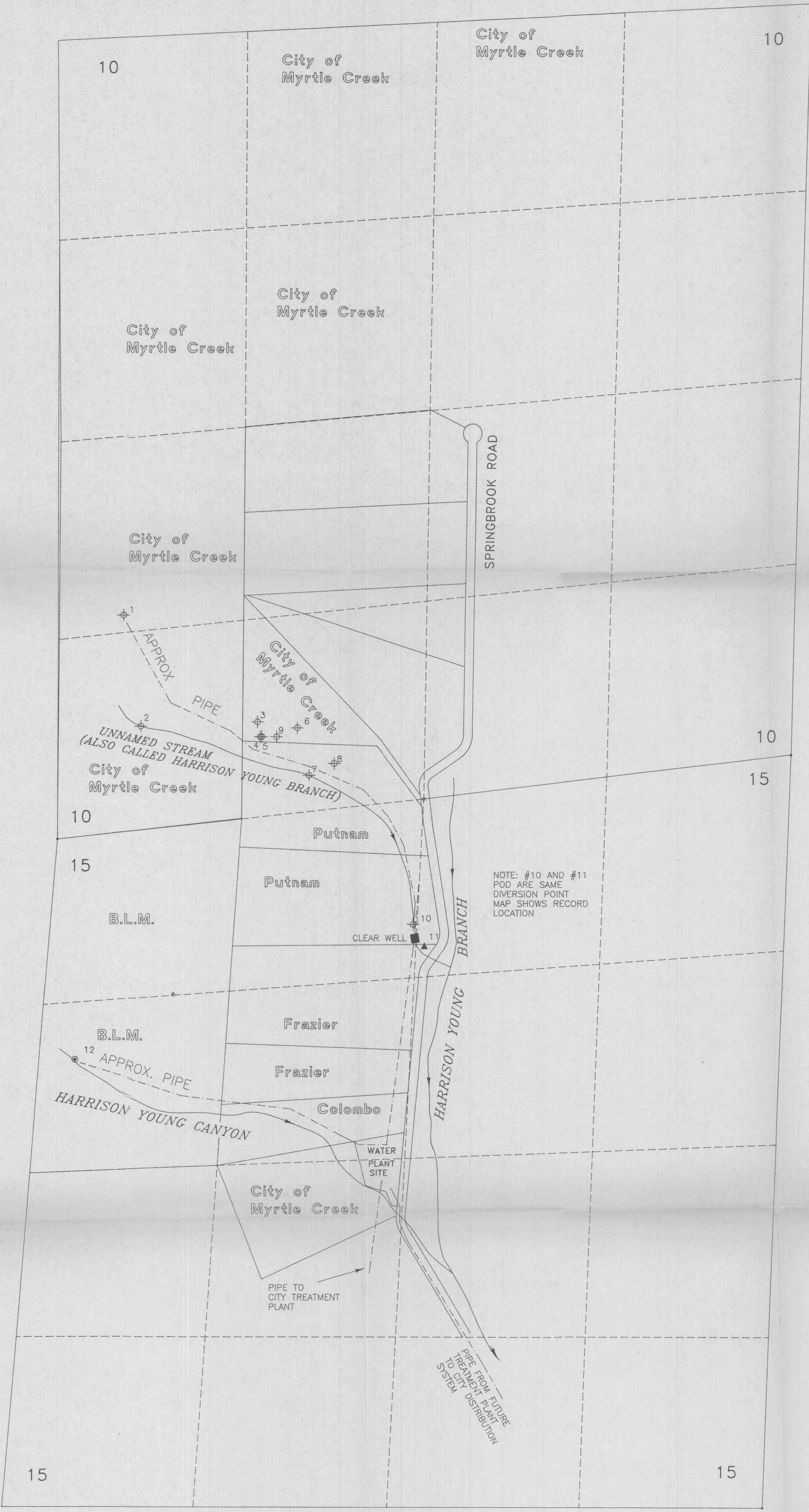

Application No. 73812
 Permit No.



0 400 800 1600

SCALE

ACAD FILE WR1SPR93

EXISTING WATER RIGHTS				
MAP POD#	GPM	PERMIT #	STATE POD ID	PRIORITY
1	5	43121	11829	1978
2	*	43121	11831	1978
3	20	43121	11829	1978
4	10	43121	11829	1978
5	10	43121	11829	1978
6	10	43121	11829	1978
7	5	43121	11829	1978
8	10	43121	11829	1978
9	10	43121	11829	1978
10	*	43121	11832	1978
11	449	5245	11832	1921
12	76	22963	11833	1944 & 1945

600 GPM COMBINED
 1205 GPM TOTAL EXISTING

NEW APPLICATION	
MAP POD#	GPM
1	125
3	50
4	25
5	25
6	100
7	25
8	100
9	50
12	500

1000 GPM NEW APPLICATION

NOTE: DIVERSION POINTS
 LOCATED FROM WATER
 RIGHT RECORDS

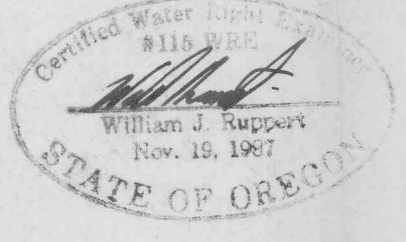

BY:
 WILLIAM J. RUPPERT, CWRE 115
 P.O. BOX 1564
 MYRTLE CREEK, OR 97457

CITY of MYRTLE CREEK
 Water Rights
 Springbrook Area
 DB: WJR 12/93 STEVEN M. JOHNSON SHEET 1 of 2
 PUBLIC WORKS DIR.