

I W.F. Rankin of Unity Oregon,
do hereby certify that this map
was made from notes taken by me
during an actual survey from 10/16
to 11/1/1917; and it correctly re-
presents the works as repre-
sented in the map.

W.F. Rankin,
Surveyor.

Bearings Of Ditch.

| Station No. | Bearing | Distance | Station No. |
|-------------|--------------|----------|-------------|
| 1 | S. 30° 18' W | 74 | 2 |
| 2 | S. 61° E | 51 | 3 |
| 3 | S. 90° E | 74 | 4 |
| 4 | N. 70° E | 46 | 5 |
| 5 | N. 50° E | 92 | 6 |
| 6 | S. 18° E | 93 | 7 |
| 7 | S. 16° E | 12 | 8 |
| 8 | S. 53° 46' E | 2 | 9 |
| 9 | S. 61° 45' E | 1 | 10 |
| 10 | N. 24° 24' E | 14 | 11 |
| 11 | N. 73° 30' E | 3 | 12 |
| 12 | N. 47° 10' E | 23 | 13 |
| 13 | N. 67° 30' E | 10 | 14 |
| 14 | N. 96° 30' E | 9 | 15 |
| 15 | N. 55° 15' E | 24 | 16 |
| 16 | N. 53° 16' E | 24 | 17 |
| 17 | N. 75° 36' E | 17 | 18 |
| 18 | N. 30° 46' E | 7 | 19 |
| 19 | N. 62° 30' E | 21 | 20 |

Application No. 8167
Permit No. 5279

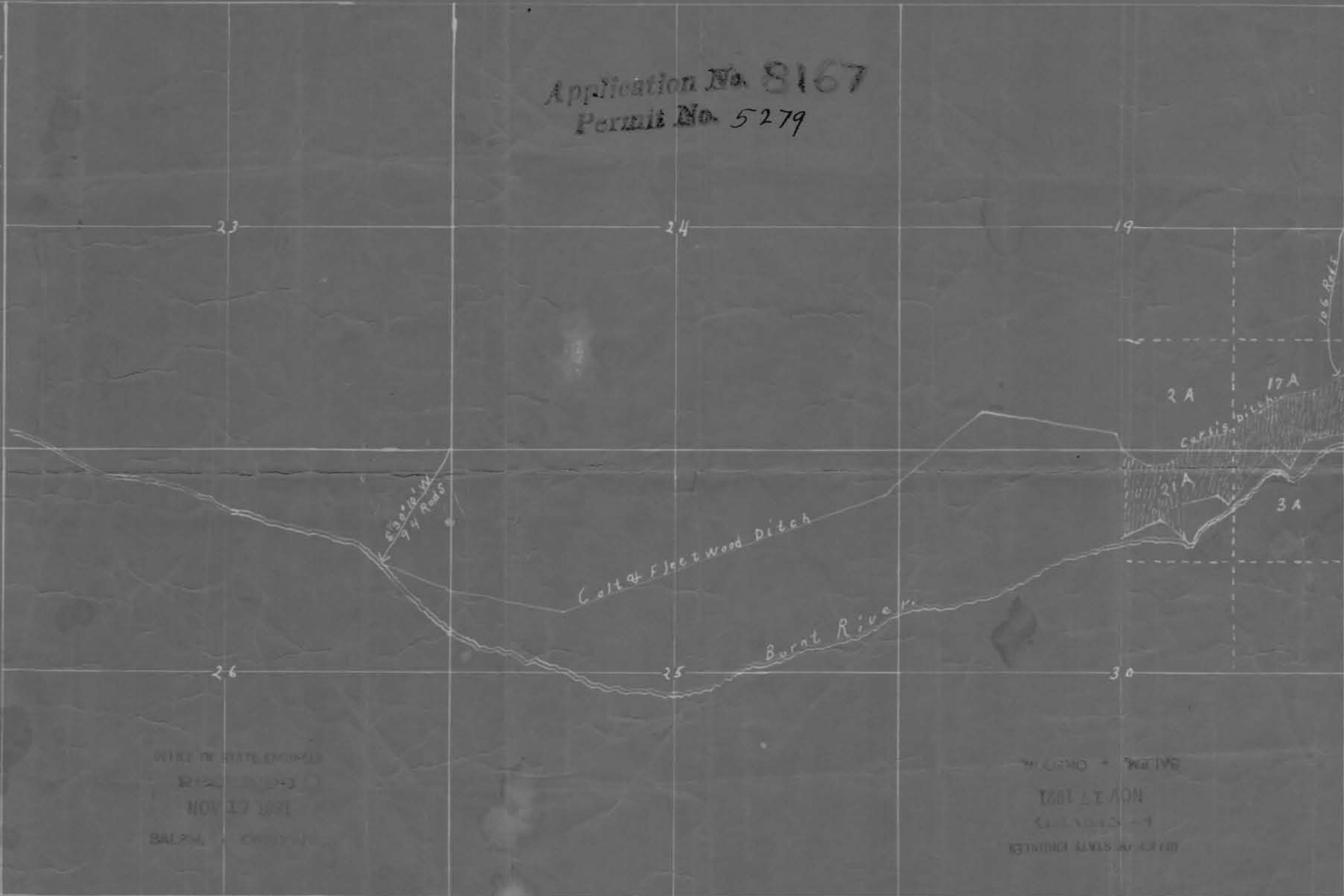

OFFICE OF STATE ENGINEER
NOV 17 1917
SALZMANN

W. F. RANKIN
NOV 17 1917
STATE ENGINEER

Field work by W.F. Rankin, Date 10/16 to 11/1/1917 Platted by W.F. Rankin

Approved _____ 19 _____

(Approving officer)

State Engineer