

Application No. S-77041
 Permit No. 52846

T 27 S, R 29 E, WM

RECEIVED

JAN 30 1995

WATER RESOURCES DEPT.
 SALEM, OREGON

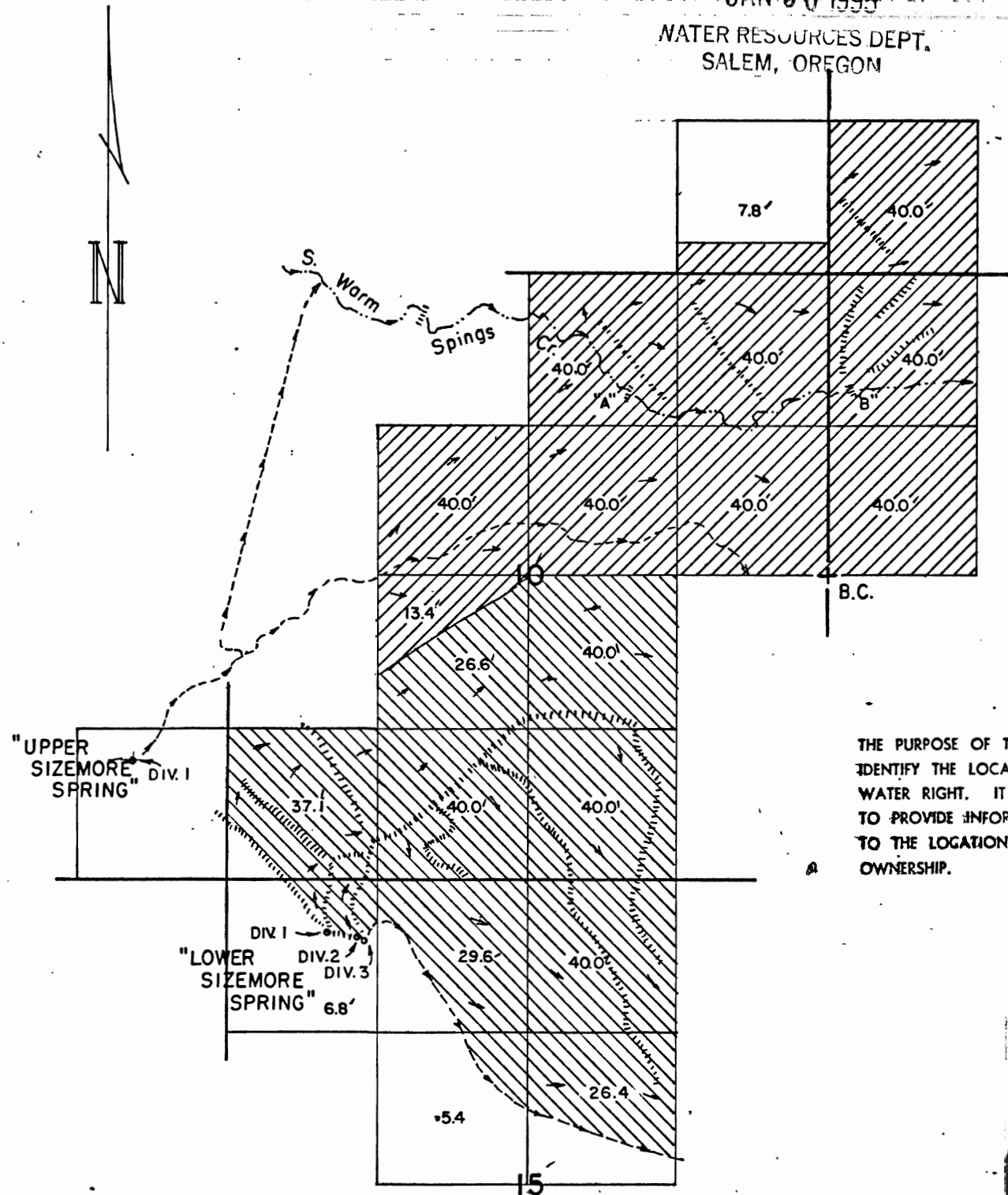

NOTES

THIS MAP WAS DRAWN FROM FIELD NOTES TAKEN DURING A SURVEY MADE ON NOV. 15, 1994. BEARINGS ARE BASED ON SOLAR OBSERVATIONS.

DIKES "A" & "B" SHOWN ON S. WARM SPRINGS CR. ARE FOR DIVERSION OF WATER FROM "UPPER SIZEMORE SPRING". "A" & "B" ARE OF RECORD PER PERMIT NO. 3187, CERTIFICATE NO. 3222.

LEGEND

- ////// IRRIGATED LAND FROM UPPER SIZEMORE SPR.
- \\\\\\\\ " " " LOWER " "
- - - - DITCHES
- ||||| LEVEES & DIKES

DIVERSION POINT LOCATIONS FROM THE ONE-QUARTER SEC. COR. COMMON TO SEC'S 10 & 11.

UPPER SIZEMORE SPR., DIV. I	1574' S,	6096' W	-P
LOWER " " "	3081' S,	4384' W	-P
" " "	3139' S,	4226' W	A
" " "	3169' S,	4180' W	A

THE PURPOSE OF THIS MAP IS TO IDENTIFY THE LOCATION OF THE WATER RIGHT. IT IS NOT INTENDED TO PROVIDE INFORMATION RELATIVE TO THE LOCATION OF PROPERTY OWNERSHIP.

	J. V. MOON & SON	
	WATER RIGHT APPLICATION MAP	
	Scale: 4" = 1 MILE	Date: JAN. 1995
	Job: 1540	Sht. No.
Dan: Dm: CHRIS Ckd:		
	of 1	