

Application No. 71963
Permit No. 052858

OCT 22 1987
WATER RESOURCES
DIVISION

APPLICATION MAP

IN THE NAME OF LOREN E. HIBBARD

T.22S., R.9 & 10W., W.M.

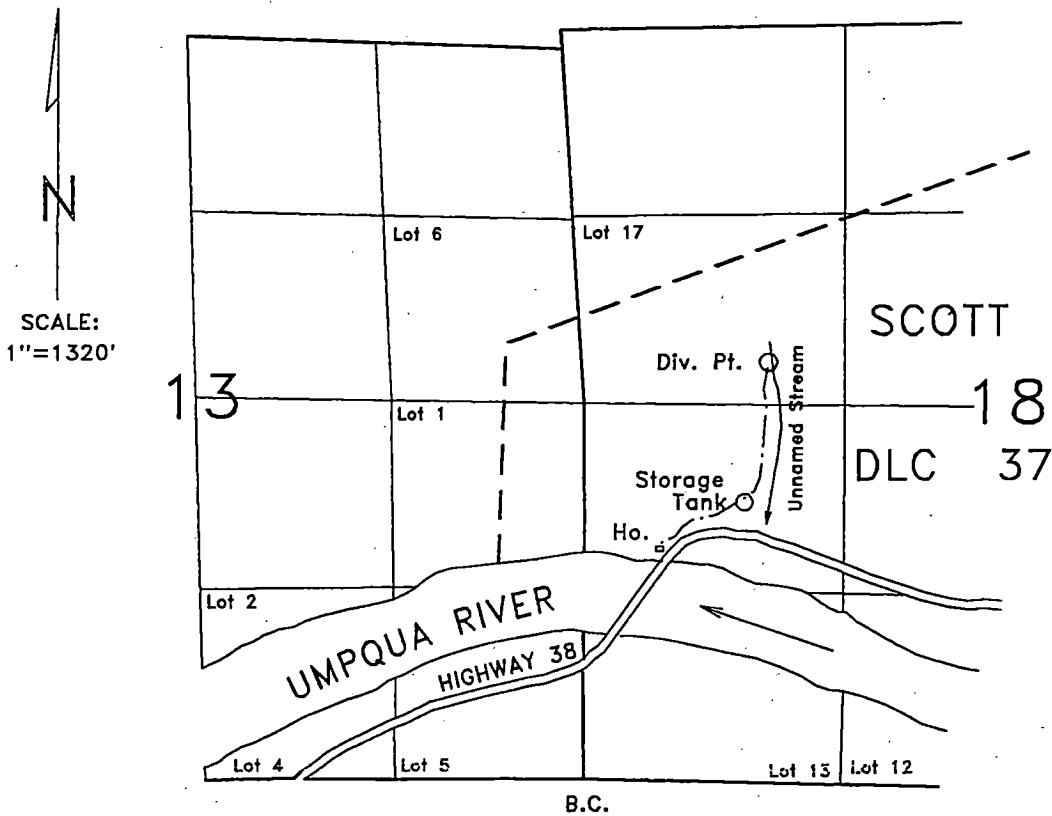

Div. Pt. is located 2800' N. & 1250' E. from SW corner of Section 18.

THE PURPOSE OF THIS MAP IS TO IDENTIFY THE LOCATION OF THE WATER RIGHT. IT IS NOT INTENDED TO PROVIDE INFORMATION RELATIVE TO THE LOCATION OF PROPERTY OWNERSHIP BOUNDARY LINES.

