

Application No. 718741 APPLICATION MAP
Permit No. 52904
 IN THE NAME OF BLANCO BOGS

SECTION 32, T31S, R15W, W.M.
 SECTION 5, T32S, R15W, W.M.

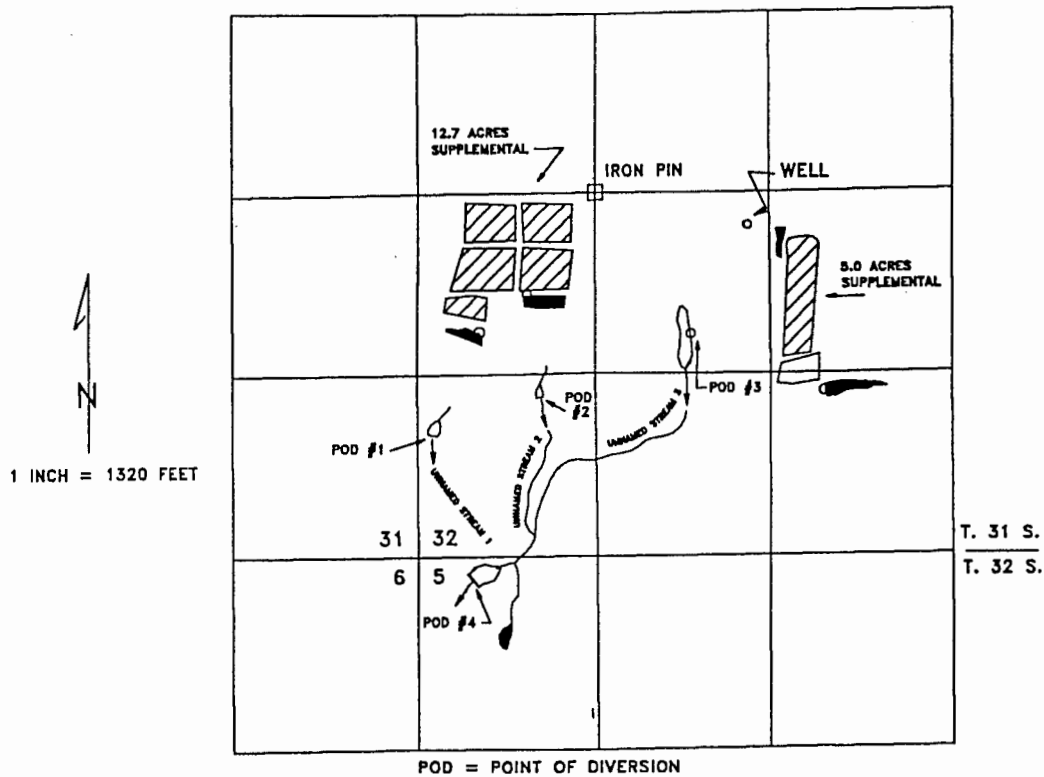

MAP 3 OF 3

SUPPLEMENTAL CRANBERRY USE

POINTS OF DIVERSION:

- No. 1: 850 FEET NORTH & 120 FEET EAST WITHIN THE SW $\frac{1}{4}$ SW $\frac{1}{4}$;
- No. 2: 1100 FEET NORTH & 840 FEET EAST WITHIN THE SW $\frac{1}{4}$ SW $\frac{1}{4}$;
- No. 3: 1520 FEET NORTH & 1880 FEET EAST WITHIN THE NE $\frac{1}{4}$ SW $\frac{1}{4}$;
- WELL: 2270 FEET NORTH & 2260 FEET EAST WITHIN THE NE $\frac{1}{4}$ SW $\frac{1}{4}$;
- ALL IN SECTION 32, TOWNSHIP 31 SOUTH, RANGE 15 WEST, W.M.;
- No. 4: 180 FEET SOUTH & 380 FEET EAST WITHIN THE NW $\frac{1}{4}$ NW $\frac{1}{4}$;
- IN SECTION 5, TOWNSHIP 32 SOUTH, RANGE 15 WEST, W.M.;
- ALL FROM THE SOUTHWEST CORNER OF SECTION 32, TOWNSHIP 31 SOUTH, RANGE 15 WEST, W.M., CURRY COUNTY.

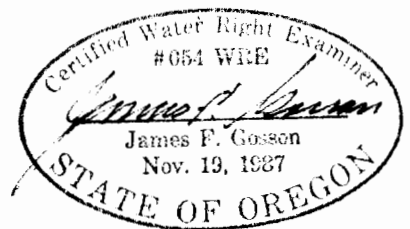

THE PURPOSE OF THIS MAP IS TO IDENTIFY THE LOCATION OF THE WATER RIGHT. IT IS NOT INTENDED TO PROVIDE INFORMATION RELATIVE TO THE LOCATION OF PROPERTY OWNERSHIP BOUNDARY LINES.