

Application No. S74392

Permit No. 52908

RECEIVED
AUG 3 1987

MAP 1 of 2

T. 5 & 6 N., R. 35 E., W. M.

RECEIVED

SEP 03 1996

WATER RESOURCES DEPT.
SALEM, OREGON

N
Scale 1"=1320'

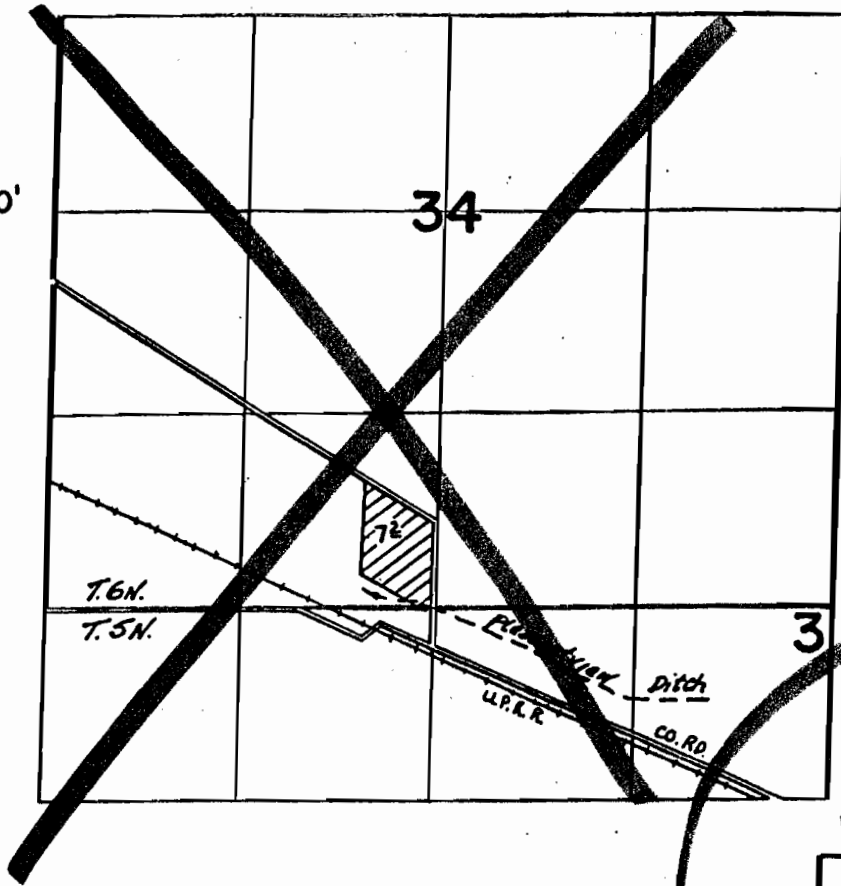

T. 5 N., R. 35 E., W. M.

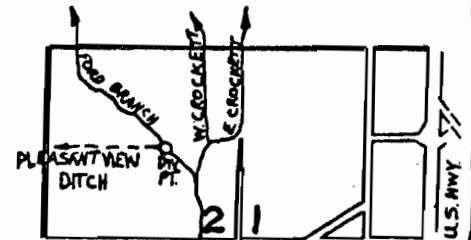

FINAL PROOF SURVEY
UNDER

Application No. 64924.. Permit No. .47624....
IN NAME OF

.....MARVIN SAMS.....

Surveyed May 8 1986, by J. Sauter.....

LITTLE... WALKER... MOC.

RECEIVED

MAP 2 of 2

SEP 03 1996

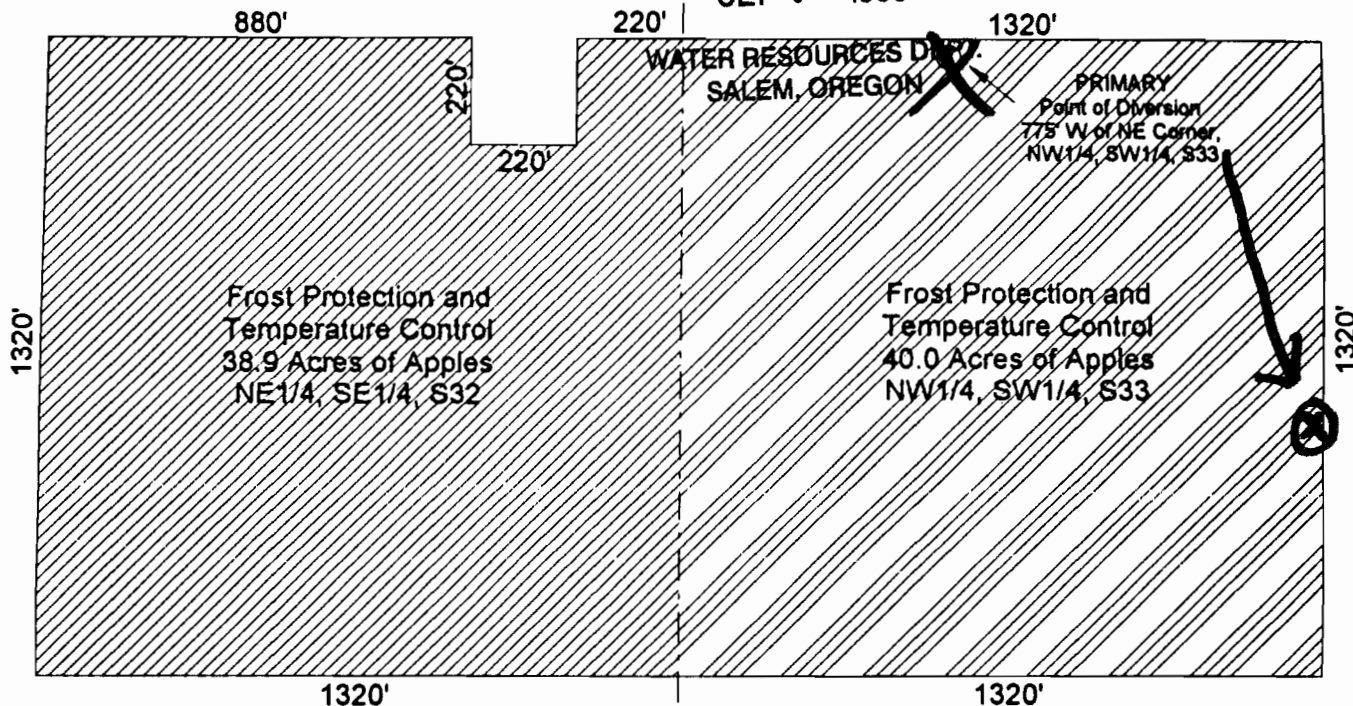

1337.3'

32 | 33

5 | 4

Application No. S 74392

Permit No. 52908

THIS MAP IS INTENDED ONLY TO IDENTIFY THE LOCATION OF A WATER RIGHT. IT DOES NOT PROVIDE INFORMATION IN REGARD TO PROPERTY OWNERSHIP BOUNDARIES.



SCALE

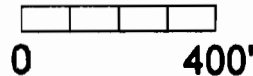

Water Right Application Map

McKibben Family Limited Partnership
 Application No: _____
 Milton-Freewater Quadrangle
 T6N, R35E, WM
 July 21, 1994

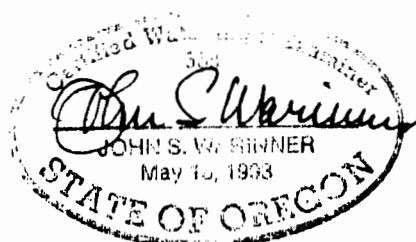

17114 SW Tualatin Street
 Lake Oswego, Oregon 97035



FOUNTAIN HEAD