

Application No. 72733

Permit No. 52963

T.1&2S.R.2E.W.M.

Application No.

Permit No.

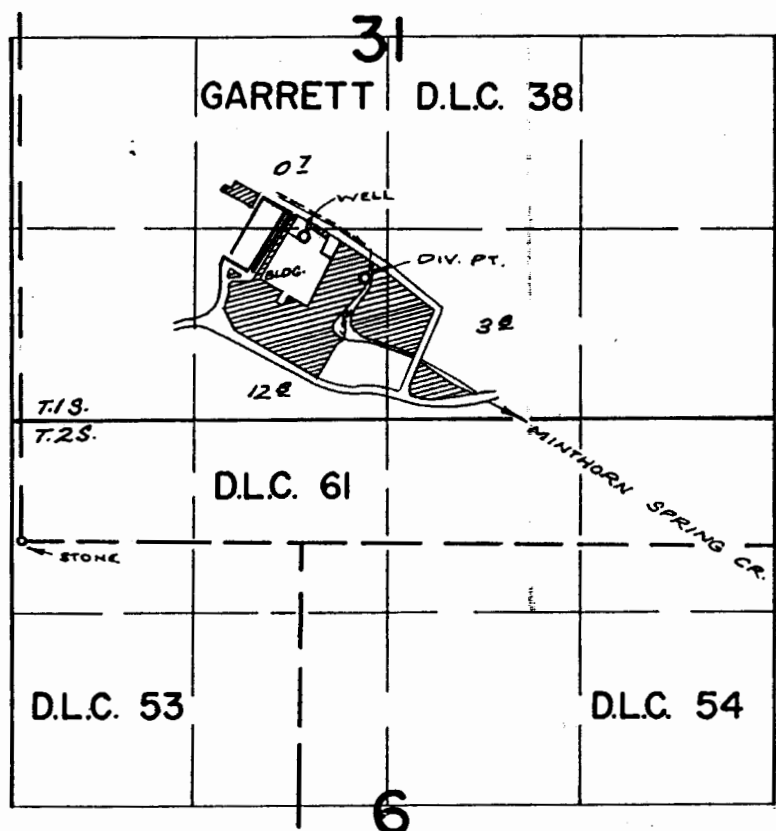

WELL LOC: 1900' E. & 2090' N. FROM S.W. COR. GARRETT D.L.C. 61  
 DIV. PT. LOC: 2340' E. & 1800' N. "

**FINAL PROOF SURVEY**  
 UNDER

TRANSFER No. 0-54  
 Application No. G-3235 Permit No. G-3041  
G-4517 Permit No. G-4276  
 IN NAME OF

OMARK PROPERTIES, INC.

Surveyed Nov. 6 1970, by L. E. GAULD.