

RECEIVED

JAN 16 1987

WATER RESOURCES DEPT.  
SALEM, OREGON

# APPLICATION MAP

IN THE NAME OF CAPE BLANCO PROPERTIES, INC.

SECTION 20, T31S, R15W, W.M.

1 INCH = 1320 FEET

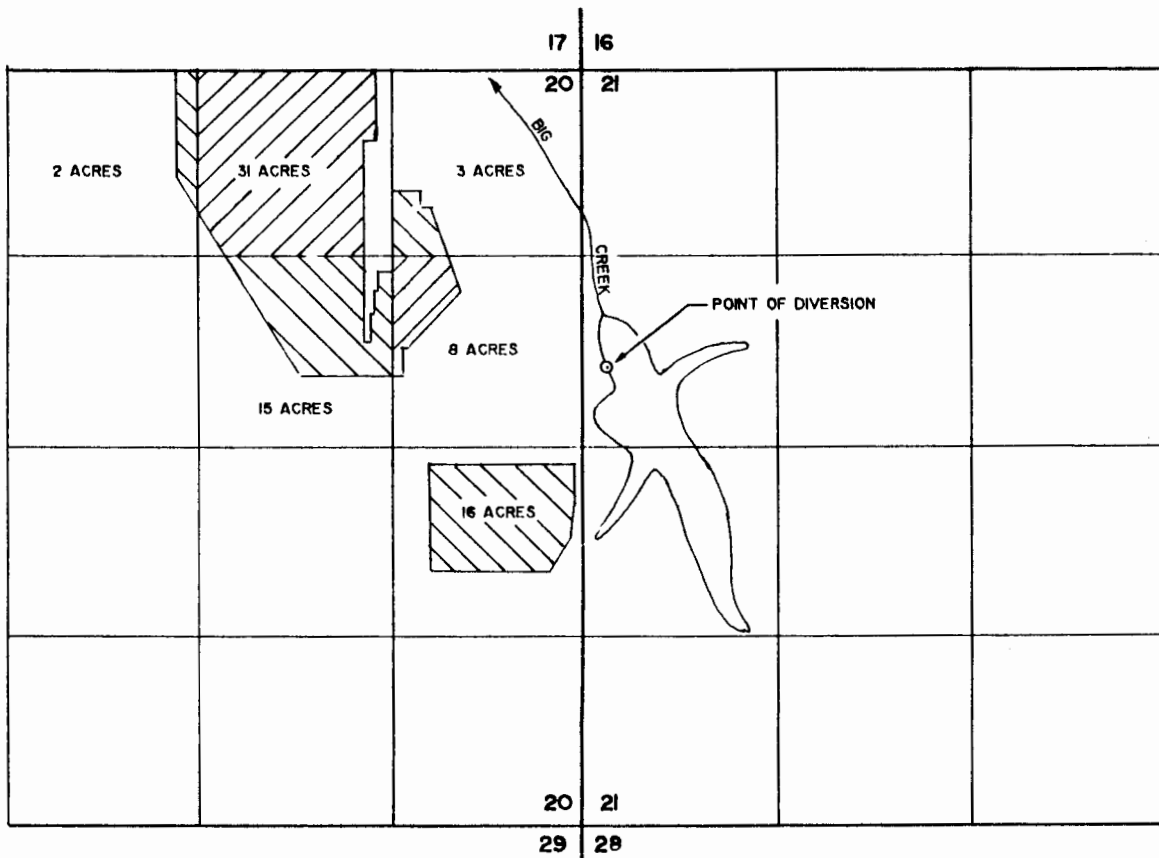

THE POINT OF DIVERSION IS TO BE LOCATED 2080 FEET SOUTH AND 180 FEET EAST FROM THE NORTHWEST CORNER OF SECTION 21, BEING WITHIN THE SW 1/4 OF THE NW 1/4 OF SECTION 21, TOWNSHIP 31 SOUTH, RANGE 15 WEST, W.M.

THE PURPOSE OF THIS MAP IS TO IDENTIFY THE LOCATION OF THE WATER RIGHT. IT IS NOT INTENDED TO PROVIDE INFORMATION RELATIVE TO THE LOCATION OF PROPERTY OWNERSHIP BOUNDARY LINES.

App'l No. 70170  
Permit No. 52989

Certified Water Right Examiner  
#054 WRE  
*James F. Gosson*  
James F. Gosson  
Nov. 19, 1987  
STATE OF OREGON