

APPLICATION MAP

IN THE NAME OF SEAVIEW BOGS, Inc.

SECTIONS 14 and 23, T 30 S, R 15 W, W.M.

Application No. 72688
Permit No. 14

RECEIVED

SEP 21 1992

WATER RESOURCES DEPT.
 SALEM, OREGON

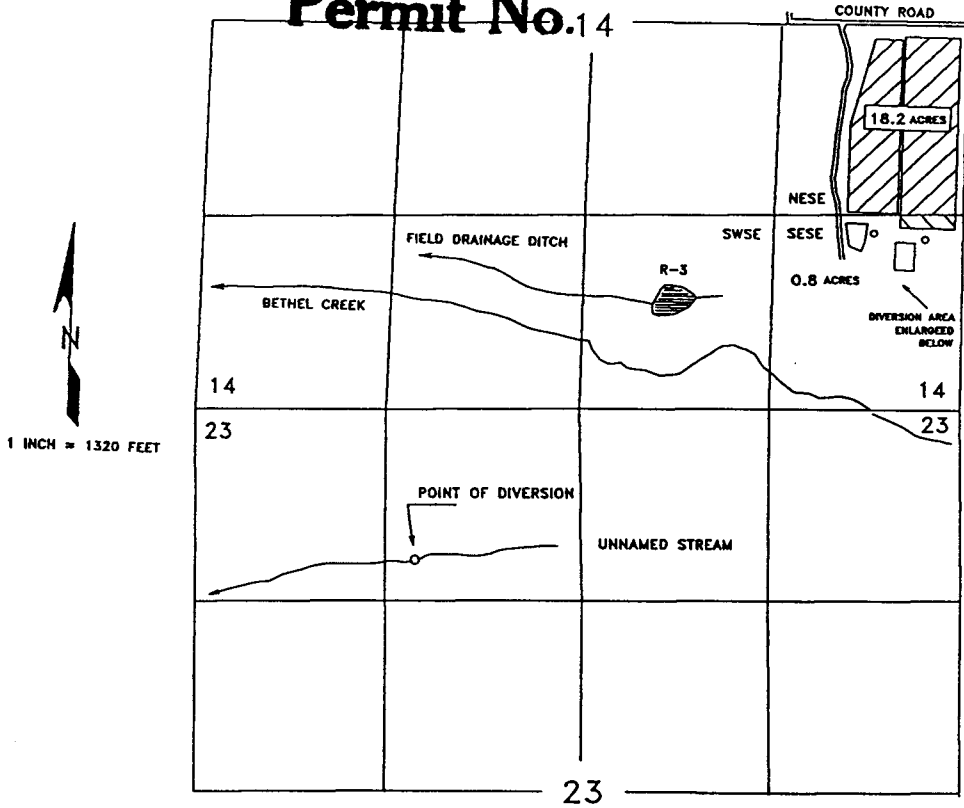

WELL AND STORAGE
 ENLARGEMENT
 SESE, SECTION 14

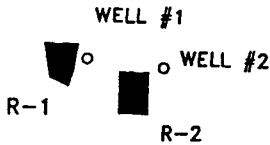

THE POINTS OF DIVERSION ARE LOCATED:

SOURCE	NORTH/SOUTH	EAST/WEST	¼ ¼	SECTION
WELL #1:	1220 NORTH	590 WEST	SE¼SE¼	14
WELL #2:	1170 NORTH	250 WEST	SE¼SE¼	14
RES. #1:			SE¼SE¼	14
RES. #2:			SE¼SE¼	14
RES. #3:	720 NORTH	2100 WEST	SW¼SE¼	14
UNNAMED CREEK:	1040 SOUTH	3750 WEST	NE¼NW¼	23

ALL FROM THE SOUTHEAST CORNER OF SECTION 14, TOWNSHIP 30 SOUTH, RANGE 15 WEST, W.M., COOS COUNTY.

THE PURPOSE OF THIS MAP IS TO IDENTIFY THE LOCATION OF THE WATER RIGHT. IT IS NOT INTENDED TO PROVIDE INFORMATION RELATIVE TO THE LOCATION OF PROPERTY OWNERSHIP BOUNDARY LINES.

