

T 7 S, R 4 W, WM

JUL 20 1995

POLK COUNTY

WATER RESOURCES DEPT.  
SALEM, OREGON

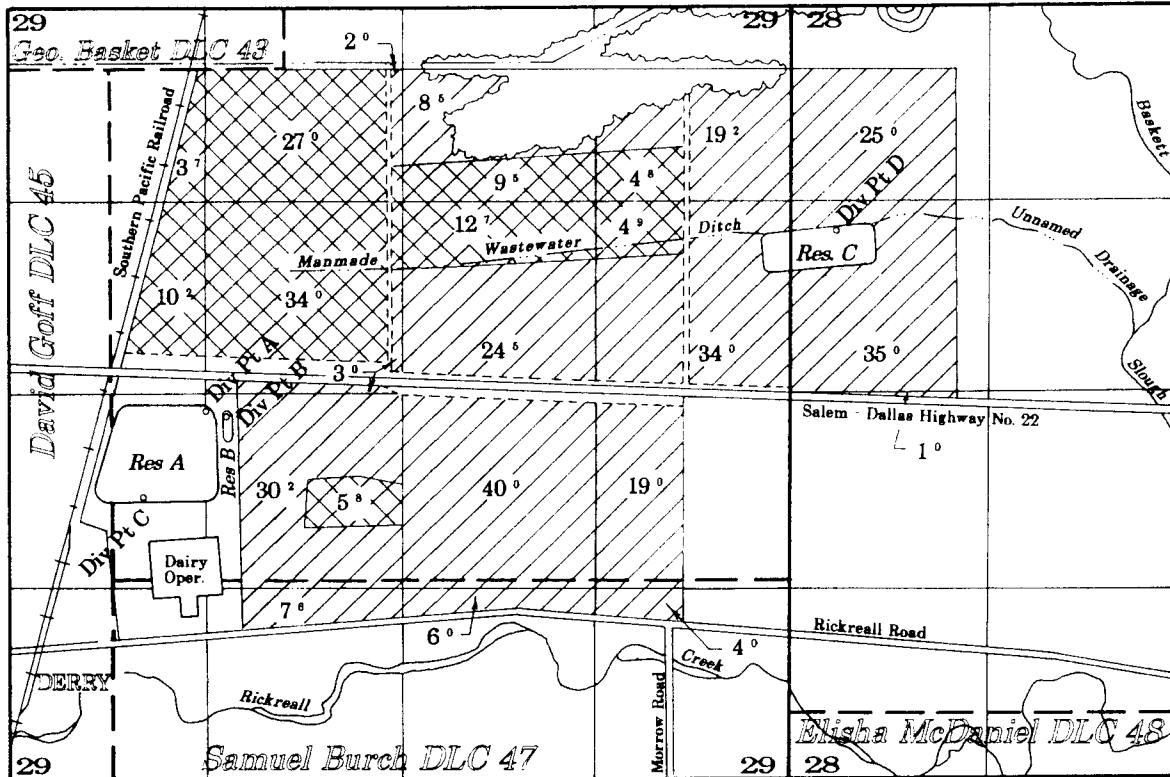

Div Pt A - 1150' North and 625' East from the northwest corner of the Samuel Burch DLC No. 47  
Div Pt B - 1125' North and 775' East from the northwest corner of the Samuel Burch DLC No. 47  
Div Pt C - 550' North and 200' East from the northwest corner of the Samuel Burch DLC No. 47  
Div Pt D - 2400' North and 300' East from the northeast corner of the Samuel Burch DLC No. 47

**SUPPLEMENTAL**



APPLICATION NO.  
T-2529 Irrig.  
19183 Irrig.  
48265 Irrig.

Application S-80537 Permit 50000

58134

69936 Dairy Oper.

**PRIMARY**

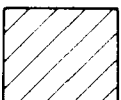

**RICKREALL DAIRY, L.L.C.**

Scale: 1" = 1320'

Date: May 12, 1995

**Application to Appropriate Surface Water**

NOTE: This map is for the purpose of identifying the location of water rights and has no intent to dimension or locate property ownership lines.

