

S 53098  
 4A  
 Taylor Cr  
 Rogue R  
 3/06/1991

Permit:  
 Vol:  
 Strm:  
 Trib:  
 Priority:

WATER RIGHT APPLICATION MAP  
 SURFACE WATER

Permit No. 53098

SECTIONS 5, 7 & 8  
 JOSEPHINE COUNTY

53098 1" = 400'

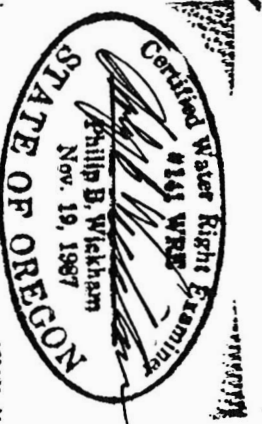
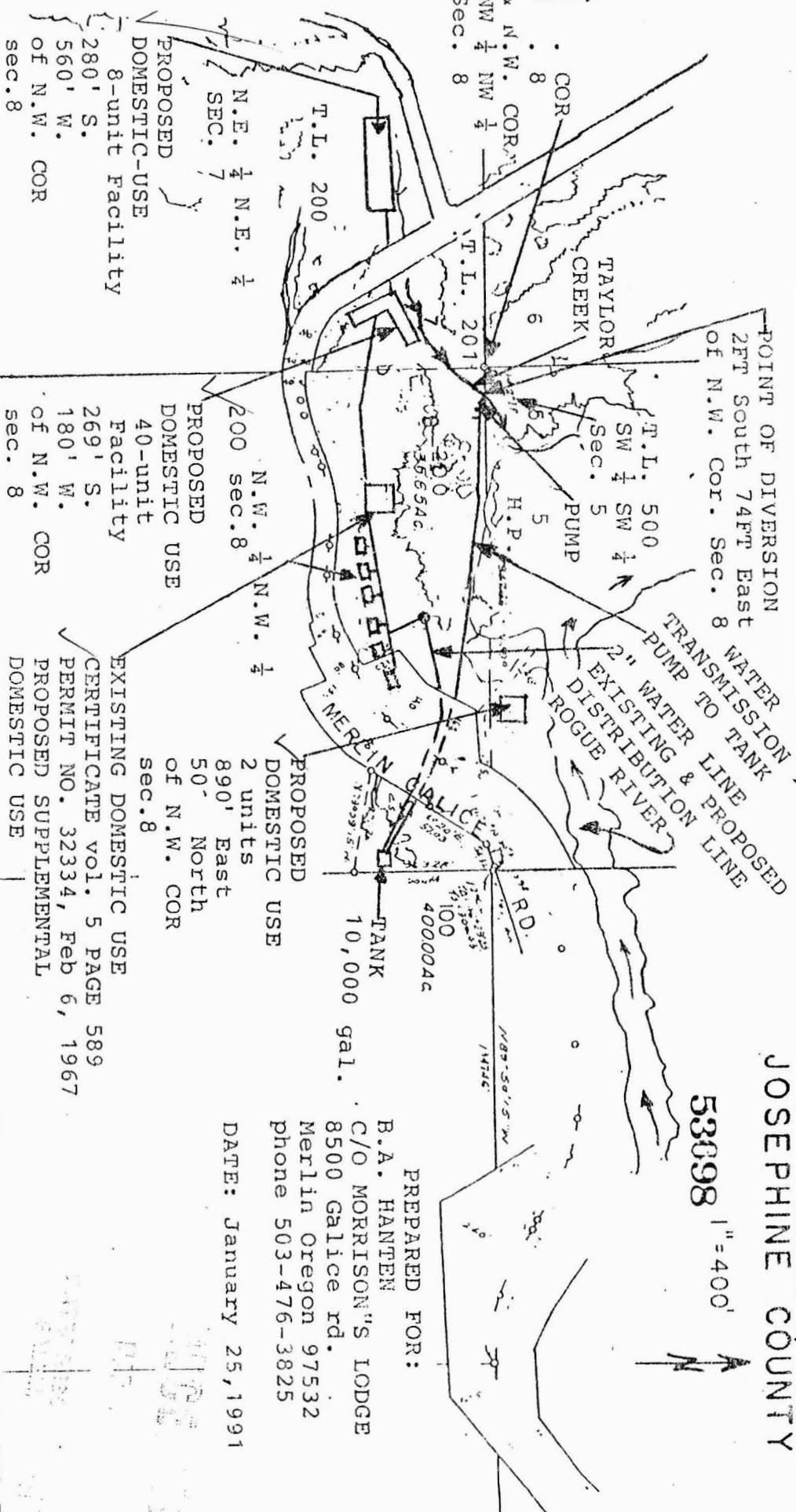

NOTE: TAX LOTS (T.L.) 200, 201 sec 7  
 & T.L. 200 sec. 8, & T.L. 500  
 sec. 5 are listed in the  
 Assessors office in the  
 name of Hanten, et. al...

HOWEVER, the purpose of this map  
 is to identify the location of the  
 water-right and is not intended  
 to guarantee unincumbered  
 ownership or to provide  
 dimensions or location of property

PREPARED FOR:  
 B.A. HANTEN  
 C/O MORRISON'S LODGE  
 8500 Gallice rd.  
 Merlin Oregon 97532  
 phone 503-476-3825

DATE: January 25, 1991

PROPOSED  
 DOMESTIC-USE  
 8-unit Facility  
 280' S.  
 560' W.  
 of N.W. COR  
 sec. 8

PROPOSED  
 DOMESTIC USE  
 40-unit  
 Facility  
 269' S.  
 180' W.  
 of N.W. COR  
 sec. 8

EXISTING DOMESTIC USE  
 CERTIFICATE vol. 5 PAGE 589  
 PERMIT NO. 32334, Feb 6, 1967  
 PROPOSED SUPPLEMENTAL  
 DOMESTIC USE

PROPOSED  
 DOMESTIC USE  
 2 units  
 890' East  
 50' North  
 of N.W. COR  
 sec. 8

NOTE: Water Transmission  
 Line is schedule "C" PVC  
 from the pump towards  
 tank, 1 1/2" diam. the first  
 900 feet, then 2 1/2" diam.  
 800 feet to the tank.