

T 2 S, & T 3 S, R 4 W, WM

YAMHILL COUNTY

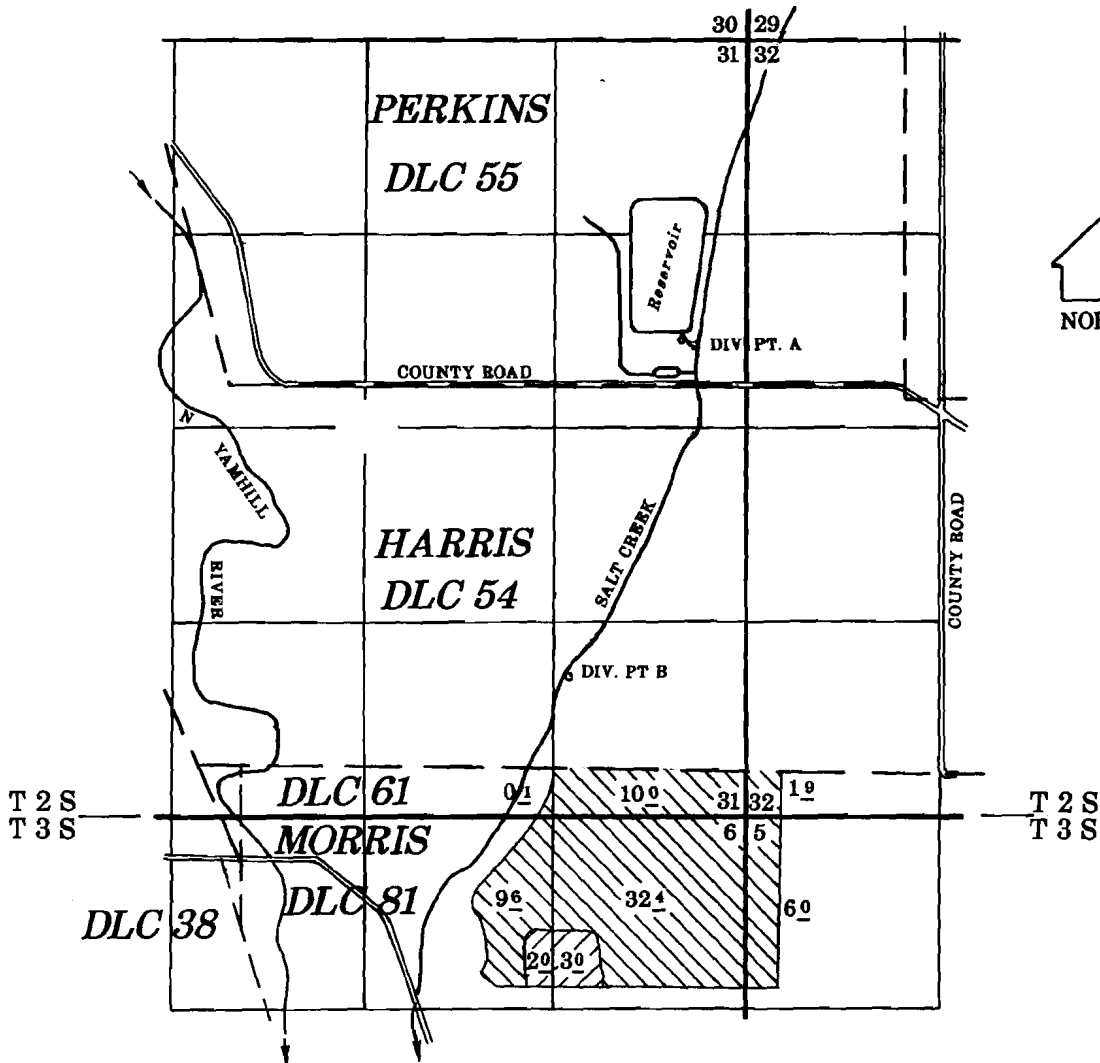

DIV. PT. A: 250' North and 1500' West of the SE corner of the Perkins DLC No. 55
 DIV. PT. B: 1960' South and 2260' West of the SE corner of the Perkins DLC No. 55

R-45351
 S-70214
 53359

R-5378
 S-52413
 39587

Application No. _____ Permit No. _____

IN NAME OF
BAILEY NURSERIES INC.

JULY 11, 1996
 Scale 1" = 1320'

RECEIVED

JUL 23 1996

WATER RESOURCES DEPT.
 SALEM, OREGON

Application to Appropriate Surface Water
Application No. 5-81298
Permit No. 53123

NOTE: This map is for the purpose of identifying the location of water rights and has no intent to dimension or locate property ownership lines.

