

SE 1/4 NW 1/4

ALL 1/4

LEGAL DESCRIPTION:

Application No. 5-81083
Permit No. 5315

TWP 38 S R14 E SEC. 20

SW 1/4 NW 1/4 = 1.76 AC
NE 1/4 SW 1/4 = 2.77 AC
SE 1/4 SW 1/4 = 25.75 AC
NW 1/4 SE 1/4 = 1.23 AC
SW 1/4 SE 1/4 = 8.00 AC



FEB 28 1996

WATER RESOURCES DEPT.
SALEM, OREGON

SCALE:
1" = 300'-0"
2-23-1996

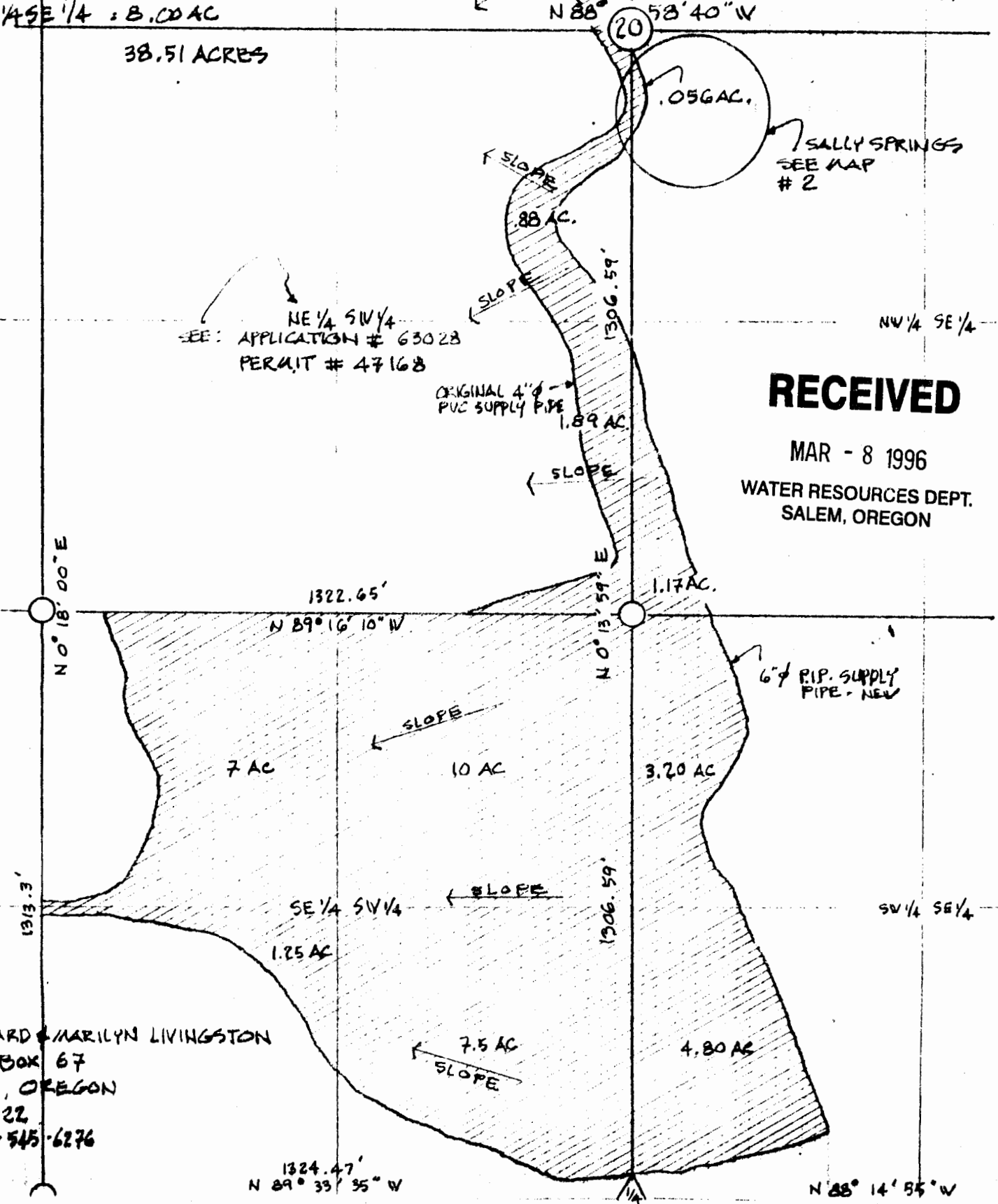

RECEIVED

MAR - 8 1996
WATER RESOURCES DEPT.
SALEM, OREGON

NE 1/4 SW 1/4
SEE: APPLICATION # 63028
PERMIT # 47168

EDWARD & MARILYN LIVINGSTON
P.O. BOX 67
DLY, OREGON
97622
541-545-6276

1324.47'
N 89° 33' 35" W

N 88° 14' 55" W

RECEIVED

FEB 28 1996

WATER RESOURCES DEPT.
SALEM, OREGON

RECEIVED

MAR - 8 1996

WATER RESOURCES DEPT.
SALEM, OREGON

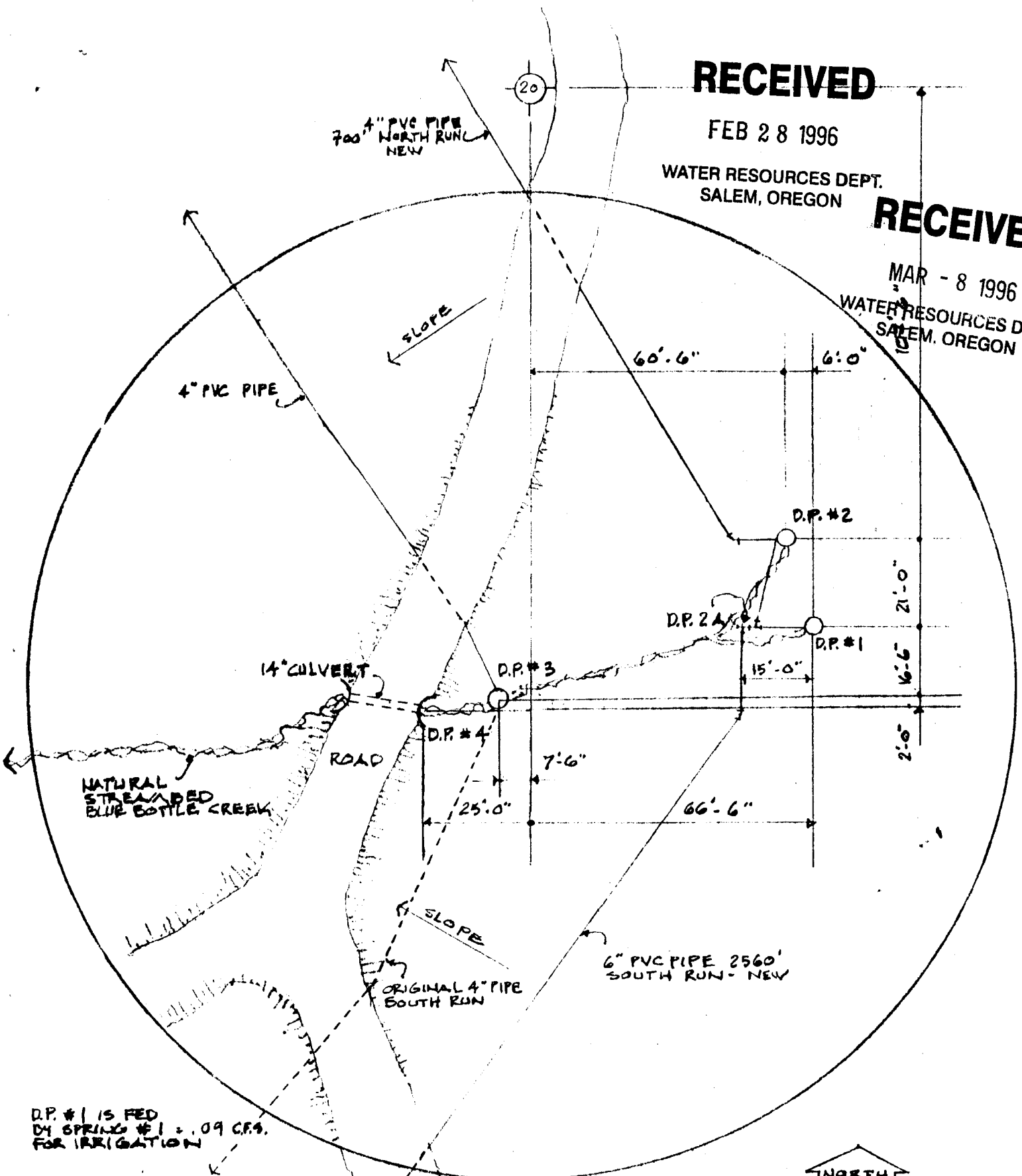

D.P. #1 IS FED
BY SPRING #1 = .09 C.F.S.
FOR IRRIGATION

D.P. #2 IS FED
BY SPRING #2 = .07 C.F.S.
FOR IRRIGATION

.160 C.F.S.

EDWARD & MARILYN LIVINGSTON
R.O. BOX 67
ELY, OREGON
97622
541.545.6276

Application No. 5-81003
Permit No. 53158

SALLY SPRINGS #1 & #2
SCALE: 1" = 30'-0"
MAP #2 OF 2
2.23.1996

