

Application No. 81613

Permit No. 53210

SURFACE WATER APPLICATION MAP

IN THE NAME OF: ROSS ISLAND SAND & GRAVEL CO.
(VANPORT PLANT)

SECTION 33, T.2N., R.1E., W.M.
1"=400'

POINT OF DIVERSION LOCATED IN: TAX LOT 24 OF MULTNOMAH CO. ASSESSORS MAP 332N1E
WATER USE IN: TAX LOT 24 OF MULTNOMAH CO. ASSESSORS MAP 332N1E

THE PURPOSE OF THIS MAP IS TO IDENTIFY THE LOCATION OF THE
WATER RIGHT. IT IS NOT INTENDED TO PROVIDE INFORMATION RELATIVE
TO THE LOCATION OF PROPERTY OWNERSHIP BOUNDARY LINES.

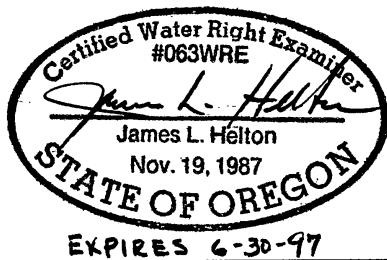
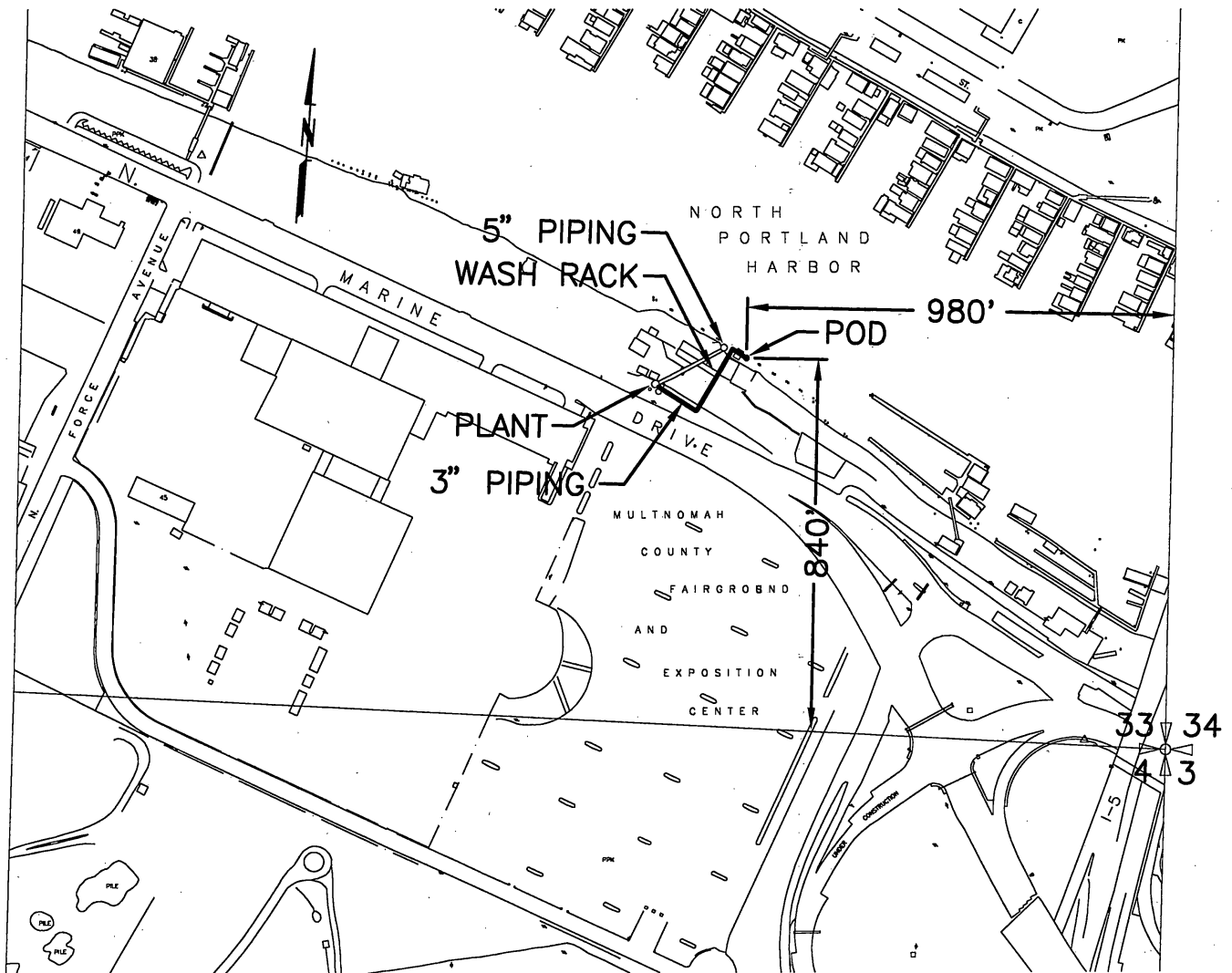

RECEIVED

OCT 18 1996

WATER RESOURCES DEPT.
SALEM, OREGON



Murray, Smith & Associates, Inc.
Engineers/Planners

121 S.W. Salmon, Suite 1020 PHONE 225-9010
Portland, Oregon 97204 PAX 225-9022