

Application No. 81614
Permit No. 53241

SURFACE WATER APPLICATION MAP

IN THE NAME OF: ROSS ISLAND SAND & GRAVEL CO.
(TAIT PLANT)

SECTION 10, T.1S., R.1E., W.M.
1"=400'

POINT OF DIVERSION LOCATED IN: TAX LOT 3 OF MULTNOMAH CO. ASSESSORS MAP 3331
WATER USE IN: TAX LOT 3 OF MULTNOMAH CO. ASSESSORS MAP 3331

THE PURPOSE OF THIS MAP IS TO IDENTIFY THE LOCATION OF THE
WATER RIGHT. IT IS NOT INTENDED TO PROVIDE INFORMATION RELATIVE
TO THE LOCATION OF PROPERTY OWNERSHIP BOUNDARY LINES.

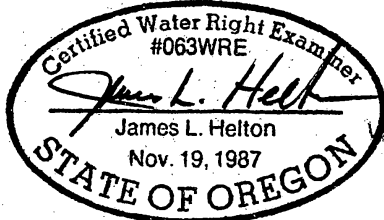
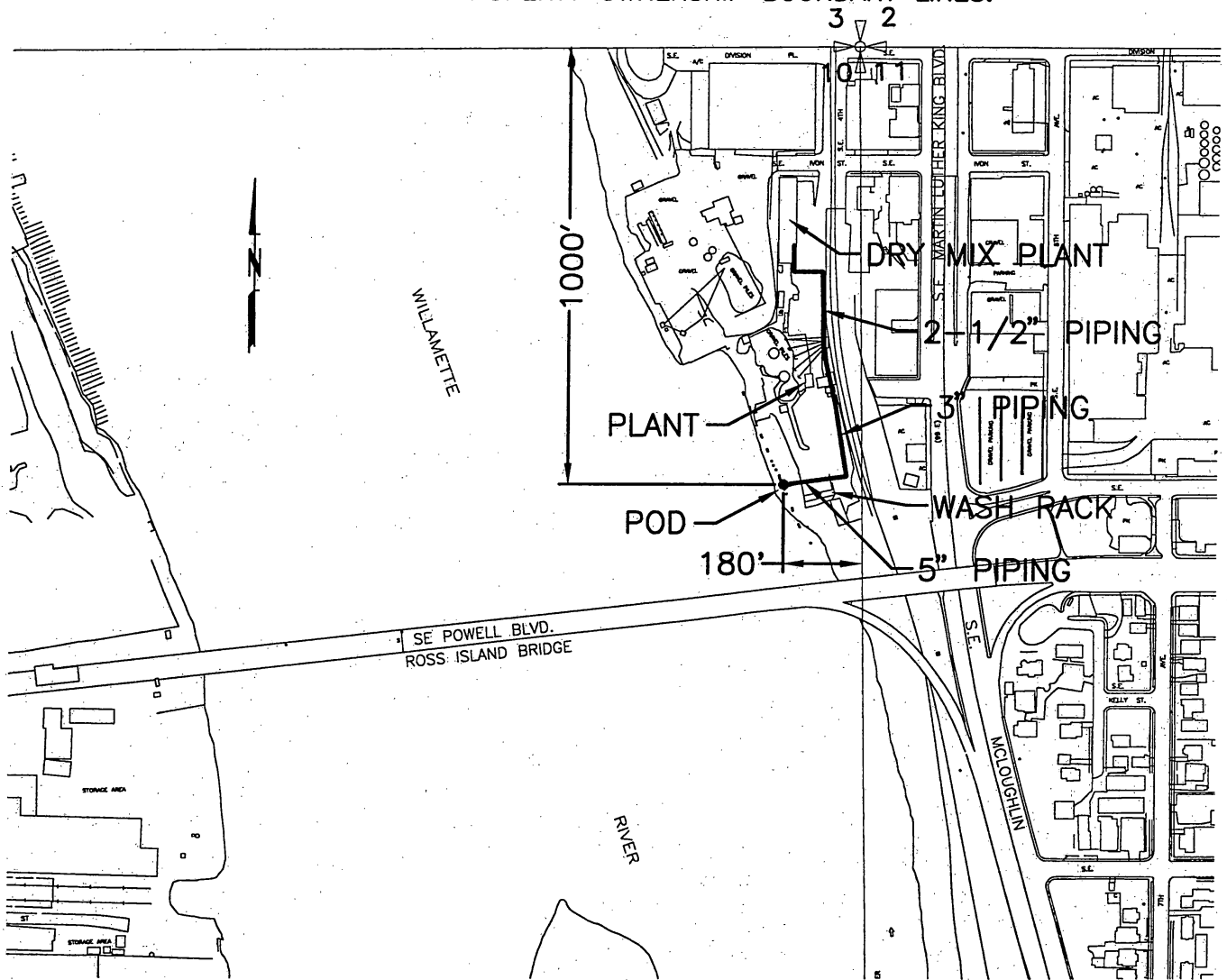

EXPIRES 6-30-97

RECEIVED

OCT 18 1996

WATER RESOURCES DEPT.
SALEM, OREGON



Murray, Smith & Associates, Inc.
Engineers/Planners

121 S.W. Salmon, Suite 1020 PHONE 225-9010
Portland, Oregon 97204 FAX 225-9022