

Application No. S-81615

53242

SURFACE WATER APPLICATION MAP

IN THE NAME OF: ROSS ISLAND SAND & GRAVEL CO.
(ALBINA PLANT)

SECTION 27, T.1N., R.1E., W.M.
1" = 400'

POINT OF DIVERSION LOCATED IN: TAX LOT 2 OF MULTNOMAH CO. ASSESSORS MAP 2829
WATER USE IN: TAX LOT 2 OF MULTNOMAH CO. ASSESSORS MAP 2829

THE PURPOSE OF THIS MAP IS TO IDENTIFY THE LOCATION OF THE WATER RIGHT. IT IS NOT INTENDED TO PROVIDE INFORMATION RELATIVE TO THE LOCATION OF PROPERTY OWNERSHIP BOUNDARY LINES.

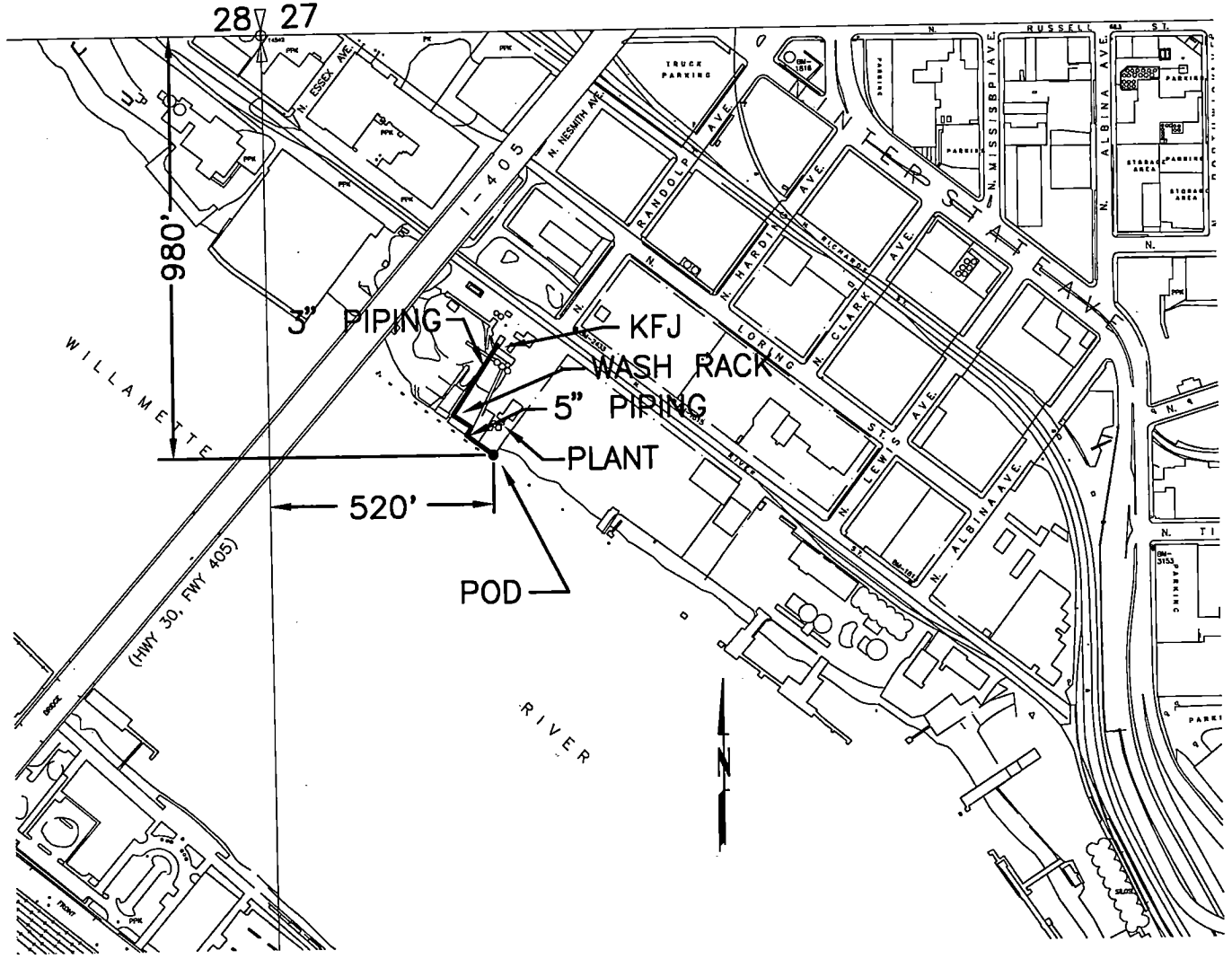

Certified Water Right Examiner
#063WRE
James L. Helton
James L. Helton
Nov. 19, 1987
STATE OF OREGON
EXPIRES 6-30-97

RECEIVED
OCT 18 1996
WATER RESOURCES DEPT.
SALEM, OREGON

MSA Murray, Smith & Associates, Inc.
Engineers/Planners
121 S.W. Salmon, Suite 1020 PHONE 225-9010
Portland, Oregon 97204 FAX 225-9022