

Application No. 71758  
 Permit No. 53345

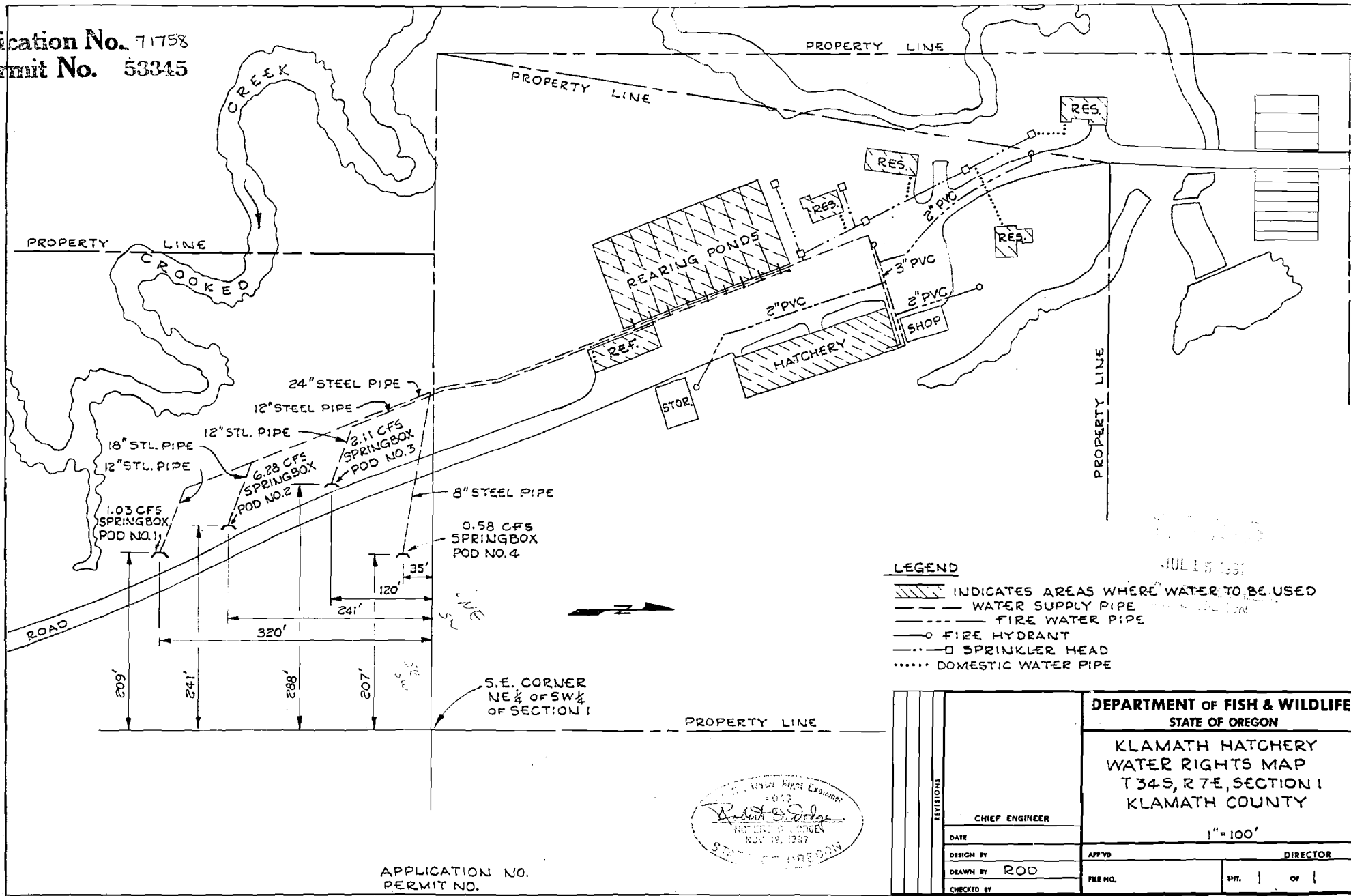

**LEGEND**

- INDICATES AREAS WHERE WATER TO BE USED
- WATER SUPPLY PIPE
- FIRE WATER PIPE
- FIRE HYDRANT
- SPRINKLER HEAD
- DOMESTIC WATER PIPE

JUL 15 1987

DEPARTMENT OF FISH & WILDLIFE  
 STATE OF OREGON

KLAMATH HATCHERY  
 WATER RIGHTS MAP  
 T34S, R7E, SECTION 1  
 KLAMATH COUNTY

1" = 100'

REVISIONS	CHIEF ENGINEER	APPROVED		DIRECTOR
	DATE	FILE NO.	SHEET 1 OF 1	
	DESIGN BY			
	DRAWN BY	ROD		
CHECKED BY				

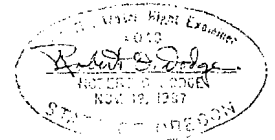

APPLICATION NO.  
 PERMIT NO.