

Sec 13. Tp. 4 South. Range 39 E. N. M.

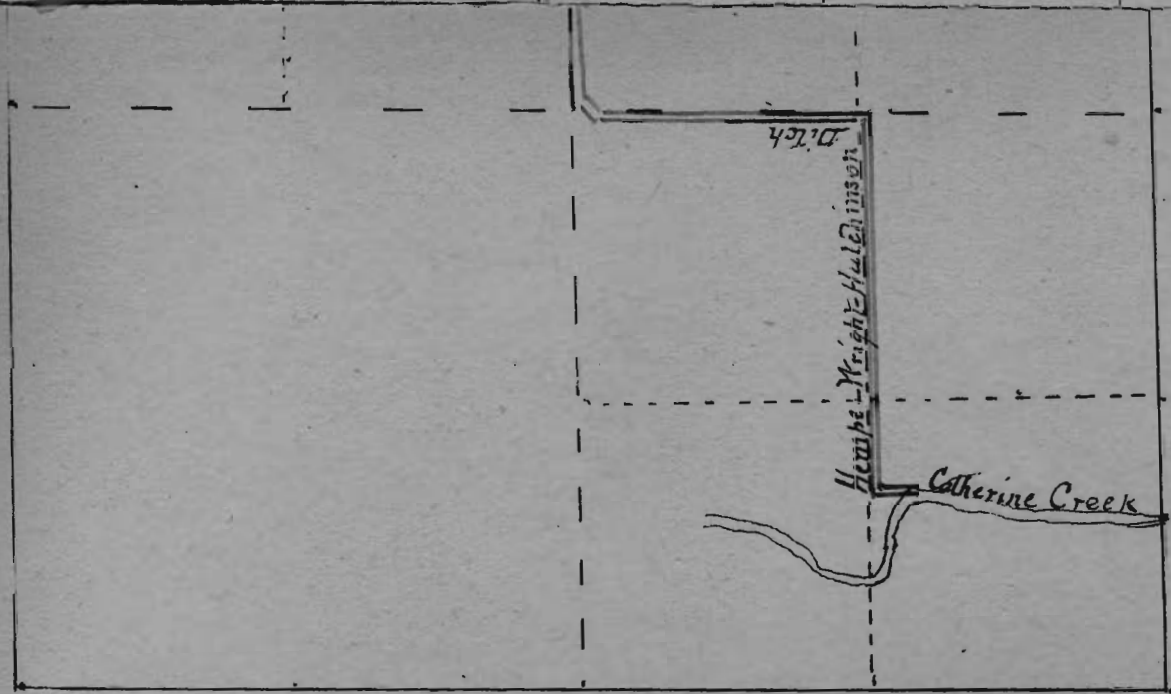
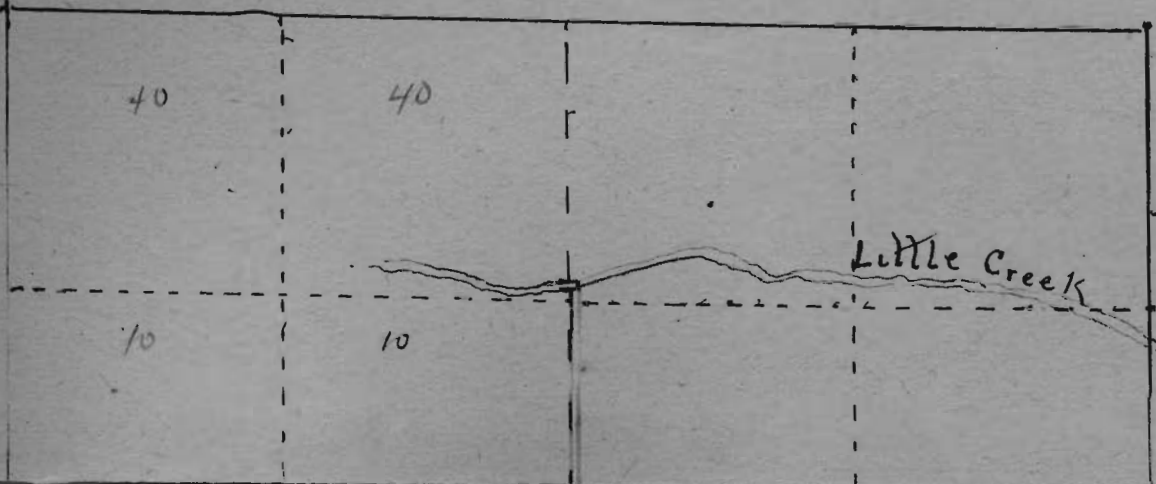

Application No. 8021 Permit No. 5337

State of Oregon }  
County of Union } 33

I, B. F. Wilson, of Union, Oregon, do hereby

certify that this map was made from notes and observations taken & made by me, and from my personal knowledge of the location of section corners and lines in said Section 13, and that it correctly represents the works described in the accompanying application, together with the location of streams and other ditches in the immediate vicinity.

Dated at Union, Ore. July 27 1921  
B. F. Wilson