

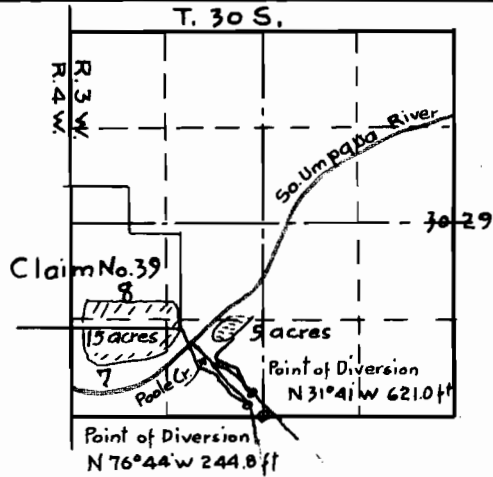

Scale 2" = 1 mile



V. N. Poole Irrigation System.

In Sec. 30 T. 30 S. R. 3 W. W. M.

Douglas County Oregon

OFFICE OF

F. C. FREAR

County Surveyor and Roadmaster

December 1921.

CERTIFICATE OF SURVEYOR

I, G. G. Stewart, of Roseburg, Ore, do hereby certify that this map was made from notes taken during an actual survey made by me Dec. 15 1921, and that it correctly represents the works described in the accompanying application together with the location of streams in the immediate vicinity.

G. G. Stewart

Deputy County Surveyor.

8245

534