

NW 1/4 OF SW 1/4 OF SECTION 9
 SW 1/4 OF SW 1/4 OF SECTION 9
 S 1/2 OF SW 1/4 OF NW 1/4 OF SECTION 17
 T4S, R3E of the WM
 CLACKAMAS COUNTY, OREGON

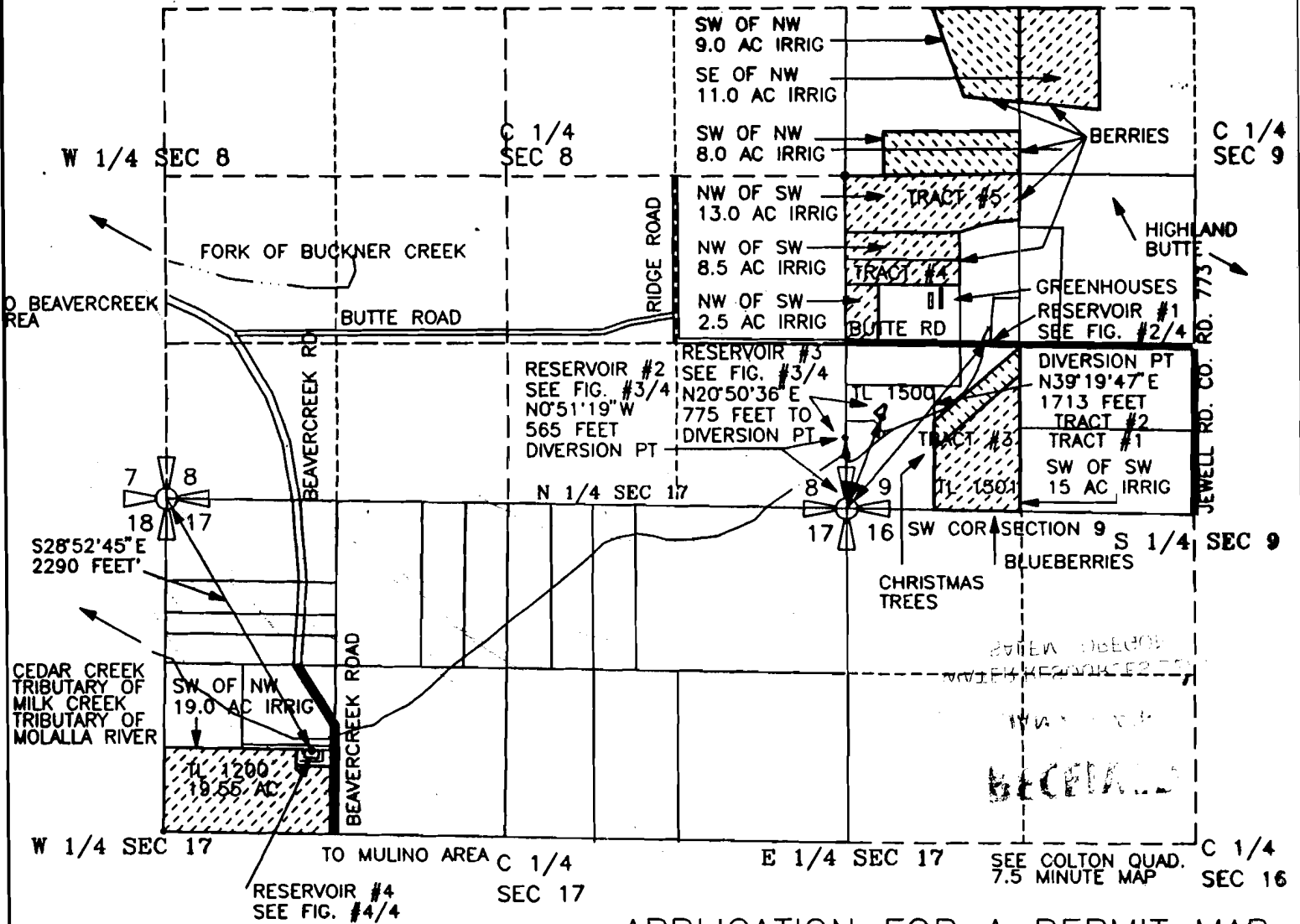

APPLICATION FOR A PERMIT MAP
 TO APPROPRIATE SURFACE WATER

PREPARED BY EDWARD A. CRANE, CWRE

DIVERSION POINT #4 IS 2007' SOUTH AND 1107' EAST
 OF THE NORTHWEST CORNER OF SECTION 17, TOWNSHIP
 4 SOUTH, RANGE 3 EAST OF WM., CLACKAMAS
 COUNTY, STATE OF OREGON

PREPARATION OF THIS MAP WAS FOR THE PURPOSE
 OF IDENTIFYING THE LOCATION OF THE WATER RIGHTS
 ONLY AND HAS NO INTENT TO PROVIDE DIMENSIONS
 OR LOCATION OF PROPERTY OWNERSHIP LINES.

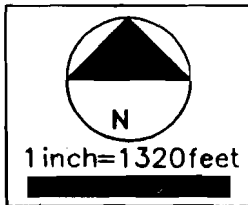
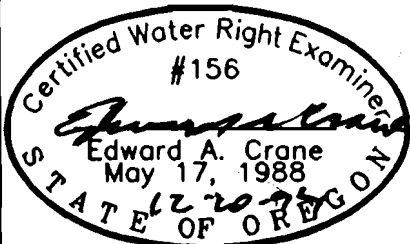

Received 12-30-94
 SURVEYED DECEMBER 13, 1994
 BY EDWARD A. CRANE, CWRE

EDWARD A. CRANE, HOFFMAN2.DWG

DATE
 DEC 1994

PROJECT NO.
 146 001

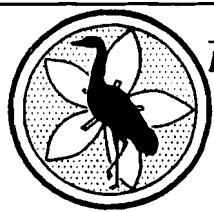

CRANE & MERSETH
 Engineering/Surveying

SUITE 604
 12042 SE SUNNYSIDE ROAD
 CLACKAMAS, OREGON 97015

BUS: (503) 698-7575
 FAX: (503) 698-7747

APPLICATION FOR PERMIT NUMBER 72352

PERMIT NUMBER _____ IN THE NAME OF:

ROBERT J. HOFFMAN dba
 HOFFMAN TREES

FIGURE
 1/4